

Registration No. GR - 2018

Certificate No. GR 1916

Registration Statement

OF CLAIMANT OF RIGHT TO APPROPRIATE GROUND WATER

TO THE STATE ENGINEER OF OREGON:

I, Alex Duff
of Madison Creekwater County of Wasco
(Mailing address)

State of Oregon, do hereby make application for a certificate of registration as evidence of a right to appropriate ground water.

1. Source from which water is withdrawn is Pump Well
(Flowing well, pump well, infiltration trench, or tunnel)

2. Location is: 1 1/2 miles west of M. Creekwater
(Approximate distance and direction from nearest city or town)

and is more particularly described as follows: Well in S.E. corner of 12 acres describe as follows
(a) 160ft. E + 1350' N. S. W. cor.
verts. Pleasant View. E 2 acres of lot 2
(Give distance and bearing to corner of section or other legal subdivision)

being within all of lot 3 of Sec. 34, Twp. 6 N, Rge. 35
(Smallest legal subdivision) (N. or S.) (E. or W.)

or (b) within limits of recorded platted property, town or city:

in Lot _____, Block _____ of _____
(Name of plat or addition)

(If within city or town, give name) County of _____

3. Construction Work was begun on Aug 1914 - 90 feet was completed on Drilled additional 700 feet 1927
(Date) (Date)

and the ground water claimed was first used for the purposes set out below on 1914
(Date)

since which time the water has been used Continuously
(Continuously or intermittently)

from 1914 to 1957
(Date) (Date)

4. Quantity of water claimed and used is 200 gallons per minute; _____ acre feet per year.

5. Purpose or Purposes for which water is used Irrigation

(Domestic, irrigation, municipal, manufacturing, industrial, etc.)

6. Description of Well: Depth 440 feet. Type Dug 40ft Drilled 400
(Dug or drilled)

diameter 6 1/8 inches. Elevation of ground at well site 1800+ feet, mean sea level.
(As near as known)

Depth to water table 30 feet.

7. Capacity of Well: 200 g.p.m. with _____ feet drawdown.

100 g.p.m. with _____ feet drawdown. till July 15th
from July 15th on.

Date of test _____

If Flowing Well: Measured discharge _____ g.p.m. on _____ (Date)

Shut-in pressure at ground surface _____ lbs. per sq. in. on _____ (Date)

Water is controlled by _____ (Cap. valve, etc.)

Township 6 N Range 35 E, W.M.
North

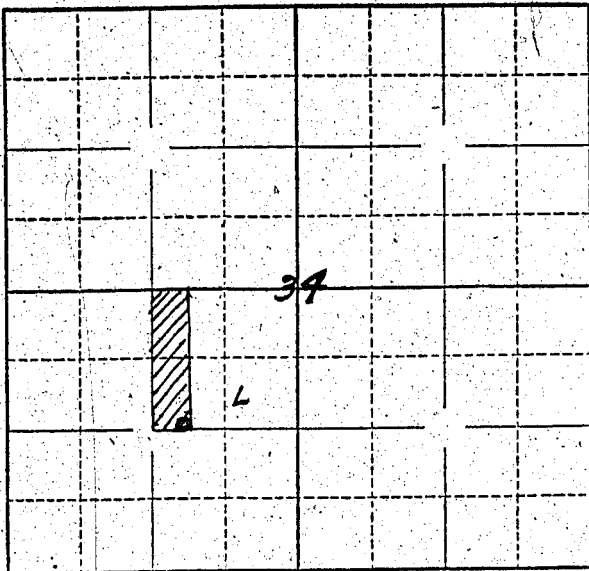

Locate well and acreage of irrigated land on plat.
Scale 4 - 1 Mile

STATE OF OREGON

County of Marion } ss.

I, Alex. DeL... being first duly sworn, do hereby certify that I have read the foregoing Registration Statement and that all of the items therein contained are true to the best of my knowledge and belief.

(Signature of Registrant)

Subscribed and sworn to before me this 12 day of March, 19 59.

My commission expires 5-2-60 (Notary Public)

(SEAL)

CERTIFICATE OF REGISTRATION

STATE OF OREGON

County of Marion } ss.

This is to certify that the foregoing Registration Statement was received in the office of the State Engineer on the 10th day of July, 1958, at 8:00 o'clock A.M. and has been duly recorded in said office in Book No. 9 of Registration Statements on page GR-1916

Witness my hand this 9th day of February, 19 59

(State Engineer)

By Lawrence A. Stanley (Deputy)

GR-1916

\$1500