

Registration Statement

OF CLAIMANT OF RIGHT TO APPROPRIATE GROUND WATER

(Under Chapter 708, Oregon Laws 1955.)

TO THE STATE ENGINEER OF OREGON:

I, Chester F. and Hazel M. Royer

of Rt. 2, Box 351, Albany County of Linn

State of _____, do hereby make application for a certificate of registration as evidence of a right to appropriate ground water.

1. Source from which water is withdrawn is pump well No. 1
(Flowing well, pump well, infiltration trench, or tunnel)

2. Location is: 6 miles NW of Jefferson, Oregon
(Approximate distance and direction from nearest city or town)

and is more particularly described as follows:

(a) N. 10° E. 43.75 chains from the NW corner of the Samuel T. Jones DLG No. 73,
(Give distance and bearing to corner of section or other legal subdivision) T. 10 S. R. 3 W.
being within NE $\frac{1}{4}$ of NE $\frac{1}{4}$ of Sec. 6, Twp. 10 S., Rge. 3 W.
(Smallest legal subdivision) (N. or S.) (E. or W.)

or (b) within limits of recorded platted property, town or city: _____

in Lot _____, Block _____ of _____
(Name of plat or addition)
County of Linn
(If within city or town, give name)

3. Construction Work was begun on 1917; was completed on 1917
(Date) (Date)

and the ground water claimed was first used for the purposes set out below on 1917
(Date)

since which time the water has been used continuously
(Continuously or intermittently)

from 1917 to present time
(Date) (Date)

4. Quantity of water claimed and used is 240 gallons per minute, 26 acre feet per year.

5. Purpose or Purposes for which water is used Irrigation
(Domestic, irrigation, municipal, manufacturing, industrial, etc.)

6. Description of Well: Depth 22 feet. Type drilled
(Dug or drilled)
diameter 10 inches. Elevation of ground at well site 185 feet, mean sea level.
(As near as known)
Depth to water table 10 feet.

7. Capacity of Well: 100 g.p.m. with 15 feet drawdown.
_____ g.p.m. with _____ feet drawdown.

Date of test Not tested

If Flowing Well: Measured discharge _____ g.p.m. on _____
(Date)

Shut-in pressure at ground surface _____ lbs. per sq. in. on _____
(Date)

Water is controlled by _____
(Cap, valve, etc.)

8. Casing: (Give diameter, commercial specifications and depth below ground surface of each casing size.)

10 inch diameter steel casing from 0 to 22 feet
inch diameter from to feet
inch diameter from to feet
inch diameter from to feet

Describe and show depth of shoe, plug, adapter, liner or other details:

9. Perforated Casings or Screens:

Slit perforations from 17 to 22
(Number per foot and size of perforations, or describe screen)

from to
from to
from to

10. Log of Well: (Describe each stratum or formation clearly. Indicate if water bearing, and give thickness and depth as indicated.)

MATERIAL	Thickness (Feet)	Depth to Bottom (Feet)
Not known		

If log of well is not available, give name and address of driller: **T. J. Burkhardt, 169 N. 1st W.,
Tremonton, Utah**

11. Infiltration Trench: Covered or open
 Dimensions: Length ft. Minimum depth ft. Maximum depth ft.
 Bottom width ft. Discharge g.p.m. Date of test

12. Tunnel: Type of lining
 Dimensions:
(Length, course, and cross sectional size)
 Position of water bearing stratum with reference to portal of tunnel

Log of tunnel: (Preceding table for log of well may be used, if desired. Give footage from portal and character of materials, as pertinent.)

13. Pumping Equipment:
 (a) Pump **Fairbanks Morse 2" centrifugal** Capacity **250** g.p.m.
(Make, type and size)
 (b) Motor **10 H.P. electric**
(Type and horsepower)

14. Location of area irrigated or to be irrigated, or place of use if for purposes other than irrigation.

Township North or South	Range E. or W. of Willamette Meridian	Section	Forty-acre Tract	Number Acres To Be Irrigated	Date of Reclamation
10 S	3 W	6	NE $\frac{1}{4}$ of NE $\frac{1}{4}$	17.3	1947

15. If the ground water supply is supplemental to an existing water supply, identification of any application for a permit, permit, certificate or adjudicated right to appropriate water made or held by the registrant.

Township 105 Range 310 W.M.
North

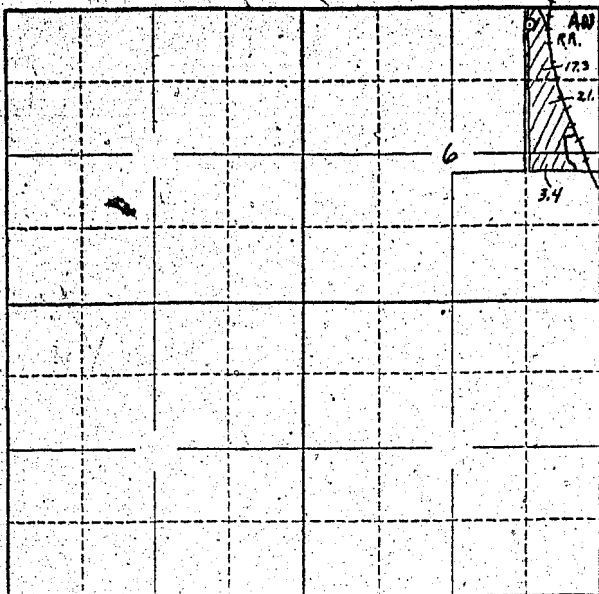

Locate well and acreage of irrigated land on plat.
Scale: 2" = 1 Mile

STATE OF OREGON

County of

} ss.

I,, being first duly sworn, do hereby certify that I have read the foregoing Registration Statement and that all of the items therein contained are true to the best of my knowledge and belief.

.....
(Signature of Registrant)

Subscribed and sworn to before me this day of, 19.....

My commission expires

.....
(Notary Public)

(SEAL)

For Certificate of Registration See Page GR-188 G
CERTIFICATE OF REGISTRATION

STATE OF OREGON

County of Marion

} ss.

~~This is to certify that the foregoing Registration Statement was received in the office of the State Engineer on the ... day of ... 19... and has been duly recorded in the office in Book No. ... of Registration Statements on page ...~~

~~Construction shall be completed by ... 19... and the water completely applied to beneficial use by ... 19...~~

Witness my hand this day of, 19.....

.....
(State Engineer)

By

.....
(Deputy)

GR-188 C

Registration Statement

OF CLAIMANT OF RIGHT TO APPROPRIATE GROUND WATER

(Under Chapter 708, Oregon Laws 1955.)

TO THE STATE ENGINEER OF OREGON:

I, Chester F. and Hazel M. Royer

of Rt. 2, Box 351, Albany County of Linn

State of Oregon, do hereby make application for a certificate of registration as evidence of a right to appropriate ground water.

1. Source from which water is withdrawn is pump well No. 2

(Flowing well, pump well, infiltration trench, or tunnel)

2. Location is: 6 miles N.W. of Jefferson, Oregon

(Approximate distance and direction from nearest city or town)

and is more particularly described as follows:

(a) N. 33° E. 14.75 chains from the NW corner of the Samuel T. Jones DLC no. 73

(Give distance and bearing to corner of section or other legal subdivision)

being within SE 1/4 of NE 1/4 of Sec. 6, Twp. 10 S, Rge. 3 W

(Smallest legal subdivision)

(N. or S.)

(E. or W.)

or (b) within limits of recorded platted property, town or city:

in Lot _____, Block _____ of _____

(Name of plat or addition)

County of Linn

(If within city or town, give name)

3. Construction Work was begun on 1944; was completed on 1944

(Date)

(Date)

and the ground water claimed was first used for the purposes set out below on 1944

(Date)

since which time the water has been used continuously

(Continuously or Intermittently)

from 1944 to present time

(Date)

(Date)

4. Quantity of water claimed and used is 312 gallons per minute; 36 acre feet per year.

5. Purpose or Purposes for which water is used Irrigation

(Domestic, irrigation, municipal, manufacturing, industrial, etc.)

6. Description of Well: Depth 20 feet. Type drilled

(Dug or drilled)

diameter 12 inches. Elevation of ground at well site 180 feet, mean sea level.

(As near as known)

Depth to water table 8 feet.

7. Capacity of Well: 400 g.p.m. with 15 feet drawdown.

_____ g.p.m. with _____ feet drawdown:

Date of test Not tested

If Flowing Well: Measured discharge _____ g.p.m. on _____

(Date)

Shut-in pressure at ground surface _____ lbs. per sq. in. on _____

(Date)

Water is controlled by _____

(Cap, valve, etc.)

8. Casing: (Give diameter, commercial specifications and depth below ground surface of each casing size.)

12 inch diameter steel casing from 0 to 20 feet
inch diameter : from to feet
inch diameter from to feet
inch diameter from to feet

Describe and show depth of shoe, plug, adapter, liner or other details:

9. Perforated Casings or Screens:

Slit perforations from 15 to 20
(Number per foot and size of perforations, or describe screen)
..... from to
..... from to
..... from to

10. Log of Well: (Describe each stratum or formation clearly, indicate if water bearing, and give thickness and depth as indicated.)

MATERIAL	Thickness (Feet)	Depth to Bottom (Feet)
Not known		

If log of well is not available, give name and address of driller: T. J. Burkhart, 169 N. 1st W., Tremonton, Utah

11. Infiltration Trench: Covered or open
 Dimensions: Length ft. Minimum depth ft. Maximum depth ft.

Bottom width ft. Discharge g.p.m. Date of test

12. Tunnel: Type of lining

Dimensions:
(Length, course, and cross sectional size)

Position of water bearing stratum with reference to portal of tunnel

Log of tunnel: (Preceding table for log of well may be used, if desired. Give footage from portal and character of materials, as pertinent.)

13. Pumping Equipment:
 (a) Pump Westinghouse 3" centrifugal Capacity 100 g.p.m.
(Make, type and size)

(b) Motor 15 H.P. electric
(Type and horsepower)

14. Location of area irrigated or to be irrigated, or place of use if for purposes other than irrigation.

Township North or South	Range E. or W. of Williamsite Meridian	Section	Forty-acre Tract	Number Acres To Be Irrigated	Date of Reclamation
10 S	3 W	6	SE 1/4 of NE 1/4	21.0	
10 S	3 W	6	NE 1/4 of SE 1/4	3.4	
				24.4	

15. If the ground water supply is supplemental to an existing water supply, identification of any application for a permit, permit, certificate or adjudicated right to appropriate water made or held by the registrant.

Township 10S Range 34W, W.M.
North

For Map see File GR-202

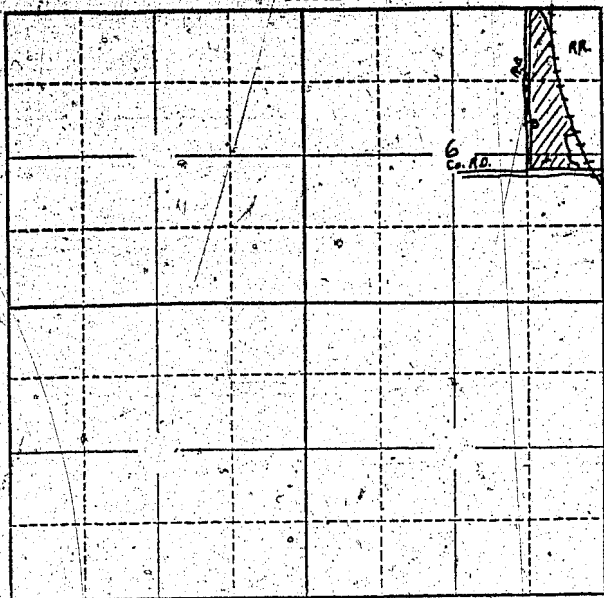

Locate well and acreage of irrigated land on plat.

Scale: 2" = 1 Mile

STATE OF OREGON

County of Linn

ss.

I, Chester F. & Hazel M. Royer, being first duly sworn, do hereby certify that I have read the foregoing Registration Statement and that all of the items therein contained are true to the best of my knowledge and belief.

Chester F. Royer
Hazel M. Royer
(Signature of Registrant)

Subscribed and sworn to before me this 7th day of November, 1956.

My commission expires April 11-1960. Marjorie L. Amos
(Notary Public) for Oregon

(SEAL)

CERTIFICATE OF REGISTRATION

STATE OF OREGON

County of Marion

ss.

This is to certify that the foregoing Registration Statement was received in the office of the State Engineer on the 27th day of June, 1956, at 8 o'clock A. M. and has been duly recorded in said office in Book No. 1 of Registration Statements on page GR-188 G.

~~Construction shall be completed by X-X-X-X-X-X-X-X-X-X-X-X and the water completely applied to X-X-X-X-X-X-X-X-X-X-X-X.~~

Witness my hand this 23rd day of November, 1956.

Lewis A. Stanley
(State Engineer)

By _____ (Deputy)

GR-188G