

RECEIVED
1914
STATE ENGINEER
SALEM, OREGON

Registration No. GR. 2021
Certificate No. GR. 1948

Registration Statement

OF CLAIMANT OF RIGHT TO APPROPRIATE GROUND WATER

TO THE STATE ENGINEER OF OREGON:

I, R. P. Jensen (RUSSELL JENSEN)

of Route 1, Box 18, Central Point, County of Jackson

State of Oregon, do hereby make application for a certificate of registration as evidence of a right to appropriate ground water.

1. Source from which water is withdrawn is hump well
(Flowing well, pump well, infiltration trench, or tunnel)

2. Location is: 1 3/4 miles northwest of Central Point, Oregon
(Approximate distance and direction from nearest city or town)

and is more particularly described as follows:

(a) 1174 feet south and 990 feet east from the NW corner of DIC #58
(Give distance and bearing to corner of section or other legal subdivision)

being within N 1/2 SW 1/4 SW 1/4 of Sec. 34, Twp. 36 S., Rge. 2 W.
(Smallest legal subdivision) (N. or S.) (E. or W.)

or (b) within limits of recorded platted property, town or city:

in Lot _____, Block _____ of _____
(Name of plat or addition)

County of _____
(If within city or town, give name)

3. Construction Work was begun on Sept. 1954; was completed on Sept. 1954
(Date) (Date)

and the ground water claimed was first used for the purposes set out below on September 1954
(Date)

since which time the water has been used continuously
(Continuously or intermittently)

from Sept. 1954 to present
(Date) (Date)

4. Quantity of water claimed and used is 40 gallons per minute; 14 acre feet per year.

5. Purpose or Purposes for which water is used irrigation

(Domestic, irrigation, municipal, manufacturing, industrial, etc.)

6. Description of Well: Depth 46 feet. Type dug
(Dug or drilled)

diameter 24 inches. Elevation of ground at well site 1225 feet, mean sea level.
(As near as known)

Depth to water table 10 feet.

7. Capacity of Well: 40 g.p.m. with 15 feet drawdown.

_____ g.p.m. with _____ feet drawdown.

Date of test none noted from use.

If Flowing Well: Measured discharge _____ g.p.m. on _____
(Date)

Shut-in pressure at ground surface _____ lbs. per sq. in. on _____
(Date)

Water is controlled by _____
(Cap, valve, etc.)

Township 36 S. Range 2 W. W.M.
North

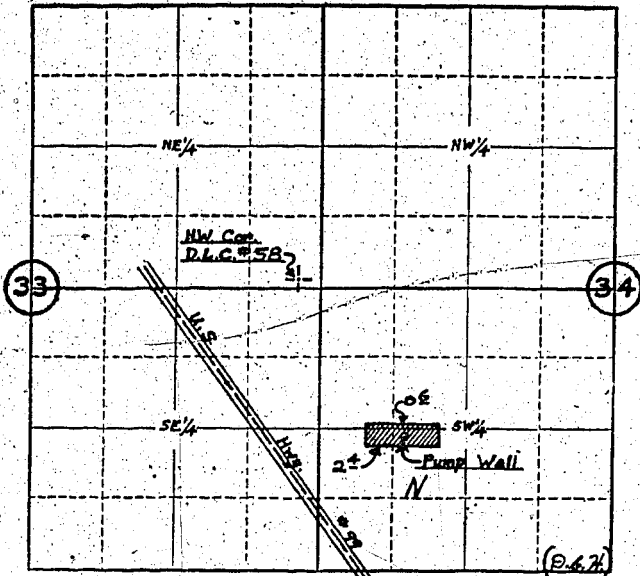

Locate well and acreage of irrigated land on plat.
Scale: 4" = 1 Mile

STATE OF OREGON

County of JACKSON } ss.

I, RUSSELL F. JENSEN, being first duly sworn, do hereby certify that I have read the foregoing Registration Statement and that all of the items therein contained are true to the best of my knowledge and belief.

Russell Jensen
(Signature of Registrant)

Subscribed and sworn to before me this 7th day of January, 1951

My commission expires Apr 5, 1962

John H. Nelson
(Notary Public)

(SEAL)

CERTIFICATE OF REGISTRATION

STATE OF OREGON

County of Marion } ss.

This is to certify that the foregoing Registration Statement was received in the office of the State Engineer on the 10th day of July, 1950, at 8:00 o'clock A.M. and has been duly recorded in said office in Book No. 9 of Registration Statements on page GR-1918

Witness my hand this 9th day of February

1959

Clara A. Stanley
(State Engineer)

By

(Deputy)

GR - 1948

\$15.00