

Registration Statement

OF CLAIMANT OF RIGHT TO APPROPRIATE GROUND WATER

TO THE STATE ENGINEER OF OREGON:

I, U. S. ALDERMAN

of DAYTON County of YAMHILL

State of OREGON, do hereby make application for a certificate of registration as evidence of a right to appropriate ground water.

1. Source from which water is withdrawn is PUMP WELL #9
(Flowing well, pump well, infiltration trench, or tunnel)

2. Location is: SEVEN MILES SOUTH DAYTON ON GRAND ISLAND
(Approximate distance and direction from nearest city or town)

and is more particularly described as follows:

(a) 133 FT. NORTH 83° 25' EAST FROM SW CORNER OF SECTION 21
(Give distance and bearing to corner of section or other legal subdivision)
being within SW 1/4 SW 1/4 of Sec. 21, Twp. 5 S, Rge. 3 W
(Smallest legal subdivision) (N. or S.) (E. or W.)

or (b) within limits of recorded platted property, town or city:

in Lot _____, Block _____ of _____
(Name of plat or addition)

County of _____
(If within city or town, give name)

3. Construction Work was begun on JUNE 1942; was completed on JUNE 1942
(Date) (Date)

and the ground water claimed was first used for the purposes set out below on JUNE 1942
(Date)

since which time the water has been used CONTINUOUSLY
(Continuously or intermittently)

from APRIL to OCTOBER
(Date) (Date)

4. Quantity of water claimed and used is 420 gallons per minute; 38 acre feet per year.

5. Purpose or Purposes for which water is used IRRIGATION

(Domestic, irrigation, municipal, manufacturing, industrial, etc.)

6. Description of Well: Depth 31 feet. Type DRILLED
(Dug or drilled)

diameter 8 inches. Elevation of ground at well site 80 feet, mean sea level.
(As near as known)

Depth to water table 5 feet.

7. Capacity of Well: _____ g.p.m. with _____ feet drawdown.

_____ g.p.m. with _____ feet drawdown.

Date of test NO TEST

If Flowing Well: Measured discharge _____ g.p.m. on _____
(Date)

Shut-in pressure at ground surface _____ lbs. per sq. in. on _____
(Date)

Water is controlled by _____
(Cap, valve, etc.)

Township 5S Range 3W W.M.
North

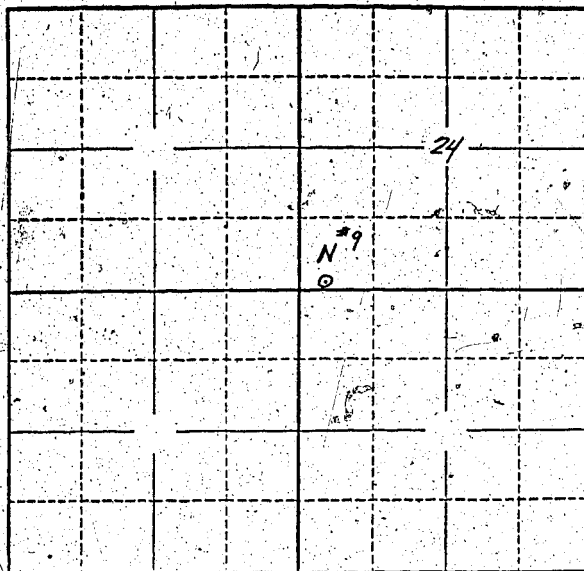

Locate well and acreage of irrigated land on plat.
Scale: 2" = 1 Mile

STATE OF OREGON }
County of YAMHILL } ss.

I, J.S. Alderman, being first duly sworn, do hereby certify that I have read the foregoing Registration Statement and that all of the items therein contained are true to the best of my knowledge and belief.

J.S. Alderman
(Signature of Registrant)

Subscribed and sworn to before me this 7th day of April, 19 58

My commission expires NOTARY PUBLIC FOR OREGON
My Commission Expires May 4, 1959

John E. Payne
(Notary Public)

(SEAL)

CERTIFICATE OF REGISTRATION

STATE OF OREGON }
County of Marion } ss.

This is to certify that the foregoing Registration Statement was received in the office of the State Engineer on the 10th day of July, 1958, at 8:00 o'clock A.M. and has been duly recorded in said office in Book No. 9 of Registration Statements on page GR-1963

Witness my hand this 9th day of February, 19 59

Lewis A. Stanley
(State Engineer)

#15.30

By _____
(Deputy)