

Registration Statement

OF CLAIMANT OF RIGHT TO APPROPRIATE GROUND WATER

TO THE STATE ENGINEER OF OREGON:

I, M. A. Wheeler

of Route 1 Box 118, Mulino, Oregon County of Clackamas
(Mailing address)

State of Oregon, do hereby make application for a certificate of registration as evidence of a right to appropriate ground water.

1. Source from which water is withdrawn is PUMP well
(Flowing well, pump well, infiltration trench, or tunnel)

2. Location is: 1 mile south of Mulino
(Approximate distance and direction from nearest city or town)

and is more particularly described as follows:

(a) 740' west and 1110' south of the N. E. corner of Section 29
(Give distance and bearing to corner of section or other legal subdivision)

being within N. E. 1/4 of NE 1/4 of Sec. 29, Twp. 15, Rge. 2 E
(Smallest legal subdivision) (N. or S.) (E. or W.)

or (b) within limits of recorded platted property, town or city:

in Lot _____, Block _____ of _____
(Name of plat or addition)

County of _____
(If within city or town, give name)

3. Construction Work was begun on July, 1950; was completed on August, 1950
(Date) (Date)

and the ground water claimed was first used for the purposes set out below on May, 1951
(Date)

since which time the water has been used Intermittently
(Continuously or Intermittently)

from May 1 to October 31
(Date) (Date)

4. Quantity of water claimed and used is 98 gallons per minute; _____ acre feet per year.

5. Purpose or Purposes for which water is used Irrigation

(Domestic, irrigation, municipal, manufacturing, industrial, etc.)

6. Description of Well: Depth 10 feet. Type Dug
(Dug or drilled)

diameter 36 inches. Elevation of ground at well site 150 feet, mean sea level.
(As near as known)

Depth to water table 7.5 feet.

7. Capacity of Well: _____ g.p.m. with _____ feet drawdown.

_____ g.p.m. with _____ feet drawdown.

Date of test Not tested

If Flowing Well: Measured discharge _____ g.p.m. on _____
(Date)

Shut-in pressure at ground surface _____ lbs. per sq. in. on _____
(Date)

Water is controlled by _____
(Cap, valve, etc.)

8. Casing: (Give diameter, commercial specifications and depth below ground surface of each casing size.)

36 inch diameter Concrete well curb from 0 to 10 feet
 inch diameter from to feet
 inch diameter from to feet
 inch diameter from to feet

Describe and show depth of shoe, plug, adapter, liner or other details:

9. Perforated Casings or Screens:

(Number per foot and size of perforations, or describe screen)

from to
 from to
 from to
 from to

10. Log of Well: (Describe each stratum or formation clearly, indicate if water bearing, and give thickness and depth as indicated.)

MATERIAL	Thickness (Feet)	Depth to Bottom (Feet)
Top soil	5'	5'
Sand and gravel	5'	10'

Township 4 S Range 2 E, W.M.
North

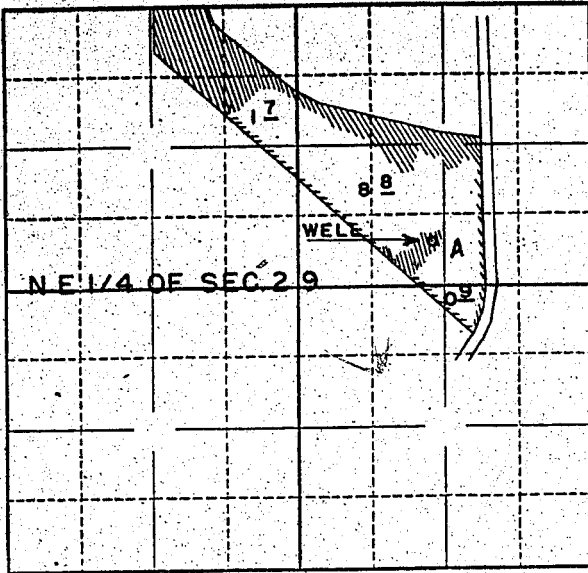

Locate well and acreage of irrigated land on plat.

Scale: $\frac{1}{8}$ " = 1 Mile
8"

STATE OF OREGON

County of Clatsop } ss.

I, M. A. Wheeler, being first duly sworn, do hereby certify that I have read the foregoing Registration Statement and that all of the items therein contained are true to the best of my knowledge and belief.

x M. A. Wheeler
(Signature of Registrant)

Subscribed and sworn to before me this 10 day of July, 1958

My commission expires Aug 21, 1959 L. H. Riffin
(Notary Public) per Oregon

(SEAL)

CERTIFICATE OF REGISTRATION

STATE OF OREGON

County of Marion } ss.

This is to certify that the foregoing Registration Statement was received in the office of the State Engineer on the 11th day of July, 1958, at 8:00 o'clock A. M. and has been duly recorded in said office in Book No. 9 of Registration Statements on page GR-1985

Witness my hand this 9th day of February, 1959
Lewis A. Standley
(State Engineer)

\$15.00

By _____
(Deputy)

GR - 1985