

Registration Statement

REGISTRATION NO. GR-2070CERTIFICATE NO. GR-1992

OF CLAIMANT OF RIGHT TO APPROPRIATE GROUND WATER

(Under Chapter 708, Oregon Laws 1955.)

TO THE STATE ENGINEER OF OREGON:

I, Larry H. Westof Washington County of ClackamasState of Oregon, do hereby make application for a certificate of registration as evidence of a right to appropriate ground water.1. Source from which water is withdrawn is Shallow well
(Flowing well, pump well, infiltration trench, or tunnel)2. Location is: Two miles north of Monterey
(Approximate distance and direction from nearest city or town)and is more particularly described as follows: 930 feet east of 1950 feet north from SW corner Sect. 13(a) Well is approximately 55 feet and 13 3/4 feet S. from intersection marking center of Sec. 13
(Give distance and bearing to corner of section or other legal subdivision)
being within NW 1/4 Sec. 13 of Sec. 13, Twp. 5S Rge. 1W
(Smallest legal subdivision) (or S.) (or W.)

or (b) within limits of recorded platted property, town or city:

in Lot _____, Block _____ of _____
(Name of plat or addition)County of Clackamas
(If within city or town, give name)3. Construction Work was begun on Mar 42; was completed on Mar 47
(Date) (Date)and the ground water claimed was first used for the purposes set out below on May 30, 47
(Date)

since which time the water has been used _____

from 5-30-47 to 7-9-58 intermittently for irrigation
(Date) (Date) (Continuously or Intermittently)4. Quantity of water claimed and used is 96 gallons per minute; _____ acre
feet per year.5. Purpose or Purposes for which water is used irrigation and domestic

(Domestic, irrigation, municipal, manufacturing, industrial, etc.)

6. Description of Well: Depth 110 feet. Type shallow
(Dug or drilled)

diameter _____ inches. Elevation of ground at well site _____ feet, mean sea level.

Depth to water table 37 feet.
(As near as known)7. Capacity of Well: 96 g.p.m. with unk feet drawdown.

_____ g.p.m. with _____ feet drawdown.

Date of test Mar 47If Flowing Well: Measured discharge _____ g.p.m. on _____
(Date)Shut-in pressure at ground surface _____ lbs. per sq. in. on _____
(Date)Water is controlled by _____
(Cap, valve, etc.)

If log of well is not available, give name and address of driller: Byron Bellver
R.R. 2 Woodburn Cal.

11. Infiltration Trench: Covered or open _____
 Dimensions: Length _____ ft. Minimum depth _____ ft. Maximum depth _____ ft.
 Bottom width _____ ft. Discharge _____ g.p.m. Date of test _____

12. Tunnel: Type of lining _____
 Dimensions: _____
(Length, course, and cross sectional size)
 Position of water bearing stratum with reference to portal of tunnel _____

Log of tunnel: (Preceding table for log of well may be used, if desired. Give footage from portal and character of materials, as pertinent.) _____

13. Pumping Equipment:
 (a) Pump Jurbin 1 1/2 cup (Cooke) Capacity 96 g.p.m.
(Make, type and size)
 (b) Motor U. O. Electrical motor (3 horse)
(Type and horsepower)

14. Location of area irrigated or to be irrigated, or place of use if for purposes other than irrigation.

Township North or South	Range E. or W. of Willamette Meridian	Section	Forty-acre Tract	Number Acres To Be Irrigated	Date of Reclamation
5 South	1 West	13	4.3.7	Can irrigate 3500 surface present suit of pipes	Started pumping for irrigation May 30, 1947
T5S	R1W	13		18°	
"	"	"	NW 1/4 of SE 1/4	12°	
"	"	"	NE 1/4 of SE 1/4	2°	
"	"	"	SW 1/4 of SE 1/4	1°	
"	"	"	SE 1/4 of SE 1/4	33°	

15. If the ground water supply is supplemental to an existing water supply, identification of any application for a permit, permit, certificate or adjudicated right to appropriate water made or held by the registrant.

Township 5S Range 1W, W.M.

North

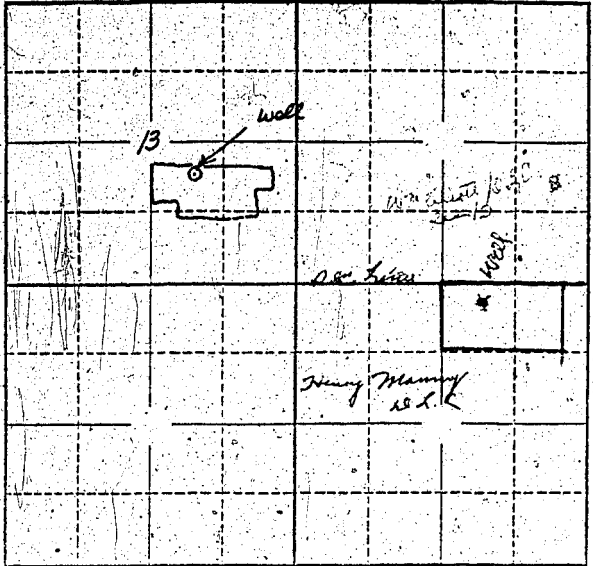

Locate well and acreage of irrigated land on plat.
Scale: 2" = 1 Mile

STATE OF OREGON

County of Clatsop } ss.

I, Leroy A. Wiest, being first duly sworn, do hereby certify that I have read the foregoing Registration Statement and that all of the items therein contained are true to the best of my knowledge and belief.

Leroy A. Wiest
(Signature of Registrant)

Subscribed and sworn to before me this 11th day of July, 1958

My commission expires 8-22-61 W. B. Peterson
(Notary Public) for Oregon

(SEAL)

CERTIFICATE OF REGISTRATION

STATE OF OREGON

County of Marion } ss.

This is to certify that the foregoing Registration Statement was received in the office of the State Engineer on the 11th day of July, 1958, at 2:30 o'clock P.M. and has been duly recorded in said office in Book No. 9 of Registration Statements on page GR-1992

~~Construction credit has been completed by [unclear] and the water completed applied to beneficial use by [unclear]~~

Witness my hand this 9th day of February, 1959

Levia A. Stanley
(State Engineer)

By _____ (Deputy)

GR-1992

#1545