

RECEIVED  
JUN 14 1948  
STATE ENGINEER  
SALES OREGON

Registration No. GR-2623  
Certificate No. GR-1887

# Registration Statement

## OF CLAIMANT OF RIGHT TO APPROPRIATE GROUND WATER

TO THE STATE ENGINEER OF OREGON:

We, The Oregonian Publishing Company

of 1320 S. W. Broadway County of Multnomah  
(Mailing address)

State of Oregon, do hereby make application for a certificate of registration as evidence of a right to appropriate ground water.

1. Source from which water is withdrawn is Pump Well #1  
(Flowing well, pump well, infiltration trench, or tunnel).

2. Location is: \_\_\_\_\_  
(Approximate distance and direction from nearest city or town)

and is more particularly described as follows:

(a) 103' West of NE corner of Block 185 (corner SW Sixth & Jefferson) and 8' North of property line (under sidewalk)  
(Give distance and bearing to corner of section or other legal subdivision)

being within \_\_\_\_\_ of Sec. \_\_\_\_\_, Twp. \_\_\_\_\_, Rge. \_\_\_\_\_  
(Smallest legal subdivision) (N. or S.) (E. or W.)

or (b) within limits of recorded platted property, town or city: \_\_\_\_\_

in Lot 1 to 8, Block 185 of Portland  
(Name of plat or addition)

Portland County of Multnomah  
(If within city or town, give name)

3. Construction Work was begun on \_\_\_\_\_; was completed on June 26, 1947  
(Date) (Date)

and the ground water claimed was first used for the purposes set out below on May 15, 1948  
(Date)

since which time the water has been used continuously  
(Continuously or intermittently)

from May 15, 1948 to present date  
(Date) (Date)

4. Quantity of water claimed and used is 400 gallons per minute; \_\_\_\_\_ acre foot per year.

5. Purpose or Purposes for which water is used Air Conditioning building  
Industrial  
(Domestic, irrigation, municipal, manufacturing, industrial, etc.)

6. Description of Well: Depth 203 feet. Type Drilled  
(Dug or drilled)  
diameter 18 inches. Elevation of ground at well site 98 feet, mean sea level.  
(As near as known)  
Depth to water table 95 feet.

7. Capacity of Well: 1100 g.p.m. with 60 feet drawdown.  
\_\_\_\_\_ g.p.m. with \_\_\_\_\_ feet drawdown.

Date of test June 24, 1947

If Flowing Well: Measured discharge \_\_\_\_\_ g.p.m. on \_\_\_\_\_  
(Date)

Shut-in pressure at ground surface \_\_\_\_\_ lbs. per sq. in. on \_\_\_\_\_  
(Date)

Water is controlled by \_\_\_\_\_  
(Cap, valve, etc.)

8. Casing: (Give diameter, commercial specifications and depth below ground surface of each casing size.)

18 inch diameter standard steel pipe from ground to 191 feet  
inch diameter from to feet  
inch diameter from to feet  
inch diameter from to feet

Describe and show depth of shoe, plug, adapter, liner or other details:

9. Perforated Casings or Screens:

Not available from to  
(Number per foot and size of perforations, or describe screen)  
from to  
from to  
from to

10. Log of Well: (Describe each stratum or formation clearly, indicate if water bearing, and give thickness and depth as indicated.)

MATERIAL	Thickness (Feet)	Depth to Bottom (Feet)
Fill and clay	9	
Brown sand	62	
Cemented gravel	41	
Gravel and sand - clay binder	14	
Loose sand and gravel - water bearing formation	15	7
Hard cemented gravel	16	
Cemented gravel	13	
Loose sand and gravel - water bearing formation	18	
Cemented gravel	14	

If log of well is not available, give name and address of driller. ....

11. Infiltration Trench: Covered or open .....

Dimensions: Length ..... ft. Minimum depth ..... ft. Maximum depth ..... ft.

Bottom width ..... ft. Discharge ..... g.p.m. Date of test .....

12. Tunnel: Type of lining .....

Dimensions: .....  
(Length, course, and cross sectional size)

Position of water bearing stratum with reference to portal of tunnel .....

Log of tunnel: (Preceding table for log of well may be used, if desired. Give footage from portal and character of materials, as pertinent.)

13. Pumping Equipment:

(a) Pump ..... 12-1010BE-4  
 Worthington Vertical Turbine 4 stage ..... Capacity ..... g.p.m.  
(Make, type and size)

(b) Motor ..... U. S. Motor CFL 30 HP  
(Type and horsepower)

14. Location of area irrigated or to be irrigated, or place of use if for purposes other than irrigation.

Township North or South	Range E. or W. of Willamette Meridian	Section	Forty-acre Tract	Number Acres To Be Irrigated	Date of Reclamation

15. If the ground water supply is supplemental to an existing water supply, identification of any application for a permit, permit, certificate or adjudicated right to appropriate water made or held by the registrant.

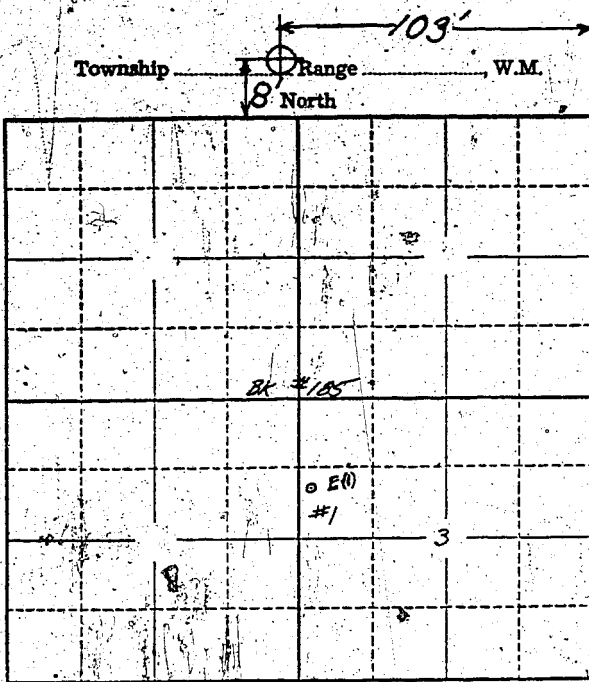

Locate well and acreage of irrigated land on plat  
 Scale: 2" = 1 Mile

STATE OF OREGON

County of Multnomah } ss.

I, James A. Melvin, being first duly sworn, do hereby certify that I have read the foregoing Registration Statement and that all of the items therein contained are true to the best of my knowledge and belief.

*James A. Melvin*, Mach. Supt.  
 (Signature of Registrant)

Subscribed and sworn to before me this 2 day of July, 1958

My commission expires 8/10/58

*J. R. Jewell*  
 (Notary Public)

(SEAL)

**CERTIFICATE OF REGISTRATION**

STATE OF OREGON

County of Marion } ss.

This is to certify that the foregoing Registration Statement was received in the office of the State Engineer on the 11th day of July, 1958, at 1:00 o'clock P.M. and has been duly recorded in said office in Book No. 9 of Registration Statements on page GR-1887

Witness my hand this 26th day of January, 1959

*Lewis A. Stanley*  
 (State Engineer)

By \_\_\_\_\_ (Deputy)

\$20.00

GR-1887