

Registration No. GR-2081

Certificate No. GR 3846

# Registration Statement

## OF CLAIMANT OF RIGHT TO APPROPRIATE GROUND WATER

TO THE STATE ENGINEER OF OREGON:

I, Edward Dempsey

of R. 2 Eugene County of Lane  
(Mailing address)

State of Ore, do hereby make application for a certificate of registration as evidence of a right to appropriate ground water.

1. Source from which water is withdrawn is Dump Well #1  
(Flowing well, pump well, infiltration trench or tunnel)

2. Location is: Four miles East of Monroe  
(Approximate distance and direction from nearest city or town)

and is more particularly described as follows:

(a) 1/2 CH. E. & 1/2 CH. N. & SE COR. OF SW 1/4 OF SEC 25  
(Give distance and bearing to corner of section or other legal subdivision)

being within SW 1/4 SE 1/4 of Sec. 25, Twp. 14S Rge. 5W  
(Smallest legal subdivision) (N. or S.) (E. or W.)

or (b) within limits of recorded platted property, town or city:

in Lot \_\_\_\_\_, Block \_\_\_\_\_ of \_\_\_\_\_  
(Name of plat or addition)

(If within city or town, give name) County of Benton

3. Construction Work was begun on 1950; was completed on 1950  
(Date) (Date)

and the ground water claimed was first used for the purposes set out below on 1950  
(Date)

since which time the water has been used intermittently during season  
(Continuously or intermittently)

from 1950 to Oct 1950  
(Date) (Date)

4. Quantity of water claimed and used is 160 gallons per minute; \_\_\_\_\_ acre feet per year.

5. Purpose or Purposes for which water is used Irrigation

(Domestic, irrigation, municipal, manufacturing, industrial, etc.)

6. Description of Well: Depth 19 feet. Type Driven  
(Dug or drilled)

diameter 4 inches. Elevation of ground at well site \_\_\_\_\_ feet, mean sea level.  
(As near as known)

Depth to water table 8 feet.

7. Capacity of Well: \_\_\_\_\_ g.p.m. with \_\_\_\_\_ feet drawdown.  
\_\_\_\_\_ g.p.m. with \_\_\_\_\_ feet drawdown.

Date of test \_\_\_\_\_

If Flowing Well: Measured discharge \_\_\_\_\_ g.p.m. on \_\_\_\_\_  
(Date)

Shut-in pressure at ground surface \_\_\_\_\_ lbs. per sq. in. on \_\_\_\_\_  
(Date)

Water is controlled by \_\_\_\_\_  
(Cap, valve, etc.)





Township 14S Range 5W W.M.  
North

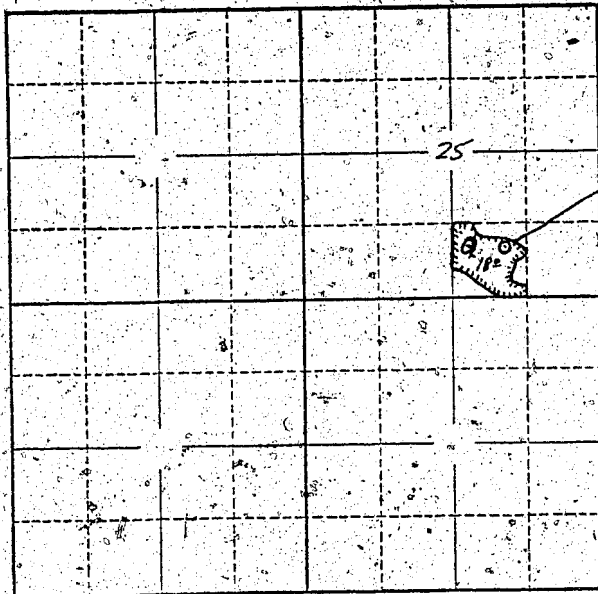

Locate well and acreage of irrigated land on plat.  
Scale: 2" = 1 Mile

STATE OF OREGON

County of Marion

} ss.

I, Edward Dempsey, being first duly sworn, do hereby certify that I have read the foregoing Registration Statement and that all of the items therein contained are true to the best of my knowledge and belief.

Edward Dempsey  
(Signature of Registrant)

Subscribed and sworn to before me this 14th day of July, 1958

My commission expires 12th June 1961

Wm. S. Partholones  
(Notary Public)

(SEAL)

**CERTIFICATE OF REGISTRATION**

STATE OF OREGON

County of Marion

} ss.

This is to certify that the foregoing Registration Statement was received in the office of the State Engineer on the 14th day of July, 1958, at 11:45 o'clock A. M. and has been duly recorded in said office in Book No. 16 of Registration Statements on page GR- 3846

Witness my hand this 28 day of December, 1959

James A. Stanley  
(State Engineer)

By

(Deputy)

GR 3846

\$ 15.00