

RECEIVED
JUL 14 1958
STATE ENGINEER
SALEM, OREGON

REGISTRATION NO. GR 2098
CERTIFICATE NO. GR 2015

Registration Statement

OF CLAIMANT OF RIGHT TO APPROPRIATE GROUND WATER

(Under Chapter 708, Oregon Laws 1955.)

TO THE STATE ENGINEER OF OREGON:

I, George Ransom

of Box 227 Milton Freewater County of Umatilla

State of Oregon, do hereby make application for a certificate of registration as evidence of a right to appropriate ground water.

- 1. Source from which water is withdrawn is Pump Well
- 2. Location is: 3 Miles North Milton Freewater Ore

and is more particularly described as follows:

(a) 232 ft. E & 13 ft. N of SW corner of NW 1/4, SW 1/4 of NW 1/4
(Give distance and bearing to corner of section or other legal subdivision)
 being within S 1/4 NW 1/4 of NW 1/4 of Sec. 25, Twp. 6N, Rge. 35E
(Smallest legal subdivision) (N. or S.) (E. or W.)

or (b) within limits of recorded platted property, town or city: Not in City or Platted Property

in Lot _____, Block _____ of _____
(Name of plat or addition)

County of _____
(If within city or town, give name)

3. Construction Work was begun on Mar 1924; was completed on July 1925
(Date) (Date)

and the ground water claimed was first used for the purposes set out below on July 1924
(Date)

since which time the water has been used continuously
(Continuously or Intermittently)
 from Apr or May to Sept or Oct each year
(Date) (Date)

4. Quantity of water claimed and used is 300 gallons per minute; 60 acre feet per year.

5. Purpose or Purposes for which water is used irrigation

6. Description of Well: Depth 64 feet. Type 30' Dug + 34 drilled
(Dug or drilled)
 diameter 8 inches. Elevation of ground at well site 850 feet, mean sea level.
(As near as known)
 Depth to water table 16 feet.

7. Capacity of Well: 420 g.p.m. with 5 feet drawdown.
 _____ g.p.m. with _____ feet drawdown.

Date of test Never tested

If Flowing Well: Measured discharge Not flowing g.p.m. on _____
(Date)

Shut-in pressure at ground surface _____ lbs. per sq. in. on _____
(Date)

Water is controlled by _____
(Cap, valve, etc.)

NW 1/4 Section 25

Township 6N Range 35E W.M.

North

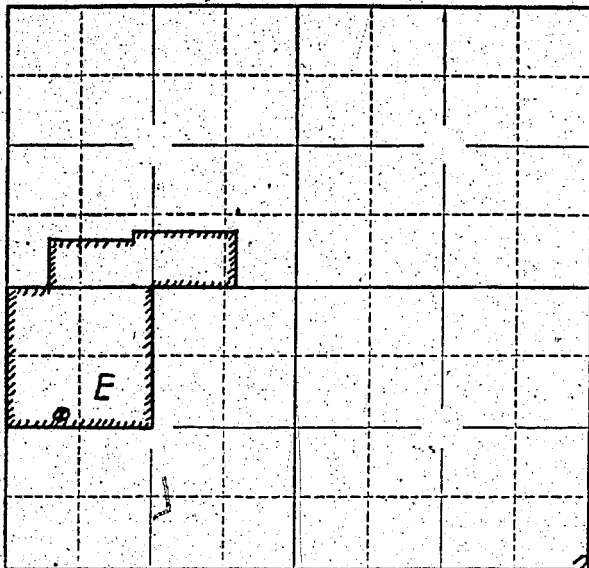

Well location
332' E &
17' N of
SW corner
of Property

Locate well and acreage of irrigated land on plat.

Scale: 4" = 1 Mile
8"

STATE OF OREGON

County of Umatilla } ss.

I, George Ranson, being first duly sworn, do hereby certify that I have read the foregoing Registration Statement and that all of the items therein contained are true to the best of my knowledge and belief.

Geo Ranson
(Signature of Registrant)

Subscribed and sworn to before me this 9th day of July, 1958

My commission expires May 7, 1961

Harvey
(Notary Public) for Oregon

(SEAL)

CERTIFICATE OF REGISTRATION

STATE OF OREGON }
County of Marion } ss.

This is to certify that the foregoing Registration Statement was received in the office of the State Engineer on the 14 day of July, 1958, at 8:00 o'clock A. M. and has been duly recorded in said office in Book No. 9 of Registration Statements on page GR-2015

~~Construction shall be completed by _____ and the water completely applied to beneficial use by _____~~

Witness my hand this 9th day of February, 1959

Leura A. Stanley
(State Engineer)

By _____ (Deputy)

\$15.00

GR-2015