

Registration Statement

RECEIVED
FEB 11 1950
STATE ENGINEER
SALEM, OREGON

OF CLAIMANT OF RIGHT TO APPROPRIATE GROUND WATER

TO THE STATE ENGINEER OF OREGON:

I, Joe Knutson

of Harbor, Box 163 County of Curry
(Mailing address)

State of Oregon do hereby make application for a certificate of registration as evidence of a right to appropriate ground water.

1. Source from which water is withdrawn is Sump
(Flowing well, pump well, infiltration trench, or tunnel)

2. Location is: 2 miles SW of Harbor post office
(Approximate distance and direction from nearest city or town)

and is more particularly described as follows: 1800 feet south & 1100 feet east from Wly corner Section 9

(a) ~~Sec 9, Twp 41 S, Rge 13 W~~
(Give distance and bearing to corner of section or other legal subdivision)

being within SW 1/4 of SW 1/4 of Sec. 9, Twp. 41 S, Rge. 13 W
(Smallest legal subdivision) (N. or S.) (E. or W.)

or (b) within limits of recorded platted property, town or city:

in Lot _____, Block _____ of _____
(Name of plat or addition)

County of _____
(If within city or town, give name)

3. Construction Work was begun on unk.; was completed on August 10, 1952
(Date) (Date)

and the ground water claimed was first used for the purposes set out below on August 12, 1952
(Date)

since which time the water has been used continuously
(Continuously or Intermittently)

from Aug 12, 1952 to Nov - 1958
(Date) (Date)

4. Quantity of water claimed and used is 90 gallons per minute; 5 acre feet per year.

5. Purpose or Purposes for which water is used Irrigating Easter lilies

(Domestic, irrigation, municipal, manufacturing, industrial, etc.)

6. Description of Well: Depth _____ feet. Type _____
(Dug or drilled)

diameter _____ inches. Elevation of ground at well site _____ feet, mean sea level.
(As near as known)

Depth to water table _____ feet.

7. Capacity of Well: _____ g.p.m. with _____ feet drawdown.

_____ g.p.m. with _____ feet drawdown.

Date of test _____

If Flowing Well: Measured discharge _____ g.p.m. on _____
(Date)

Shut-in pressure at ground surface _____ lbs. per sq. in. on _____
(Date)

Water is controlled by _____
(Cap, valve, etc.)

Sumps 30' X 20' and 25 to 30' deep.

Township 41 S Range 13 W, W.M.

North

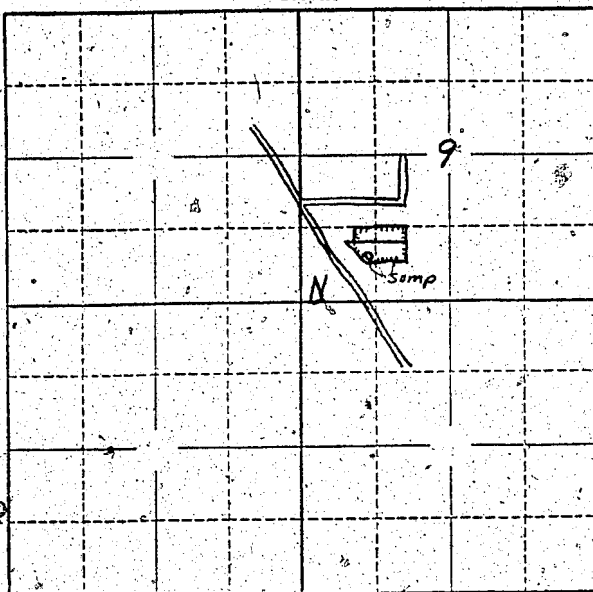

see Enclosure

Locate well and acreage of irrigated land on plat.

Scale: 2" = 1 Mile

STATE OF OREGON

County of Curry

I, Joe Krutson, being firstaduly sworn, do hereby certify that I have read the foregoing Registration Statement and that all of the items therein contained are true to the best of my knowledge and belief.

Joe Krutson
(Signature of Registrant)

Subscribed and sworn to before me this 13th day of July, 1958

My commission expires

Oleta O. Walker
(Notary Public)
County Clerk Curry Co., Ore

(SEAL)

CERTIFICATE OF REGISTRATION

STATE OF OREGON

County of Marion

This is to certify that the foregoing Registration Statement was received in the office of the State Engineer on the 7th day of July, 1958, at 8⁰⁰ o'clock A. M. and has been duly recorded in said office in Book No. 16 of Registration Statements on page GR-3954

Witness my hand this 15th day of February, 1960

Harold A. Stanley
(State Engineer)

By

(Deputy)

\$15.00

GR 3954