

Registration Statement

OF CLAIMANT OF RIGHT TO APPROPRIATE GROUND WATER

TO THE STATE ENGINEER OF OREGON:

I, Sadie P. Osenbrugge

of 711 East Main St. Medford County of Jackson

State of Oregon, do hereby make application for a certificate of registration as evidence of a right to appropriate ground water.

- 1. Source from which water is withdrawn is Infiltration trench (Sump)
(Flowing well, pump well, infiltration trench, or tunnel)
- 2. Location is: 8 miles S.W. of Jacksonville
(Approximate distance and direction from nearest city or town)

and is more particularly described as follows:

(a) 60 feet North and 2520 feet East from S. W. Cor. DIC #40
(Give distance and bearing to corner of section or other legal subdivision)

being within West half Donation Land of Sec. 33, Twp. 38 S., Rge. 3 W.
(Give nearest legal subdivision) (N. or S.) (E. or W.)

or (b) within limits of recorded platted property, town or city:

in Lot _____, Block _____ of _____
(Name of plat or addition)

County of _____

(If within city or town, give name)

3. Construction Work was begun on 1949; was completed on 1949
(Date) (Date)

and the ground water claimed was first used for the purposes set out below on 1949
(Date)

since which time the water has been used continuously
(Continuously or intermittently)

from 1949 to present
(Date) (Date)

4. Quantity of water claimed and used is 1025 gallons per minute; 450 acre feet per year.

5. Purpose or Purposes for which water is used Irrigation & Supplemental Irrigation

(Domestic, irrigation, municipal, manufacturing, industrial, etc.)

6. Description of Sump: Depth 20 feet. Type Dug
(Dug or drilled)

diam 10' X 150'. Elevation of ground at well site 1440 feet, mean sea level.
(As near as known)

Depth to water table 6.0 feet.

7. Capacity of Well: _____ g.p.m. with _____ feet drawdown.

_____ g.p.m. with _____ feet drawdown.

Date of test none

If Flowing Well: Measured discharge _____ g.p.m. on _____
(Date)

Shut-in pressure at ground surface _____ lbs. per sq. in. on _____
(Date)

Water is controlled by _____
(Cap, valve, etc.)

Township 38 S. Range 3 W., W.M.

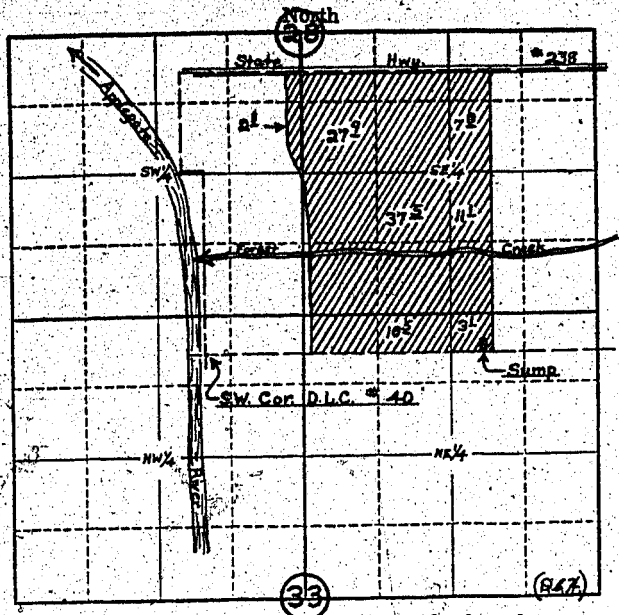

Locate well and acreage of irrigated land on plat.
Scale: 4" = 1 Mile

STATE OF OREGON }
County of Jackson } ss.

I, Sadie P. Osenbrugge, being first duly sworn, do hereby certify that I have read the foregoing Registration Statement and that all of the items therein contained are true to the best of my knowledge and belief.

Sadie P. Osenbrugge
(Signature of Registrant)

Subscribed and sworn to before me this 11 day of July, 1958.

My commission expires July 31 - 1959 Edith Saut
(Notary Public)

(SEAL)

CERTIFICATE OF REGISTRATION

STATE OF OREGON }
County of Marion } ss.

This is to certify that the foregoing Registration Statement was received in the office of the State Engineer on the 14 day of July, 1958, at 8:00 o'clock A. M. and has been duly recorded in said office in Book No. 9 of Registration Statements on page GR-2044

Witness my hand this 16th day of February, 1959

Luvia A. Stanley
(State Engineer)

By _____ (Deputy)

25-50

GR - 2044