

Registration Statement

OF CLAIMANT OF RIGHT TO APPROPRIATE GROUND WATER

TO THE STATE ENGINEER OF OREGON:

I, Dixon and Lola Saltsgaver

of Rt. 1, Box 524 Central Point County of Jackson

State of Oregon, do hereby make application for a certificate of registration as evidence of a right to appropriate ground water.

1. Source from which water is withdrawn is #2 Infiltration trench (Sump)
(Flowing well, pump well, infiltration trench, or tunnel)

2. Location is: 2 1/4 miles Northwest of Central Point, Oregon
(Approximate distance and direction from nearest city or town)

and is more particularly described as follows:

(a) 1960 feet north and 260 feet west from the S. E. corner of D.L.C.#
(Give distance and bearing to corner of section or other legal subdivision) 62

being within SW 1/4 NW 1/4 of Sec. 33, Twp. 36S, Rge. 2W
(Smallest legal subdivision) (N. or S.) (E. or W.)

or (b) within limits of recorded platted property, town or city:

in Lot _____, Block _____ of _____
(Name of plat or addition)

_____ County of _____
(If within city or town, give name)

3. Construction Work was begun on 1952; was completed on 1952
(Date) (Date)

and the ground water claimed was first used for the purposes set out below on 1953
(Date)

since which time the water has been used continuously
(Continuously or intermittently)

from 1953 to present
(Date) (Date)

4. Quantity of water claimed and used is 300 gallons per minute; 167 acre feet per year.

5. Purpose or Purposes for which water is used Irrigation

Sump (Domestic, irrigation, municipal, manufacturing, industrial, etc.)

6. Description of ~~well~~: Depth 9 feet. Type Dug
(Dug or drilled)

diameter 750' x 12' ~~holes~~. Elevation of ground at well site 1245' feet, mean sea level.
(As near as known)

Depth to water table 1.0 feet.

7. Capacity of Well: _____ g.p.m. with _____ feet drawdown.

_____ g.p.m. with _____ feet drawdown.

Date of test _____

If Flowing Well: Measured discharge _____ g.p.m. on _____
(Date)

Shut-in pressure at ground surface _____ lbs. per sq. in. on _____
(Date)

Water is controlled by _____
(Cap, valve, etc.)

Township 36 S Range 2 W W.M.

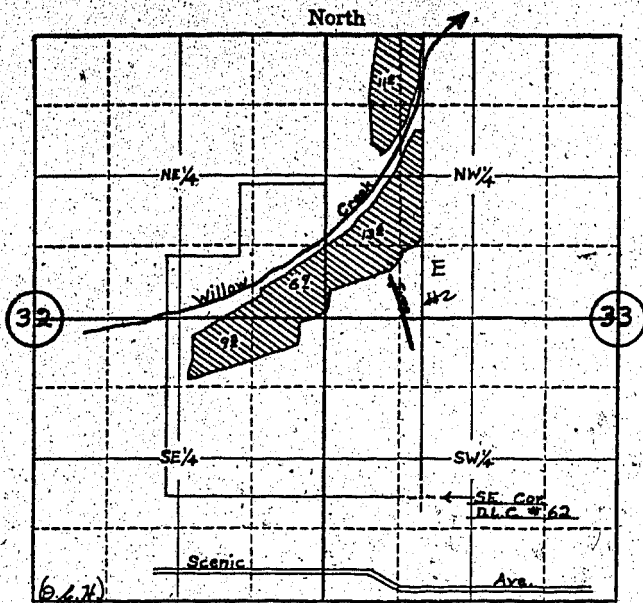

Locate well and acreage of irrigated land on plat.

Scale: 4" = 1 Mile

STATE OF OREGON

County of Jackson

} ss.

I, Dixon Sattogren and Lola Mrs. Sattogren, being first duly sworn, do hereby certify that I have read the foregoing Registration Statement and that all of the items therein contained are true to the best of my knowledge and belief.

Dixon Sattogren
Lola Mrs. Sattogren
(Signature of Registrant)

Subscribed and sworn to before me this 14th day of July, 1958

My commission expires Nov. 23-1960

Raymond Price
(Notary Public)

(SEAL)

CERTIFICATE OF REGISTRATION

STATE OF OREGON

County of Marion

} ss.

This is to certify that the foregoing Registration Statement was received in the office of the State Engineer on the 15th day of July, 1958, at 8:00 o'clock A.M. and has been duly recorded in said office in Book No. 9 of Registration Statements on page GR-2062

Witness my hand this 16th day of February, 1959

Lewis A. Stanley
(State Engineer)

\$16.80

By _____ (Deputy)