

# Registration Statement

## OF CLAIMANT OF RIGHT TO APPROPRIATE GROUND WATER

TO THE STATE ENGINEER OF OREGON:

I, H.O. Paeschke

of Junction City County of Lane  
(Mailing address)

State of Oregon, do hereby make application for a certificate of registration as evidence of a right to appropriate ground water.

1. Source from which water is withdrawn is Pump well #2  
(Flowing well, pump well, infiltration trench, or tunnel)

2. Location is: 5 miles W of Junction City  
(Approximate distance and direction from nearest city or town)

and is more particularly described as follows:

(a) 650' N & 1070' W from S.E. Cor. Sec. 30  
(Give distance and bearing to corner of section or other legal subdivision)

being within SE 1/4 of SE 1/4 of Sec. 30, Twp. 15 S. Rge. 4 W.  
(Smallest legal subdivision) (N. or S.) (E. or W.)

or (b) within limits of recorded platted property, town or city:

in Lot \_\_\_\_\_, Block \_\_\_\_\_ of \_\_\_\_\_  
(Name of plat or addition)

County of Lane  
(If within city or town, give name)

3. Construction Work was begun on 1950; was completed on 1950  
(Date) (Date)

and the ground water claimed was first used for the purposes set out below on 1950  
(Date)

since which time the water has been used Intermittently  
(Continuously or Intermittently)

from 1950 to Present  
(Date) (Date)

4. Quantity of water claimed and used is 400 gallons per minute; 700-65 acre feet per year.

5. Purpose or Purposes for which water is used Irrig.

(Domestic, irrigation, municipal, manufacturing, industrial, etc.)

6. Description of Well: Depth 20 feet. Type Driven  
(Dug or drilled)

diameter 4 inches. Elevation of ground at well site 312 feet, mean sea level.  
(As near as known)

Depth to water table 8 feet.

7. Capacity of Well: 400 g.p.m. with 2 feet drawdown.

\_\_\_\_\_ g.p.m. with \_\_\_\_\_ feet drawdown.

Date of test 1950

If Flowing Well: Measured discharge \_\_\_\_\_ g.p.m. on \_\_\_\_\_  
(Date)

Shut-in pressure at ground surface \_\_\_\_\_ lbs. per sq. in. on \_\_\_\_\_  
(Date)

Water is controlled by \_\_\_\_\_  
(Cap, valve, etc.)





Township 15S Range 4W W.M.  
North

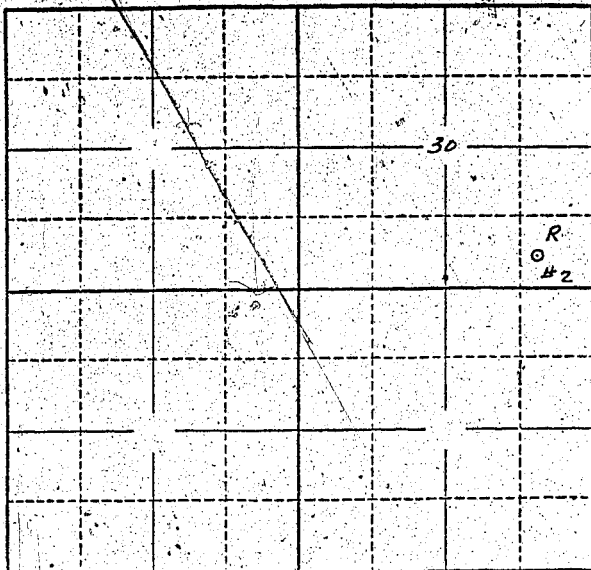

Locate well and acreage of irrigated land on plat,  
Scale: 2" = 1 Mile

STATE OF OREGON

County of Lane } ss.

I, Henry O. Paschke, being first duly sworn, do hereby certify that I have read the foregoing Registration Statement and that all of the items therein contained are true to the best of my knowledge and belief.

Henry O. Paschke  
(Signature of Registrant)

Subscribed and sworn to before me this 14<sup>th</sup> day of July, 1958

My commission expires Aug 3, 1958 Henry B. Smith  
(Notary Public)

(SEAL)

**CERTIFICATE OF REGISTRATION**

STATE OF OREGON

County of Marion } ss.

This is to certify that the foregoing Registration Statement was received in the office of the State Engineer on the 15<sup>th</sup> day of July, 1958, at 8:00 o'clock A. M. and has been duly recorded in said office in Book No. 9 of Registration Statements on page GR 2067

Witness my hand this 16<sup>th</sup> day of February, 1959

Lewis A. Stanley  
(State Engineer)

\$1500

By \_\_\_\_\_ (Deputy)

GR-2067