

# Registration Statement

## OF CLAIMANT OF RIGHT TO APPROPRIATE GROUND WATER

TO THE STATE ENGINEER OF OREGON:

I, WALTER JOHN SCHENDEL

of 175 BOOME ROAD County of MARION

State of OREGON, do hereby make application for a certificate of registration as evidence of a right to appropriate ground water.

1. Source from which water is withdrawn is PUMP WELL  
(Flowing well, pump well, infiltration trench, or tunnel)

2. Location is: 2 1/2 MILES SOUTH WEST OF SALEM  
(Approximate distance and direction from nearest city or town)

and is more particularly described as follows:

(a) 800' N & 1900' W from SE corner Section 9  
(Give distance and bearing to corner of section or other legal subdivision)

being within SW 1/4 SE 1/4 of Sec. 9, Twp. 8 S, Rge. 3 W  
(Smallest legal subdivision) (N. or S.) (E. or W.)

or (b) within limits of recorded platted property, town or city:

in Lot \_\_\_\_\_, Block \_\_\_\_\_ of J. R. PATTERSON D. L. C. No. 50  
(Name of plat or addition)

County of MARION  
(If within city or town, give name)

3. Construction Work was begun on August 1, 1951 was completed on August 27th, 1951  
(Date) (Date)

and the ground water claimed was first used for the purposes set out below on Sept. 15th, 1951  
(Date)

since which time the water has been used CONTINUOUSLY  
(Continuously or intermittently)

from Sept. 15, 1951 to \_\_\_\_\_  
(Date) (Date)

4. Quantity of water claimed and used is 27 gallons per minute; \_\_\_\_\_ acre feet per year.

5. Purpose or Purposes for which water is used Domestic & Irrigation about 4 acres

6. Description of Well: Depth 7.8 feet. Type Drilled  
(Domestic, irrigation, municipal, manufacturing, industrial, etc.) (Dig or drilled)

diameter 6" inches. Elevation of ground at well site \_\_\_\_\_ feet, mean sea level.  
(As near as known)

Depth to water table: 31 feet.

7. Capacity of Well: 27 g.p.m. with 40 or better feet drawdown.

\_\_\_\_\_ g.p.m. with \_\_\_\_\_ feet drawdown.

Date of test August 27th, 1951

If Flowing Well: Measured discharge \_\_\_\_\_ g.p.m. on \_\_\_\_\_  
(Date)

Shut-in pressure at ground surface \_\_\_\_\_ lbs. per sq. in. on \_\_\_\_\_  
(Date)

Water is controlled by \_\_\_\_\_  
(Cap, valve, etc.)

8. Casing: (Give diameter, commercial specifications and depth below ground surface of each casing size.)

6 inch diameter 4.6 ft. from to feet  
inch diameter from to feet  
inch diameter from to feet  
inch diameter from to feet

Describe and show depth of shoe, plug, adapter, liner or other details:

9. Perforated Casings or Screens:

None from to  
(Number per foot and size of perforations, or describe screen)  
from to  
from to  
from to

10. Log of Well: (Describe each stratum or formation clearly, indicate if water bearing, and give thickness and depth as indicated.)

	MATERIAL	Thickness (Feet)	Depth to Bottom (Feet)
44 feet	Clay + Porona Rock	44	78
34 feet	Strata Rock	34	78

If log of well is not available, give name and address of driller. Duffield Brothers,

4045 Bluff, S.E. Salem, Oregon

11. Infiltration Trench: Covered or open .....

Dimensions: Length ..... ft. Minimum depth ..... ft. Maximum depth ..... ft.

Bottom width ..... ft. Discharge ..... g.p.m. Date of test .....

12. Tunnel: Type of lining .....

Dimensions: .....  
(Length, course, and cross sectional size)

Position of water bearing stratum with reference to portal of tunnel .....

Log of tunnel: (Preceding table for log of well may be used, if desired. Give footage from portal and character of materials, as pertinent.)

13. Pumping Equipment:

(a) Pump Universal - 2" jet Capacity 30 g.p.m.  
(Make, type and size)

(b) Motor 2 H.P. Power 3425 Single Phase  
(Type and horsepower)

14. Location of area irrigated or to be irrigated, or place of use if for purposes other than irrigation.

Township North or South	Range E. or W. of Willamette Meridian	Section	Forty-acre Tract	Number Acres To Be Irrigated	Date of Reclamation
85	3W	9	SW <sup>1</sup> / <sub>4</sub> SE <sup>1</sup> / <sub>4</sub>	6 ac	1951
"	"	"	NW <sup>1</sup> / <sub>4</sub> SE <sup>1</sup> / <sub>4</sub>	2 ac	1951
				8 ac	

15. If the ground water supply is supplemental to an existing water supply, identification of any application for a permit, permit, certificate or adjudicated right to appropriate water made or held by the registrant.

None

Township 8 S Range 3 W, W.M.  
North

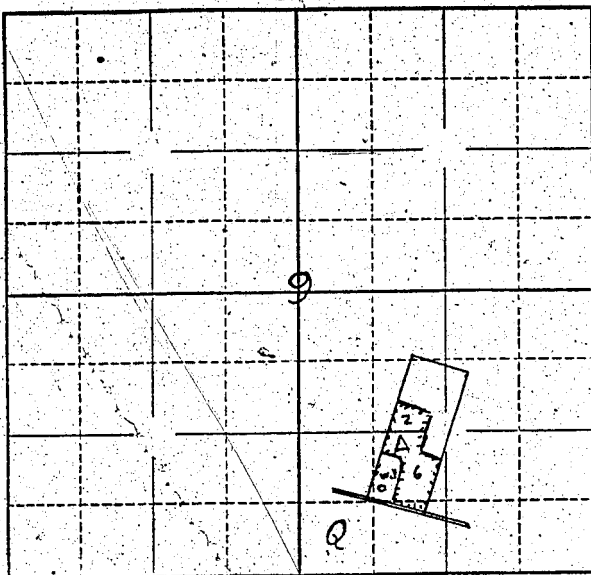

Locate well and acreage of irrigated land on plat.

Scale:  $\frac{1}{2}$  - 1 Mile

STATE OF OREGON

County of Marion

I, Walter J. Schendel, being first duly sworn, do hereby certify that I have read the foregoing Registration Statement and that all of the items therein contained are true to the best of my knowledge and belief.

Walter J. Schendel  
(Signature of Registrant)

Subscribed and sworn to before me this 15th day of July, 19 58

My commission expires 12th June 1961 Wm. S. Bartholomew  
(Notary Public)

(SEAL)

**CERTIFICATE OF REGISTRATION**

STATE OF OREGON }  
County of Marion } ss.

This is to certify that the foregoing Registration Statement was received in the office of the State Engineer on the 15th day of July, 19 58, at 11:00 o'clock A.M. and has been duly recorded in said office in Book No. 9 of Registration Statements on page GR-2075

Witness my hand this 16th day of February, 19 59

Lewis A. Stanley  
(State Engineer)

By \_\_\_\_\_  
(Deputy)

GR-2075

#1500