

Registration Statement

OF CLAIMANT OF RIGHT TO APPROPRIATE GROUND WATER

TO THE STATE ENGINEER OF OREGON:

I, Trappist Abbey of Our Lady of the Lake
of Lafayette County of Marshall
(Mailing address)

State of Oregon, do hereby make application for a certificate of registration as evidence of a right to appropriate ground water.

1. Source from which water is withdrawn is pump well #4
(Flowing well, pump well, infiltration trench, or tunnel)
2. Location is: 3 miles north of Lafayette
(Approximate distance and direction from nearest city or town)

and is more particularly described as follows:

(a) 1269 feet North and 989 feet East of SW corner of Section 20
(Give distance and bearing to corner of section or other legal subdivision)
being within NE 1/4 SW 1/4 of the 21 of Sec. 20, Twp. 3 S, Rge. 1 E
(Smallest legal subdivision) (N. or S.) (E. or W.)

or (b) within limits of recorded platted property, town or city:
in Lot _____, Block _____ of _____
(Name of plat or addition)
County of Marshall
(If within city or town, give name)

3. Construction Work was begun on unknown; was completed on unknown
(Date) (Date)
and the ground water claimed was first used for the purposes set out below on Mar 1955
(Date)
since which time the water has been used intermittently
(Continuously or intermittently)
from Mar 1955 to Jul 1958
(Date) (Date)

4. Quantity of water claimed and used is 28 gallons per minute; 2.2 acre feet per year.

5. Purpose or Purposes for which water is used Irrigation and institutional domestic use
(Domestic, irrigation, municipal, manufacturing, industrial, etc.)

6. Description of Well: Depth 108 feet. Type drilled
(Dug or drilled)
diameter 3 1/2 inches. Elevation of ground at well site 360 feet, mean sea-level.
(As near as known)
Depth to water table 211 feet.

7. Capacity of Well: 28 g.p.m. with 0 feet drawdown.
_____ g.p.m. with _____ feet drawdown.
Date of test 1957

If Flowing Well: Measured discharge _____ g.p.m. on _____
(Date)

Shut-in pressure at ground surface _____ lbs. per sq. in. on _____
(Date)

Water is controlled by _____
(Cap, valve, etc.)

Township 35 Range 3W, W.M.
North

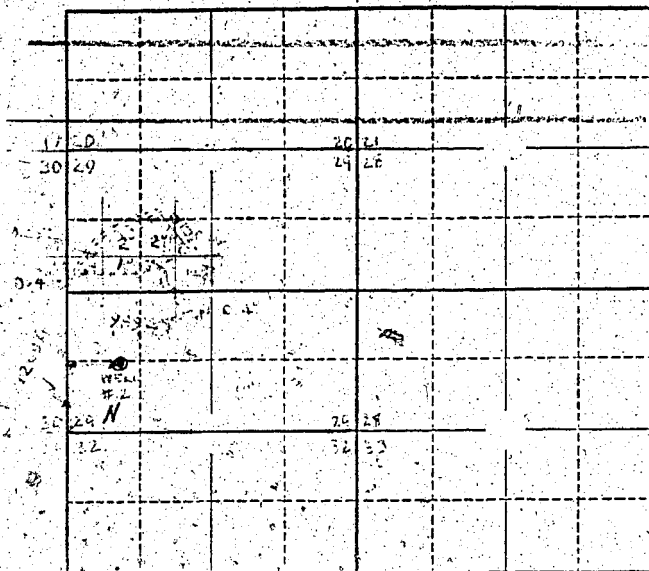

Locate well and acreage of irrigated land on plat.

Scale: 2" = 1 Mile

STATE OF OREGON

County of Franklin } ss.

I, Franklin Miller, being first duly sworn, do hereby certify that I have read the foregoing Registration Statement and that all of the items therein contained are true to the best of my knowledge and belief.

Franklin Miller
(Signature of Registrant)

Subscribed and sworn to before me this 15th day of July, 1958.

My commission expires 11-2-59

Wm. Thomas Spencer
(Notary Public)

(SEAL)

CERTIFICATE OF REGISTRATION

STATE OF OREGON } ss.

County of Marion

This is to certify that the foregoing Registration Statement was received in the office of the State Engineer on the 15th day of July, 1958, at 3:30 o'clock P.M. and has been duly recorded in said office in Book No. 9 of Registration Statements on page GR 2081.

Witness my hand this 16th day of February, 1959.

Wm. Thomas Spencer
(State Engineer)

By _____

(Deputy)

GR - 2081