

STATE ENGINEER

Registration Statement

OF CLAIMANT OF RIGHT TO APPROPRIATE GROUND WATER

TO THE STATE ENGINEER OF OREGON:

I, Clarence Backer

of Route 3, Junction City County of Benton
(Mailing address)

State of Oregon, do hereby make application for a certificate of registration as evidence of a right to appropriate ground water.

1. Source from which water is withdrawn is pump well
(Flowing well, pump well, infiltration trench, or tunnel)

2. Location is: 4 miles NE of Monroe
(Approximate distance and direction from nearest city or town)

and is more particularly described as follows: S 300' hence W 33.0 chains to SW corner of property

(a) said corner within the NW 1/4 Sec 22, T 14S, R 5W, said well
(Give distance and bearing to corner of section or other legal subdivision)

being within NW 1/4 Sec 22 of Sec. 22, Twp. 14S, Rge. 5W
(Smallest legal subdivision) (N. or S.) (E. or W.)

or (b) within limits of recorded platted property, town or city:

in Lot _____, Block _____ of _____
(Name of plat or addition)
County of _____
(If within city or town, give name)

3. Construction Work was begun on 1953; was completed on 1953
(Date) (Date)

and the ground water claimed was first used for the purposes set out below on 1953
(Date)

since which time the water has been used: continuously
(Continuously or intermittently)

from 1953 to 1958
(Date) (Date)

4. Quantity of water claimed and used is 230 when pumping 102 gallons per minute; 102 acre feet per year.

5. Purpose or Purposes for which water is used irrigation

(Domestic, irrigation, municipal, manufacturing, industrial, etc.)

6. Description of Well: Depth 20 feet. Type driven
(Dug or drilled)

diameter 4 inches. Elevation of ground at well site 276 feet, mean sea level.
(As near as known)

Depth to water table 14 feet.

7. Capacity of Well: 230 or more g.p.m. with suck directly from casing feet drawdown.

_____ g.p.m. with _____ feet drawdown.

Date of test 1953

If Flowing Well: Measured discharge _____ g.p.m. on _____
(Date)

Shut-in pressure at ground surface _____ lbs. per sq. in. on _____
(Date)

Water is controlled by _____
(Cap, valve, etc.)

Township 14S Range 5W, W.M.
North

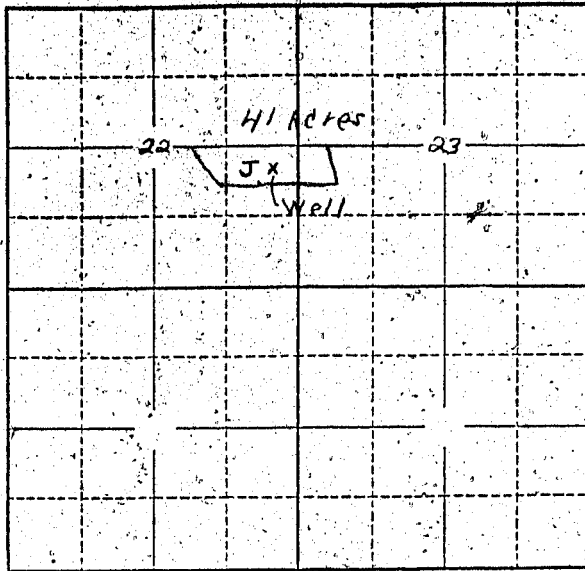

Locate well and acreage of irrigated land on plat.
Scale: 2" = 1 Mile

STATE OF OREGON

County of Benton } ss.

I, Clarence Becker being first duly sworn, do hereby certify that I have read the foregoing Registration Statement and that all of the items therein contained are true to the best of my knowledge and belief.

Clarence Becker
(Signature of Registrant)

Subscribed and sworn to before me this 9th day of March, 1959

My commission expires Dec 11 1959 H. Turner
(Notary Public) for Oregon

(SEAL)

CERTIFICATE OF REGISTRATION

STATE OF OREGON

County of Marion } ss.

This is to certify that the foregoing Registration Statement was received in the office of the State Engineer on the 16th day of July, 1958, at 8:00 o'clock A.M. and has been duly recorded in said office in Book No. 11 of Registration Statements on page GR-2421

Witness my hand this 16th day of March, 1959

Lewis A. Pittman
(State Engineer)

By _____
(Deputy)

\$16.65

GR-2421