

Registration Statement

OF CLAIMANT OF RIGHT TO APPROPRIATE GROUND WATER

TO THE STATE ENGINEER OF OREGON:

I, Phil E. Morrill and Mary E. Morrill

of 4755 S.E. 104th Ave County of Multnomah
(Mailing address)

State of Oregon, do hereby make application for a certificate of registration as evidence of a right to appropriate ground water.

1. Source from which water is withdrawn is Pump Well
(Flowing well, pump well, infiltration trench, or tunnel)

2. Location is: 7 miles E. S. of Portland
(Approximate distance and direction from nearest city or town)

and is more particularly described as follows:

(a) 870 ft. S. and 350 ft. E. of NW corner of Sec. 15
(Give distance and bearing to corner of section or other legal subdivision)

being within NW 1/4 of NW 1/4 of Sec. 15, Twp. 11 S, Rge. 2-E
(Smallest legal subdivision) (E. or W.)

or (b) within limits of recorded platted property, town or city:

in Lot 22, Block of Delashmatt & Oatmans Little Homes No. 4
(Name of plat or addition)

County of Multnomah
(If within city or town, give name)

3. Construction Work was begun on July, 1941; was completed on July, 1941
(Date) (Date)

and the ground water claimed was first used for the purposes set out below on July, 1941
(Date)

since which time the water has been used each summer.
(Continuously or intermittently)

from May 15 to Oct. 1 each year.
(Date) (Date)

4. Quantity of water claimed and used is 25 gallons per minute; 8 acre feet per year.

5. Purpose or Purposes for which water is used irrigation

(Domestic, irrigation, municipal, manufacturing, industrial, etc.)

6. Description of Well: Depth 115 feet. Type drilled
(Dug or drilled)

diameter 6 inches; Elevation of ground at well site 100' feet, mean sea level.
(As near as known)

Depth to water table 65 feet.

7. Capacity of Well: _____ g.p.m. with _____ feet drawdown.
_____ g.p.m. with _____ feet drawdown. Don't know.

Date of test never tested

If Flowing Well: Measured discharge _____ g.p.m. on _____
(Date)

Shut-in pressure at ground surface _____ lbs. per sq. in. on _____
(Date)

Water is controlled by _____
(Cap. valve, etc.)

8. **Casing:** (Give diameter, commercial specifications and depth below ground surface of each casing size.)

6 inch diameter from 0 to 115 feet
 inch diameter from to feet
 inch diameter from to feet
 inch diameter from to feet

Describe and show depth of shoe, plug, adapter, liner or other details:

9. **Perforated Casings or Screens:**

..... from to
 (Number per foot and size of perforations, or describe screen)
 from to
 from to
 from to 18

10. **Log of Well:** (Describe each stratum or formation clearly, indicate if water bearing, and give thickness and depth as indicated.)

MATERIAL		Thickness (Feet)	Depth to Bottom (Feet)
Gravel		68	68
Clay		12	80
Quicksand	Water	15	95
Gravel	Water	20	115

If log of well is not available, give name and address of driller.

11. Infiltration Trench: Covered or open

Dimensions: Length ft. Minimum depth ft. Maximum depth ft.

Bottom width ft. Discharge g.p.m. Date of test

12. Tunnel: Type of lining

Dimensions:
(Length, course, and cross sectional size)

Position of water bearing stratum with reference to portal of tunnel/

Log of tunnel: (Preceding table for log of well may be used, if desired. Give footage from portal and character of materials, as pertinent.)

13. Pumping Equipment:

(a) Pump Kewanee Piston & Rod 3 x 12 Capacity 25 g.p.m.
(Make, type and size)

(b) Motor 2 h.p. induction
(Type and horsepower)

14. Location of area irrigated or to be irrigated, or place of use if for purposes other than irrigation.

Township North or South	Range E. or W. of Willamette Meridian	Section	Forty-acre Tract	Number Acres To Be Irrigated	Date of Reclamation
1-S	2-E	15	NW 1/4 NW 1/4	2.0	July, 1971

15. If the ground water supply is supplemental to an existing water supply, identification of any application for a permit, permit, certificate or adjudicated right to appropriate water made or held by the registrant.

Township 15th Range 20th W.M. North

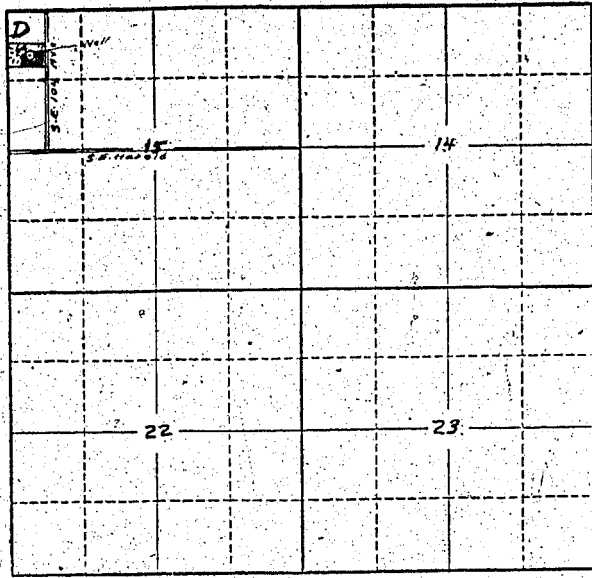

Locate well and acreage of irrigated land on plat.
Scale: 2" = 1 Mile

STATE OF OREGON

County of Multnomah } ss.

I, Mary E. Merrill, being first duly sworn, do hereby certify that I have read the foregoing Registration Statement and that all of the items therein contained are true to the best of my knowledge and belief.

Mary E. Merrill
(Signature of Registrant)

Subscribed and sworn to before me this 15th day of July, 1958

My commission expires Jan. 11, 1961. M. Paul Matthews
(Notary Public)

(SEAL)

CERTIFICATE OF REGISTRATION

STATE OF OREGON

County of Marion } ss.

This is to certify that the foregoing Registration Statement was received in the office of the State Engineer on the 16th day of July, 1958, at 2:00 o'clock A.M. and has been duly recorded in said office in Book No. 9 of Registration Statements on page GR-2094

Witness my hand this 16th day of February, 1959

Lewis A. Stanley
(State Engineer)

By _____
(Deputy)

\$1500.

GR - 2094