

Registration Statement

OF CLAIMANT OF RIGHT TO APPROPRIATE GROUND WATER

TO THE STATE ENGINEER OF OREGON:

I, Wm. P. Phillips
of 3103 Walker Rd. N.E. Salem County of Marion
(Mailing address)

State of Ore., do hereby make application for a certificate of registration as evidence of a right to appropriate ground water.

- 1. Source from which water is withdrawn is Porous Well
(Flowing well, pump well, infiltration trench, or tunnel)
- 2. Location is: 2 Miles East of Salem, Ore.
(Approximate distance and direction from nearest city or town)

and is more particularly described as follows:

(a) 2300 E & 1400' S from NW Corner Section 17
(Give distance and bearing to corner of section or other legal subdivision)
being within SE 1/4 NW 1/4 of Sec. 17, Twp. 7 S, Rge. 3 W.
(Smallest legal subdivision) (N. or S.) (E. or W.)

or (b) within limits of recorded platted property, town or city:
in Lot _____, Block _____ of _____
(Name of plat or addition)

County of _____
(If within city or town, give name)

- 3. Construction Work was begun on Sept 4-1945; was completed on Sept 17-1945
(Date) (Date)

and the ground water claimed was first used for the purposes set out below on _____
(Date)

since which time the water has been used Continuously
(Continuously or Intermittently)

from Sept 6-1945 to July 17-1958
(Date) (Date)

- 4. Quantity of water claimed and used is 17000-20000 gallons per minute; _____ acre feet per year.

- 5. Purpose or Purposes for which water is used Manufacturing & Domestic
(Domestic, irrigation, municipal, manufacturing, industrial, etc.)

- 6. Description of Well: Depth 25 feet. Type Porous
(Dug or drilled)

diameter 6 inches. Elevation of ground at well site 2000 feet, mean sea level.
(As near as known)

Depth to water table 27 feet.

- 7. Capacity of Well: Manufacturing g.p.m. with _____ feet drawdown.
_____ g.p.m. with _____ feet drawdown.

Date of test _____

If Flowing Well: Measured discharge _____ g.p.m. on _____
(Date)

Shut-in pressure at ground surface _____ lbs. per sq. in. on _____
(Date)

Water is controlled by _____
(Cap, valve, etc.)

If log of well is not available, give name and address of driller. unknown

11. Infiltration Trench: Covered or open

Dimensions: Length _____ ft. Minimum depth _____ ft. Maximum depth _____ ft.

Bottom width _____ ft. Discharge _____ g.p.m. Date of test _____

12. Tunnel: Type of lining

Dimensions: _____
(Length, course, and cross sectional size)

Position of water bearing stratum with reference to portal of tunnel _____

Log of tunnel: (Preceding table for log of well may be used, if desired. Give footage from portal and character of materials, as pertinent.)

13. Pumping Equipment:

(a) Pump F.M. Jet (Make, type and size) Capacity 30 g.p.m.

(b) Motor Electric 1/2 (Type and horsepower)

14. Location of area irrigated or to be irrigated, or place of use if for purposes other than irrigation.

Township North or South	Range E. or W. of Willamette Meridian	Section	Forty-acre Tract	Number Acres To Be Irrigated	Date of Reclamation
<u>7 South</u>	<u>2 West</u>	<u>17</u>	<u>SE 1/4 NW 1/4 44 1/2 45 1/2</u>	<u>6</u>	<u>1948</u>

husband and wife

Description of the tract of land the title to which is insured by this policy.

Beginning at an iron pipe in the center line of the County Road which is on the East line of the William J. Herrea Donation Land Claim No. 48 in Township 7 South, Range 2 West of the Willamette Meridian, Marion County, Oregon, said iron pipe being the Northeast corner of that certain tract of land conveyed to Thomas E. Walker by deed recorded in Volume 110, Page 98, Record of Deeds for Marion County, Oregon; thence running North 8° 50' East along the above-mentioned line 304.17 feet to a point; thence North 89° 19' West 735.18 feet to a point; thence South 42° 58' West, a distance of 28.18 feet to a T-iron; thence South 49° 59' West a distance of 252.57 feet to a T-iron; thence South 25° 25' West a distance of 127.23 feet to a T-iron; thence South 89° 19' East, a distance of 955.75 feet to the place of beginning.

15. If the ground water supply is supplemental to an existing water supply, identification of any application for a permit, permit, certificate or adjudicated right to appropriate water made or held by the registrant.

None

Township 7S Range 2W, W.M.
North

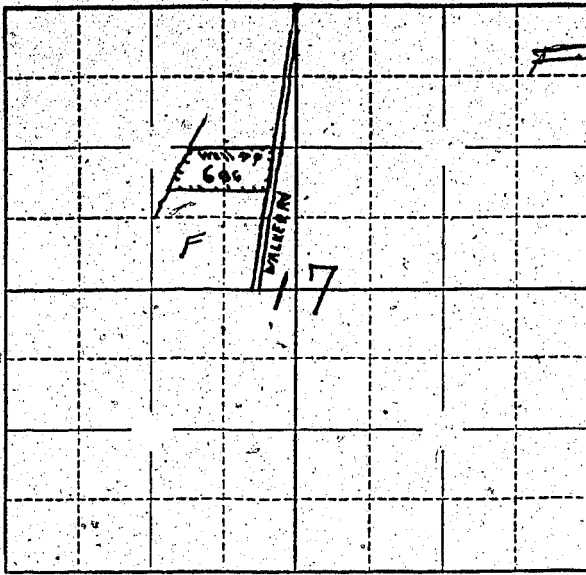

Locate well and acreage of irrigated land on plat.

Scale: 2" = 1 Mile

4"

STATE OF OREGON

County of Marion

} ss.

I, Wm. P. Phillips, being first duly sworn, do hereby certify that I have read the foregoing Registration Statement and that all of the items therein contained are true to the best of my knowledge and belief.

Wm. P. Phillips
(Signature of Registrant)

Subscribed and sworn to before me this 17th day of July, 1958.

My commission expires 12th June 1961

Wm. S. Bartholomew
(Notary Public)

(SEAL)

CERTIFICATE OF REGISTRATION

STATE OF OREGON

County of Marion

} ss.

This is to certify that the foregoing Registration Statement was received in the office of the State Engineer on the 17th day of July, 1958, at 11:20 o'clock A. M. and has been duly recorded in said office in Book No. 9 of Registration Statements on page GR-2133.

Witness my hand this 10th day of March, 1959.

Lewis A. Stanley
(State Engineer)

By

(Deputy)

4/15.00

GR-2133