

RECEIVED
JUN 4 1956
STATE ENGINEER
SALEM, OREGON

REGISTRATION NO. GR-223
CERTIFICATE NO. GR-207

Registration Statement

OF CLAIMANT OF RIGHT TO APPROPRIATE GROUND WATER

(Under Chapter 708, Oregon Laws 1955.)

TO THE STATE ENGINEER OF OREGON:

I, Robert C. Sipe AND Blanche H. Sipe, husband and wife

of 811 Washington St., Albany, County of Lim

State of Oregon, do hereby make application for a certificate of registration as evidence of a right to appropriate ground water.

1. Source from which water is withdrawn is pump well, augmented by infiltration gravel
(Flowing well, pump well, infiltration trench, or tunnel)

2. Location is: Approx. 2 miles SE of Lebanon, Oregon
(Approximate distance and direction from nearest city or town)

and is more particularly described on property NW 1/4 of NW 1/4 --- 0.2 acres
SW 1/4 of NW 1/4 --- 30.0 "
(a) N 35° 45' E 21 chains from SW cor SE 1/4 of NW 1/4 --- 2.1 "
(Give distance and bearing to corner of section or other legal subdivision)

being within SW 1/4 of the NW 1/4 of Sec. 19, Twp. 12 S, Rge. 1W
(Smallest legal subdivision) (N. or S.) (E. or W.)

or (b) within limits of recorded platted property, town or city:

in Lot _____, Block _____ of _____
(Name of plat or addition)

County of _____
(If within city or town, give name)

3. Construction Work was begun on 3-10-1952; was completed on 3-20-1952
(Date) (Date)

and the ground water claimed was first used for the purposes set out below on 4-12-1952
(Date)

since which time the water has been used for irrigation
(Continuously or Intermittently)

from 4-15-1952 to 8-15-1955
(Date) (Date)

4. Quantity of water claimed and used is 245 max. gallons per minute; 1 1/2 acre feet per year.

5. Purpose or Purposes for which water is used Supplemental irrigation now and continuing, but ultimately for domestic use if and when area sub-division is made.
(Domestic, irrigation, municipal, manufacturing, industrial, etc.)

5. Description of Well: Depth 23 feet. Type drilled
(Dug or drilled)

diameter 8 inches. Elevation of ground at well site 223 feet, mean sea level.
(As near as known)

Depth to water table 34 feet, varying with seasonal water table.

7. Capacity of Well: 245 g.p.m. with 7 feet drawdown. at April 12, 1952

180 g.p.m. with 7 feet drawdown. at Aug. 25, 1952

Date of test 4/12 and 8/25, 1952

If Flowing Well: Measured discharge _____ g.p.m. on _____
(Date)

Shut-in pressure at ground surface _____ lbs. per sq. in. on _____
(Date)

Water is controlled by _____
(Cap, valve, etc.)

8. Casing: (Give diameter, commercial specifications and depth below ground surface of each casing size.)

8 inch diameter from surface to 23 feet

..... inch diameter from to feet

..... inch diameter from to feet

..... inch diameter from to feet

Describe and show depth of shoe, plug, adapter, liner or other details: No. na

.....

9. Perforated Casings or Screens:

12 per foot, 3/8" x 32 ea. from 18' to 23'

(Number per foot and size of perforations, or describe screen)

..... from to

..... from to

..... from to

10. Log of Well: (Describe each stratum or formation clearly, indicate if water bearing, and give thickness and depth as indicated.)

MATERIAL	Thickness (Feet)	Depth to Bottom (Feet)
Sand -- entire depth to bedrock		
(Excavation was made around casing to a 16 foot level, and cavity filled with gravel)		

If log of well is not available, give name and address of driller:

Art Clinton, Independence, Oregon

11. Infiltration Trench: Covered or open

Dimensions: Length ft. Minimum depth ft. Maximum depth ft.

Bottom width ft. Discharge g.p.m. Date of test

12. Tunnel: Type of lining

Dimensions: (Length, course, and cross sectional size)

Position of water bearing stratum with reference to portal of tunnel

Log of tunnel: (Preceding table for log of well may be used, if desired. Give footage from portal and character of materials, as pertinent.)

13. Pumping Equipment:

(a) Pump Gould "Close coupled" 3" x 1" Capacity 275 g.p.m.
(Make, type and size)

(b) Motor West, 15 hp, three phase
(Type and horsepower)

14. Location of area irrigated or to be irrigated, or place of use if for purposes other than irrigation.

Township North or South	Range E. or W. of Willamette Meridian	Section	Forty-acre Tract	Number Acres To Be Irrigated	Date of Reclamation
T12S	R1W	19	See data below	32.3	Feb. 1952
See data below under "2-- Location"					
T12S	R1W	19	NW 1/4 of the NW 1/4	0.2	Feb. 1952
"	"	"	SW 1/4 of the NW 1/4	30.0	"
"	"	"	SE 1/4 of the NW 1/4	2.1	"
				32.3	

15. If the ground water supply is supplemental to an existing water supply, identification of any application for a permit, permit, certificate or adjudicated right to appropriate water made or held by the registrant.

Application No. 27010-- Permit # 21214

GR-207B

Township 12 S. Range 1 W., W.M.
North

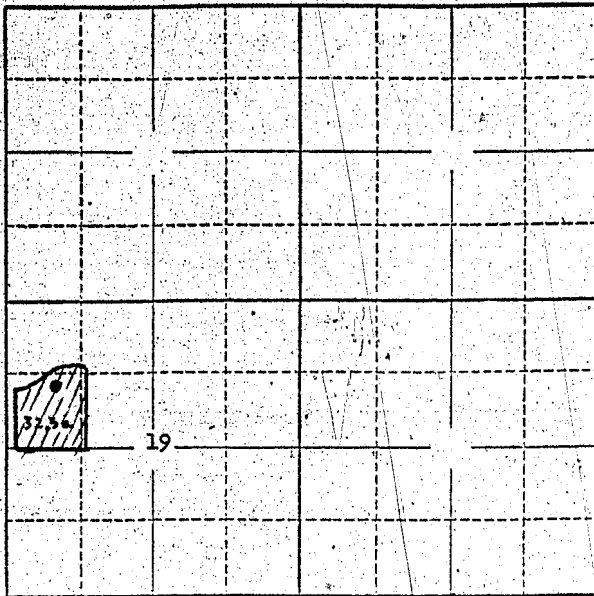

Locate well and acreage of irrigated land on plat.
Scale: 2" = 1 Mile

STATE OF OREGON

County of Lin

ss.

I, Robert C. Sipe, being first duly sworn, do hereby certify that I have read the foregoing Registration Statement and that all of the items therein contained are true to the best of my knowledge and belief.

Robert C. Sipe
(Signature of Registrant)

Subscribed and sworn to before me this 1 day of June, 1956.

My commission expires June 21 1958

William H. Sipe
(Notary Public)

(SEAL)

CERTIFICATE OF REGISTRATION

STATE OF OREGON

County of Marion

ss.

This is to certify that the foregoing Registration Statement was received in the office of the State Engineer on the 7th day of August, 1956, at 10 o'clock A.M. and has been duly recorded in said office in Book No. 2 of Registration Statements on page GR-207 C

~~Construction has been completed by X-X-X-X-X-X-X-X-X-X-X-X-X-X-X-X and the water completely applied to beneficial use by X-X-X-X-X-X-X-X-X-X-X-X~~

Witness my hand this 23rd day of November, 1956.

Laura A. Atkinson
(State Engineer)

By _____
(Deputy)

GR-207C