

STATE ENGINEER
SALEM, OREGON

Registration Statement

OF CLAIMANT OF RIGHT TO APPROPRIATE GROUND WATER

TO THE STATE ENGINEER OF OREGON:

I, Ralph P. Lile or Jet Lile

of Milton Freewater, R.# 2. County of Umatilla
(Mailing address)

State of Oregon do hereby make application for a certificate of registration as evidence of a right to appropriate ground water.

1. Source from which water is withdrawn is Pump well
(Flowing well, pump well, infiltration trench, or tunnel)
2. Location is: 6 miles Northwest. Milton-Freewater, ORE.
(Approximate distance and direction from nearest city or town)

and is more particularly described as follows:

SW 1/4 of SE 1/4 of Sec. 20, Twp. 26 N. R. 35 E.
SW 1/4 of SE 1/4 of the SE 1/4 of Sec. 20, Twp. 26 N., Rge. 35 E.
(Smallest legal subdivision) (N. or S.) (E. or W.)

or (b) within limits of recorded platted property, town or city:

in Lot _____, Block _____ of _____
(Name of plat or addition)
County of Umatilla
(If within city or town, give name)

3. Construction Work was begun on Feb. 1912; was completed on June 1 1912
(Date) (Date)

and the ground water claimed was first used for the purposes set out below on June 1 1912
(Date)

since which time the water has been used Continuously XX (a few years not used)
(Continuously or intermittently)

from June 1912 to Sept. 1957.
(Date) (Date)

4. Quantity of water claimed and used is 110 gallons per minute; about 60 acre feet per year.

5. Purpose or Purposes for which water is used Irrigation.

(Domestic, irrigation, municipal, manufacturing, industrial, etc.)

6. Description of Well: Depth 65 feet. Type Dug 40 ft. drilled 25 ft.
(Dug or drilled)

diameter 8 inches. Elevation of ground at well site 600 feet, mean sea level.
(As near as known)

Depth to water table 35 feet.

7. Capacity of Well: unknown g.p.m. with 60 feet drawdown.

_____ g.p.m. with _____ feet drawdown.

Date of test not tested as known

If Flowing Well: Measured discharge _____ g.p.m. on _____
(Date)

Shut-in pressure at ground surface _____ lbs. per sq. in. on _____
(Date)

Water is controlled by _____
(Cap, valve, etc.)

Township 6 N Range 35 E, W.M.
North

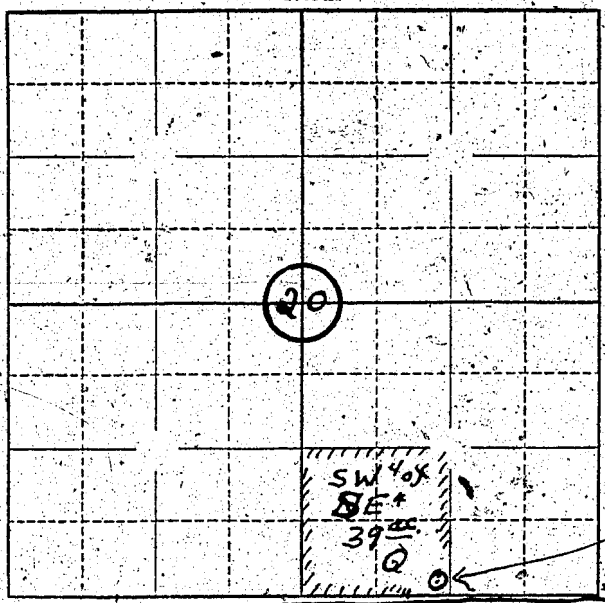

Well located
70' N. from apt
32' W. from SE cor.
of SW 40x SE 4
Sec. 20, T. 6 N. R. 35 E

Road Locate well and acreage of irrigated land on plat.

Scale: 1" = 1 Mile
4" = 1 Mile

STATE OF OREGON

County of Union } ss.

I, John J. Kelly, being first duly sworn, do hereby certify that I have read the foregoing Registration Statement and that all of the items therein contained are true to the best of my knowledge and belief.

(Signature of Registrant)

Subscribed and sworn to before me this 16th day of July, 1958.

My commission expires July 11, 1959
(Notary Public)

(SEAL)

CERTIFICATE OF REGISTRATION

STATE OF OREGON

County of Marion } ss.

This is to certify that the foregoing Registration Statement was received in the office of the State Engineer on the 17th day of July, 1958, at 9:00 o'clock A. M. and has been duly recorded in said office in Book No. 16 of Registration Statements on page GR-3861

Witness my hand this 28th day of December, 1959.

Laura A. Straley
(State Engineer)

By _____
(Deputy)

#16.35