

# Registration Statement

## OF CLAIMANT OF RIGHT TO APPROPRIATE GROUND WATER

TO THE STATE ENGINEER OF OREGON:

I, Edward Bakke  
of Rt 2 Box 98 Dallas County of Polk  
(Mailing address)

State of Oregon, do hereby make application for a certificate of registration as evidence of a right to appropriate ground water.

- 1. Source from which water is withdrawn is Pump well  
(Flowing well, pump well, infiltration trench, or tunnel)
- 2. Location is: E. 1 1/4 S. 1/2 mi from Falls City  
(Approximate distance and direction from nearest city or town)

and is more particularly described as follows:

(a) 660' N & 335' W from center section 22  
(Give distance and bearing to corner of section or other legal subdivision)  
being within SE 1/4 NW 1/4 of Sec. 22, Twp. 8, Rge. 6 W  
(Smallest legal subdivision) (N. or S.) (E. or W.)

or (b) within limits of recorded platted property, town or city:  
in Lot \_\_\_\_\_, Block \_\_\_\_\_ of \_\_\_\_\_  
(Name of plat or addition)

(If within city or town, give name) County of Polk

3. Construction Work was begun on September 15, was completed on Oct 15 - 1951  
(Date) (Date)  
and the ground water claimed was first used for the purposes set out below on Nov 1 - 1951  
(Date)  
since which time the water has been used Continuously  
(Continuously or intermittently)  
from May to September  
(Date) (Date)

4. Quantity of water claimed and used is 100 gallons per minute; \_\_\_\_\_ acre feet per year.

5. Purpose or Purposes for which water is used Domestic and irrigation  
(Domestic, irrigation, municipal, manufacturing, industrial, etc.)

6. Description of Well: Depth 79 feet. Type Drilled  
(Dug or drilled)  
diameter 6 inches. Elevation of ground at well site \_\_\_\_\_ feet, mean sea level.  
(As near as known)  
Depth to water table \_\_\_\_\_ feet.

7. Capacity of Well: 100 g.p.m. with \_\_\_\_\_ feet drawdown.  
\_\_\_\_\_ g.p.m. with \_\_\_\_\_ feet drawdown.

Date of test \_\_\_\_\_

If Flowing Well: Measured discharge \_\_\_\_\_ g.p.m. on \_\_\_\_\_  
(Date)

Shut-in pressure at ground surface \_\_\_\_\_ lbs. per sq. in. on \_\_\_\_\_  
(Date)

Water is controlled by \_\_\_\_\_  
(Cap, valve, etc.)





Section 22

Township 8S Range 6W, W.M.  
North

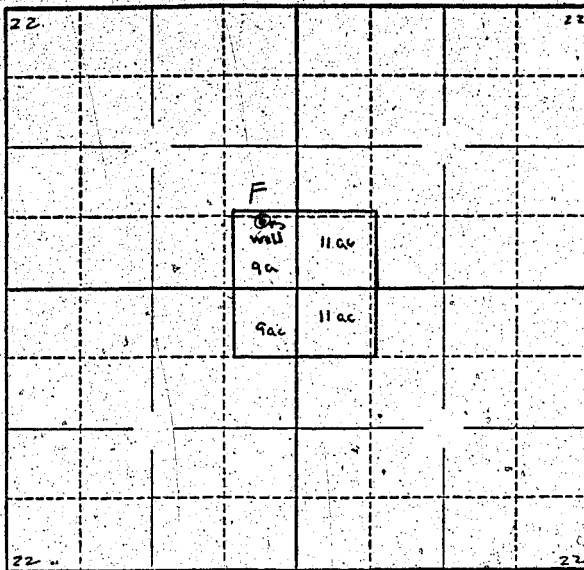

Locate well and acreage of irrigated land on plat.

Scale:  $\frac{2}{4}$ " = 1 Mile

STATE OF OREGON

County of Marion } ss.

I, \_\_\_\_\_, being first duly sworn, do hereby certify that I have read the foregoing Registration Statement and that all of the items therein contained are true to the best of my knowledge and belief.

Edward Bakke  
(Signature of Registrant)

Subscribed and sworn to before me this 17th day of July, 1958.

My commission expires 17th June 1961 Wm. S. Bartholomew  
(Notary Public)

(SEAL)

CERTIFICATE OF REGISTRATION

STATE OF OREGON

County of Marion } ss.

This is to certify that the foregoing Registration Statement was received in the office of the State Engineer on the 17th day of July, 1958, at 3:00 o'clock P. M. and has been duly recorded in said office in Book No. 10 of Registration Statements on page GR 2158.

Witness my hand this 10th day of March, 1959

Clara A. Stanley  
(State Engineer)

By \_\_\_\_\_ (Deputy)

GR - 2158

\$16.50