

RECEIVED  
JUL 14 1958

Registration No. GR 2267

Certificate No. GR 4006

### Registration Statement

STATE ENGINEER  
SALENS OREGON

RECEIVED  
MAR 3 1950

### OF CLAIMANT OF RIGHT TO APPROPRIATE GROUND WATER

STATE ENGINEER  
SALENS OREGON

TO THE STATE ENGINEER OF OREGON:

I, Croval Ingram

of 6134 Table Rock Rd, Central Point County of Jackson  
(Mailing address)

State of Oregon, do hereby make application for a certificate of registration as evidence of a right to appropriate ground water.

1. Source from which water is withdrawn is Pump well  
(Flowing well, pump well, infiltration trench, or tunnel)

2. Location is: 4 miles North of Medford ore on the Table Rock Rd  
(Approximate distance and direction from nearest city or town)

and is more particularly described as follows:

(a) 767 feet North and 111 feet East from the S/4 cor. Sec. 25  
(Give distance and bearing to corner of section or other legal subdivision)

being within NW/4 of SW/4 of SE/4 of Sec. 25, Twp. 36 S., Rge. 2 W., W.M.  
(Smallest legal subdivision) (N. or S.) (E. or W.)

or (b) within limits of recorded platted property, town or city:

in Lot \_\_\_\_\_, Block \_\_\_\_\_ of \_\_\_\_\_  
(Name of plat or addition)

County of Jackson  
(If within city or town, give name)

3. Construction Work was begun on Sept 1953; was completed on Oct 1, 1953  
(Date) (Date)

and the ground water claimed was first used for the purposes set out below on \_\_\_\_\_  
(Date)

since which time the water has been used Continuously  
(Continuously or intermittently)

from Oct 1, 1953 to June 28, 1958  
(Date) (Date)

4. Quantity of water claimed and used is 17 gallons per minute; 9.0 acre feet per year.  
(except)

5. Purpose or Purposes for which water is used Irrigation  
(Irrigation, municipal, manufacturing, industrial, etc.)

6. Description of Well: Depth 32 feet. Type drilled  
(Dug or drilled)

diameter 6 inches. Elevation of ground at well site 1265 feet, mean sea level.  
(As near as known)

Depth to water table 25 feet.

7. Capacity of Well: Not known g.p.m. with \_\_\_\_\_ feet drawdown.

\_\_\_\_\_ g.p.m. with \_\_\_\_\_ feet drawdown.

Date of test None

If Flowing Well: Measured discharge None g.p.m. on \_\_\_\_\_  
(Date)

Shut-in pressure at ground surface \_\_\_\_\_ lbs. per sq. in. on \_\_\_\_\_  
(Date)

Water is controlled by \_\_\_\_\_  
(Cap, valve, etc.)

(Note: All lettering in black ink is by D.C. Hendrix - 2-29-60 P.L.H.)





Township 36 S. Range 2 W. W.M.

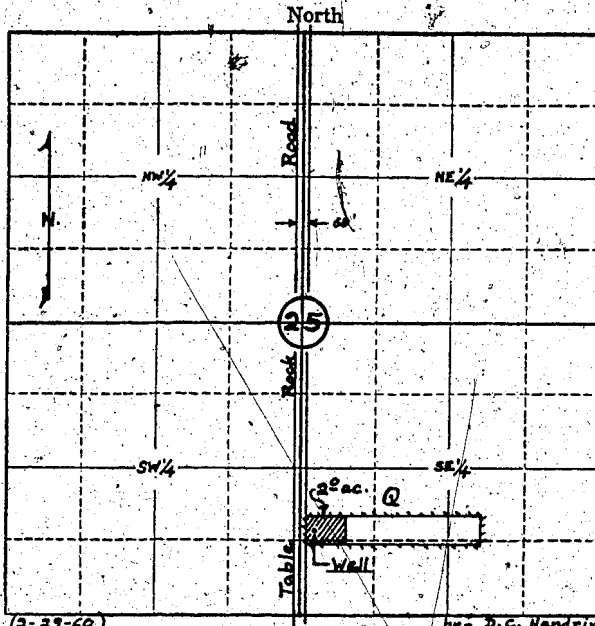

Locate well and acreage of irrigated land on plat. by D. C. Hendrix

Scale: 4" = 1 Mile

STATE OF OREGON

County of Jackson ss.

I, Orval Ingram, being first duly sworn, do hereby certify that I have read the foregoing Registration Statement and that all of the items therein contained are true to the best of my knowledge and belief.

Orval Ingram  
(Signature of Registrant)

Subscribed and sworn to before me this 12th day of July, 1955

My commission expires Jan. 8, 1962 Arnette E. Tholl  
(Notary Public)

(SEAL)

**CERTIFICATE OF REGISTRATION**

STATE OF OREGON }  
County of Marion } ss.

This is to certify that the foregoing Registration Statement was received in the office of the State Engineer on the 14th day of July, 1958, at 8:00 o'clock A. M. and has been duly recorded in said office in Book No. 16 of Registration Statements on page GR 4006

Witness my hand this 15th day of March, 1960

W. A. Stoney  
(State Engineer)

By \_\_\_\_\_  
(Deputy)

\$15.00

GR 4006