

Registration No. GR - 2299

Certificate No. GR - 2194

Registration Statement

OF CLAIMANT OF RIGHT TO APPROPRIATE GROUND WATER

TO THE STATE ENGINEER OF OREGON:

I, Lyle Bowers

of Route 1, Box W 48, Lebanon County of Linn
(Mailing address)

State of Oregon, do hereby make application for a certificate of registration as evidence of a right to appropriate ground water.

1. Source from which water is withdrawn is pump well
(Flowing well, pump well, infiltration trench, or tunnel)

2. Location is: Adjoining Waterloo, Oregon
(Approximate distance and direction from nearest city or town)

and is more particularly described as follows:

(a) N. 71° E. 16 chains from NE corner of DLC 40
(Give distance and bearing to corner of section or other legal subdivision)

being within SW $\frac{1}{4}$ of SW $\frac{1}{4}$ of Sec. 28, Twp. 12 S, Rge. 1 W
(Smallest legal subdivision) (N. or S.) (E. or W.)

or (b) within limits of recorded platted property, town or city:

in Lot _____, Block _____ of _____
(Name of plat or addition)

(If within city or town, give name) County of Linn

3. Construction Work was begun on 1952; was completed on 1952
(Date) (Date)

and the ground water claimed was first used for the purposes set out below on 1952
(Date)

since which time the water has been used Continuously
(Continuously or intermittently)

from 1952 to present time
(Date) (Date)

4. Quantity of water claimed and used is 100 gallons per minute; 23.7 acre feet per year.

5. Purpose or Purposes for which water is used Domestic and irrigation
(Domestic, irrigation, municipal, manufacturing, industrial, etc.)

6. Description of Well: Depth 19 feet. Type dug
(Dug or drilled)

diameter 4 $\frac{1}{2}$ ft. x 5 $\frac{1}{2}$ ft. inches. Elevation of ground at well site 400 feet, mean sea level.
(As near as known)

Depth to water table 7 feet.

7. Capacity of Well: 112 g.p.m. with 5 $\frac{1}{2}$ feet drawdown.
_____ g.p.m. with _____ feet drawdown.

Date of test 1952

If Flowing Well: Measured discharge _____ g.p.m. on _____
(Date)

Shut-in pressure at ground surface _____ lbs. per sq. in. on _____
(Date)

Water is controlled by _____
(Cap, valve, etc.)

8. **Casing:** (Give diameter, commercial specifications and depth below ground surface of each casing size.)

$4\frac{1}{2}$ " x $5\frac{1}{2}$ " inch diameter Wood casing from 0 to 19 feet
inch diameter from to feet
inch diameter from to feet
inch diameter from to feet

Describe and show depth of shoe, plug, adapter, liner or other details: _____

9. **Perforated Casings or Screens:**

Wood casing

(Number per foot and size of perforations, or describe screen)

from to
from to
from to
from to

10. **Log of Well:** (Describe each stratum or formation clearly, indicate if water bearing, and give thickness and depth as indicated.)

MATERIAL	Thickness (Feet)	Depth to Bottom (Feet)
Not available		

If log of well is not available, give name and address of driller. Dug by Lyle Bowers

11. Infiltration Trench: Covered or open

Dimensions: Length ft. Minimum depth ft. Maximum depth ft.
 Bottom width ft. Discharge g.p.m. Date of test

12. Tunnel: Type of lining

Dimensions:
(Length, course, and cross sectional size)
 Position of water bearing stratum with reference to portal of tunnel

Log of tunnel: (Preceding table for log of well may be used, if desired. Give footage from portal and character of materials, as pertinent.)

13. Pumping Equipment:

Myers - Centrifugal 1 1/4" x 3/4" 120
 (a) Pump Wade-Centrifugal 3" x 4" Capacity Unknown g.p.m.
 3/4 H.P. electric (Make, type and size)
 (b) Motor 7 H.P. gas (both pumps on same well)
(Type and horsepower)

14. Location of area irrigated or to be irrigated, or place of use if for purposes other than irrigation.

Township North or South	Range E. or W. of Willamette Meridian	Section	Forty-acre Tract	Number Acres To Be Irrigated	Date of Reclamation
12 S	1 W	28	SW 1/4 of SW 1/4	3.6	1952
12 S	1 W	29	SE 1/4 of SE 1/4	0.3	1952
12 S	1 W	32	NE 1/4 of NE 1/4	0.7	1952
12 S	1 W	33	NW 1/4 of NW 1/4	3.3	1952
				7.9	

do hereby grant, bargain, sell and convey unto the said grantees, their heirs and assigns, all the following real property, with the tenements, hereditaments and appurtenances, situated in the County of Linn and State of Oregon, bounded and described as follows, to-wit:

Beginning at a point in the center line of Klum Street in the town of Waterloo in Linn County, Oregon, said point being S. 46° E. 30 feet from the South corner of Block 51 in said town; thence S. 48° E. 728 feet to the West line of that tract recorded in Book 90, page 122 of Deed Records; thence along the West line of said tract S. 100° 37' E. 19.8 feet and S. 25° 30' E. 274.56 feet to the South line of Elmore Kees D.L.C. 753; thence West along said line 800 feet; thence N. 10° 18' E. 766.7 feet to the place of beginning containing 7.89 acres.

15. If the ground water supply is supplemental to an existing water supply, identification of any application for a permit, permit, certificate or adjudicated right to appropriate water made or held by the registrant.

Township 12 S. Range 1 W., W.M.
North

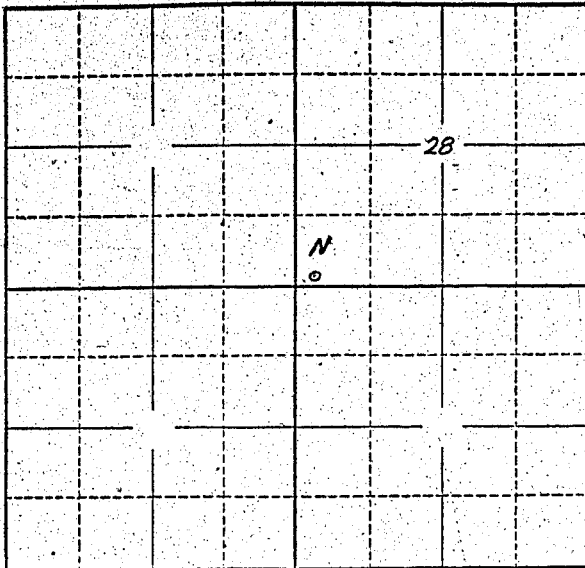

Locate well and acreage of irrigated land on plat.
Scale: 2" = 1 Mile

STATE OF OREGON

County of Linn } ss.

I, Lyle Bowers, being first duly sworn, do hereby certify that I have read the foregoing Registration Statement and that all of the items therein contained are true to the best of my knowledge and belief.

Lyle Bowers
(Signature of Registrant)

Subscribed and sworn to before me this 16 day of July, 1958

My commission expires July 27, 1958 Grant Smith
(Notary Public)

(SEAL)

CERTIFICATE OF REGISTRATION

STATE OF OREGON

County of Marion } ss.

This is to certify that the foregoing Registration Statement was received in the office of the State Engineer on the 18th day of July, 1958, at 2:00 o'clock A.M. and has been duly recorded in said office in Book No. 10 of Registration Statements on page GR-2194

Witness my hand this 10th day of March, 1959

Lewis A. Stanley
(State Engineer)

\$15.00

By _____
(Deputy)