

RECEIVED
AUG 13 1956
STATE ENGINEER
SALEM, OREGON

REGISTRATION NO. GR-223
CERTIFICATE NO. GR-229

Registration Statement

OF CLAIMANT OF RIGHT TO APPROPRIATE GROUND WATER

(Under Chapter 708, Oregon Laws 1955.)

TO THE STATE ENGINEER OF OREGON:

I, L.J. & J.L. Getchell Rt. 2 Box 283

of Creswell County of Lane

State of Oregon, do hereby make application for a certificate of registration as evidence of a right to appropriate ground water.

1. Source from which water is withdrawn is Well #1 (electric pump)
(Flowing well, pump well, infiltration trench, or tunnel)
2. Location is: 3 miles N.E. of Creswell
(Approximate distance and direction from nearest city or town)

and is more particularly described as follows:

(a) Bears N.32° 25' W. 778.6 feet from S.E. Cor. Benj. Despain Cl.
(Give distance and bearing to corner of section or other legal subdivision)

being within S.E. 1/4 S.E. 1/4 of Sec. 7, Twp. 19.S, Rge. 2.W
(Smallest legal subdivision) (N. or S.) (E. or W.)

or (b) within limits of recorded platted property, town or city:

in Lot _____, Block _____ of _____
(Name of plat or addition)

County of _____
(If within city or town, give name)

3. Construction Work was begun on Feb. 20 1953; was completed on March 3 1953
(Date) (Date)

and the ground water claimed was first used for the purposes set out below on April 1st 1953
(Date)

since which time the water has been used continuously each year
(Continuously or intermittently)

from April 15th to October 1st
(Date) (Date)

4. Quantity of water claimed and used is 20 gallons per minute; _____ acre feet per year.

5. Purpose or Purposes for which water is used Irrigation

Pasture and hay
(Domestic, irrigation, municipal, manufacturing, industrial, etc.)

6. Description of Well: Depth 148 feet. Type drilled
(Dug or drilled)

diameter 10 inches. Elevation of ground at well site 450.520 feet, mean sea level.
(As near as known)

Depth to water table not known feet.

7. Capacity of Well: 20 g.p.m. with _____ feet drawdown.

_____ g.p.m. with _____ feet drawdown.

Date of test No test record

If Flowing Well: Measured discharge _____ g.p.m. on _____
(Date)

Shut-in pressure at ground surface _____ lbs. per sq. in. on _____
(Date)

Water is controlled by _____
(Cap, valve, etc.)

8. Casing: (Give diameter, commercial specifications and depth below ground surface of each casing size.)

10 inch diameter from top to bottom feet
 inch diameter from to feet
 inch diameter from to feet
 inch diameter from to feet

Describe and show depth of shoe, plug, adapter, liner or other details:

.....

.....

9. Perforated Casings or Screens:

2 per foot 1/8 in. by 6 in. (23 ft)
(Number per foot and size of perforations, or describe screen) from top to bottom
 from to
 from to
 from to

10. Log of Well: (Describe each stratum or formation clearly, indicate if water bearing, and give thickness and depth as indicated.)

MATERIAL	Thickness (Feet)	Depth to Bottom (Feet)
Top soil	2	
Clay & gravel mixture	20	
sand stone	126	148
The figures in this log are estimated for		
no accurate log was kept.		

If log of well is not available, give name and address of driller: Casy Jones - Well Drilling Co.

Creswell, Ore. Rt. 2

11. Infiltration Trench: Covered or open _____

Dimensions: Length _____ ft. Minimum depth _____ ft. Maximum depth _____ ft.

Bottom width _____ ft. Discharge _____ g.p.m. Date of test _____

12. Tunnel: Type of lining _____

Dimensions: _____
(Length, course, and cross sectional size)

Position of water bearing stratum with reference to portal of tunnel _____

Log of tunnel: (Preceding table for log of well may be used, if desired. Give footage from portal and character of materials, as pertinent.)

13. Pumping Equipment:

(a) Pump 1.5 H.P. Pacific J&T Capacity 20 g.p.m.
(Make, type and size)

(b) Motor _____
(Type and horsepower)

14. Location of area irrigated or to be irrigated, or place of use if for purposes other than irrigation.

Township North or South	Range E. or W. of Willamette Meridian	Section	Forty-acre Tract	Number Acres To Be Irrigated	Date of Reclamation
19.S.	2.W.	7	S.W. 1/4 N.E. 1/4	1.3	4-1-53
19.S.	2.W	7	N.W. 1/4 S.E. 1/4	2.6	"
19.s.	2.W	7	S. 1/2 N.E. 1/4	16.6	"
19.s.	2.W	7	N.E. 1/4 S.E. 1/4	29.1	"
19.S.	2.W	8	N.W. 1/4 S.W. 1/4	7	"
19.S.	2.W	8	S.W. 1/4 N.W. 1/4	.6	"
				50.9	

15. If the ground water supply is supplemental to an existing water supply, identification of any application for a permit, permit, certificate or adjudicated right to appropriate water made or held by the registrant.
Water from BEAR Creek applied for File number 30738

Township 19S Range 2W W.M.
North

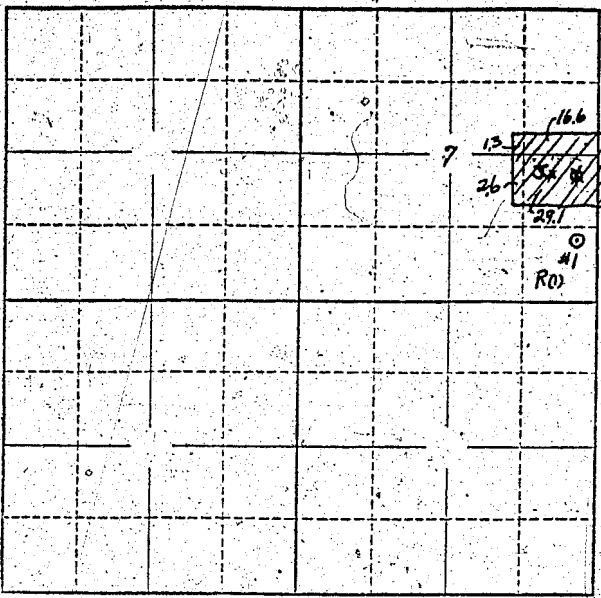

Locate well and acreage of irrigated land on plat.
Scale: 2" = 1 Mile

STATE OF OREGON }
County of Lane } ss.

I, L.J. & J.L. Gatchell, being first duly sworn, do hereby certify that I have read the foregoing Registration Statement and that all of the items therein contained are true to the best of my knowledge and belief.

L.J. Gatchell
(Signature of Registrant)

Subscribed and sworn to before me this _____ day of _____, 19____

My commission expires _____ (Notary Public)

(SEAL)

SEE PAGE GR-229 G FOR
CERTIFICATE OF REGISTRATION

STATE OF OREGON }
County of Marion } ss.

~~This is to certify that the foregoing Registration Statement was received in the office of the State Engineer on the X-X-X-X day of X-X-X-X 19X-X, and has been duly recorded in said office in Book No. X-X-X-X of Registration Statements on page X-X-X-X. Construction thereon was completed by X-X-X-X on X-X-X-X, and the water completely applied to beneficial use by X-X-X-X on X-X-X-X.~~

Witness my hand this _____ day of _____, 19____

(State Engineer)

By _____ (Deputy)

RECEIVED
AUG 13 1956
STATE ENGINEER
SALEM, OREGON

REGISTRATION NO. GR-223

Registration Statement CERTIFICATE NO. GR-229

OF CLAIMANT OF RIGHT TO APPROPRIATE GROUND WATER

(Under Chapter 708, Oregon Laws 1955.)

TO THE STATE ENGINEER OF OREGON:

I, L.L. & J.L. Getchall Rt 2 Box 283
of Creswell County of Lane

State of Oregon, do hereby make application for a certificate of registration as evidence of a right to appropriate ground water.

1. Source from which water is withdrawn is Pump well No. 2
(Flowing well, pump well, infiltration trench, or tunnel)

2. Location is: 3 miles N.E. of Creswell
(Approximate distance and direction from nearest city or town)

and is more particularly described as follows:

(a) Bears N. 13° 15' W. 1849.6 Ft. from said claim No. 52 T. 19S. 2W.
(Give distance and bearing to corner of section or other legal subdivision)

being within N.E. 1/4 S.E. 1/4 of Sec. 7, Twp. 19S, Rge. 2.W.
(Smallest legal subdivision) (N. or S.) (E. or W.)

or (b) within limits of recorded platted property, town or city:

in Lot _____, Block _____ of _____
(Name of plat or addition)
County of _____
(If within city or town, give name)

3. Construction Work was begun on August 5 th; was completed on Sept. 1st 1953
(Date) (Date)

and the ground water claimed was first used for the purposes set out below on Sept. 1 1953
(Date)

since which time the water has been used continuously each year
(Continuously or intermittently)

from April 15th to October 1st.
(Date) (Date)

4. Quantity of water claimed and used is 28 gallons per minute; _____ acre feet per year.

5. Purpose or Purposes for which water is used Irrigation
and to supply a pasture water for stock tank
(Domestic, irrigation, municipal, manufacturing, industrial, etc.)

6. Description of Well: Depth 97 feet. Type drilled
(Dug or drilled)

diameter 8 inches. Elevation of ground at well site 450 520 feet, mean sea level.
(As near as known)

Depth to water table not known feet.

7. Capacity of Well: 28 g.p.m. with _____ feet drawdown.
_____ g.p.m. with _____ feet drawdown.

Date of test No test record

If Flowing Well: Measured discharge _____ g.p.m. on _____
(Date)

Shut-in pressure at ground surface _____ lbs. per sq. in. on _____
(Date)

Water is controlled by _____
(Cap, valve, etc.)

GR-229 D

If log of well is not available, give name and address of driller. Caay Jones Well Drilling Co.

Creswall, Oregon R.2

11. Infiltration Trench: Covered or open _____

Dimensions: Length _____ ft. Minimum depth _____ ft. Maximum depth _____ ft.

Bottom width _____ ft. Discharge _____ g.p.m. Date of test _____

12. Tunnel: Type of lining _____

Dimensions: _____
(Length, course, and cross sectional size)

Position of water bearing stratum with reference to portal of tunnel _____

Log of tunnel: (Preceding table for log of well may be used, if desired. Give footage from portal and character of materials, as pertinent.)

13. Pumping Equipment:

(a) Pump 2.0 H.P. Fairbanks Morse Turbine Capacity 20 g.p.m.
(Make, type and size)

(b) Motor _____
(Type and horsepower)

14. Location of area irrigated or to be irrigated, or place of use if for purposes other than irrigation.

Township North or South	Range E. or W. of Willamette Meridian	Section	Forty-acre Tract	Number Acres To Be Irrigated	Date of Reclamation
19.S	2.W	7	S.W. $\frac{1}{4}$ N.E. $\frac{1}{4}$	1.3	9-1-53
19.S	2.W	7	N.W. $\frac{1}{4}$ S.E. $\frac{1}{4}$	2.6	"
19.S	2.W	7	S.E. $\frac{1}{4}$ N.E. $\frac{1}{4}$	16.6	"
19.S	2.W	7	N.E. $\frac{1}{4}$ S.E. $\frac{1}{4}$	29.1	"
19.S	2.W	8	N.W. $\frac{1}{4}$ S.W. $\frac{1}{4}$.7	"
19.S	2.W	8	S.W. $\frac{1}{4}$ N.W. $\frac{1}{4}$.6	"
				<u>50.9</u>	

15. If the ground water supply is supplemental to an existing water supply, identification of any application for a permit, permit, certificate or adjudicated right to appropriate water made or held by the registrant.

Water from Bear creek applied for. File number 30738

Township 19S Range 2W W.M.
 North

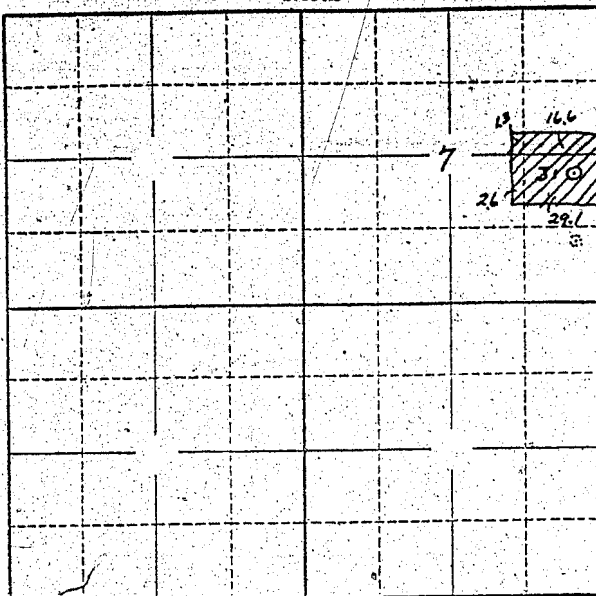

Locate well and acreage of irrigated land on plat.
 Scale: 2" = 1 Mile

STATE OF OREGON

County of Lane } ss.

I, L.J. & J.L. Gatchell, being first duly sworn, do hereby certify that I have read the foregoing Registration Statement and that all of the items therein contained are true to the best of my knowledge and belief.

L.J. & J.L. Gatchell
 (Signature of Registrant)

Subscribed and sworn to before me this 11 day of August, 1956

My commission expires NOTARY PUBLIC FOR OREGON

Robert G. Irwin
 (Notary Public)

My Commission Expires Oct. 16, 1959

(SEAL)

CERTIFICATE OF REGISTRATION

STATE OF OREGON

County of Marion } ss. 1

This is to certify that the foregoing Registration Statement was received in the office of the State Engineer on the 8th day of August, 1956, at 8 o'clock A. M. and has been duly recorded in said office in Book No. 2 of Registration-Statements on page GR-229 G

~~Construction shall be completed by X-X-X-X-X-X-X-X-X-X-X-X-X-X-X-X and the water completely applied to beneficial use by X-X-X-X-X-X-X-X-X-X-X-X-X-X-X-X~~

Witness my hand this 23rd day of November, 1956

Lewis A. Stanley
 (State Engineer)

By _____ (Deputy)