

Registration Statement

OF CLAIMANT OF RIGHT TO APPROPRIATE GROUND WATER

RECEIVED
MAY 2 1952
STATE ENGINEER
MADEIRA, OREGON

TO THE STATE ENGINEER OF OREGON:

LLOYD W. WETHERAM

of Mel Batzd Cottage Grove County of Lane
(Mailing address)

State of Oregon, do hereby make application for a certificate of registration as evidence of a right to appropriate ground water.

1. Source from which water is withdrawn is PUMP ~~WELL~~ SUMP
(Flowing well, pump well, infiltration trench, or tunnel)

2. Location is: 1 mile east and 1/2 mile north of Cottage Grove
(Approximate distance and direction from nearest city or town)

and is more particularly described as follows:

(a) EAST from ~~SW 1/4~~ corner 1775' then south to 30 then east 450'
(Give distance and bearing to section or other legal subdivision)

being within SW 1/4 of NE 1/4 of Sec. 27, Twp. 20S, Rge. 3 W
(Smallest legal subdivision) (N. or S.) (E. or W.)

or (b) within limits of recorded platted property, town or city:

in Lot _____, Block _____ of _____
(Name of plat or addition)

County of _____
(If within city or town, give name)

3. Construction Work was begun on April - 1952; was completed on April - 1952
(Date) (Date)

and the ground water claimed was first used for the purposes set out below on June - 1952
(Date)

since which time the water has been used intermittently
(Continuously or intermittently)
from about June 1 to Sept. 15
(Date) (Date)

4. Quantity of water claimed and used is 160 gallons per minute; 2 acre feet per year.

5. Purpose or Purposes for which water is used IRRIGATION

6. Description of Well: Depth 12 x 16 feet. Type DUG
(Domestic, irrigation, municipal, manufacturing, industrial, etc.) (Dug or drilled)

diameter _____ inches. Elevation of ground at well site _____ feet, mean sea level.
(As near as known)

Depth to water table 4 to 8 feet.

7. Capacity of Well: _____ g.p.m. with _____ feet drawdown.
_____ g.p.m. with _____ feet drawdown.

Date of test _____

If Flowing Well: Measured discharge _____ g.p.m. on _____
(Date)

Shut-in pressure at ground surface _____ lbs. per sq. in. on _____
(Date)

Water is controlled by _____
(Cap, valve, etc.)

Township 205 Range 3 West, W.M.
North

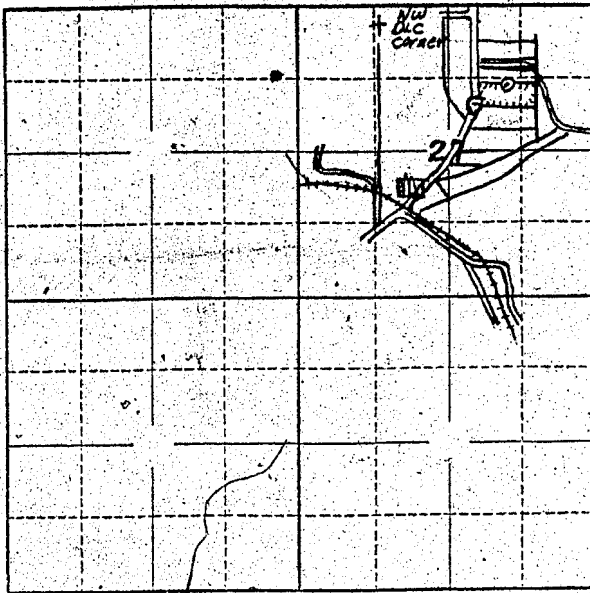

Locate well and acreage of irrigated land on plat.
Scale: 2" = 1 Mile

STATE OF OREGON

County of Lane } ss.

I, Lloyd W. Whitham, being first duly sworn, do hereby certify that I have read the foregoing Registration Statement and that all of the items therein contained are true to the best of my knowledge and belief.

Lloyd W. Whitham
(Signature of Registrant)

Subscribed and sworn to before me this 16 day of July, 19 58

My commission expires Commission Expires 11/1/62 Paul P. Nelson
(Notary Public)

(SEAL)

CERTIFICATE OF REGISTRATION

STATE OF OREGON

County of Marion } ss.

This is to certify that the foregoing Registration Statement was received in the office of the State Engineer on the 21 day of July, 19 58, at 8:00 o'clock A.M. and has been duly recorded in said office in Book No. 116 of Registration Statements on page GR-3055

Witness my hand this 15th day of February, 19 60

Paul A. Stanley
(State Engineer)

By _____
(Deputy)

GR 3055

7/15/58