

Registration Statement

OF CLAIMANT OF RIGHT TO APPROPRIATE GROUND WATER

TO THE STATE ENGINEER OF OREGON:

I, Harris Neil and Martha Beth Christensen
of Rt. 1 Box 171 Eugene, Or County of Lane
(Mailing address)

State of Oregon, do hereby make application for a certificate of registration as evidence of a right to appropriate ground water.

1. Source from which water is withdrawn is Pump Well
(Flowing well, pump well, infiltration trench, or tunnel)
2. Location is: 6 mi. North West of Eugene Oregon. One NW by Irving
(Approximate distance and direction from nearest city or town)

and is more particularly described as follows:

(a) 1536' E. then 285' N from corner of Section 4
SE 1/4 of NE 1/4 (Give distance and bearing to corner of section or other legal subdivision)
being within Lot 30-34 of Link Addition of Section 4, Twp. 17S, Rge. 1W
(Smallest legal subdivision) (N. or S.) (E. or W.)

or (b) within limits of recorded platted property, town or city:
in Lot 30 and 34, Block None of Link Addition
(Name of plat or addition)

NE 1/4 Sec 4 County of Lane
(If within city or town, give name)

3. Construction Work was begun on Aug 1947; was completed on Aug 1947
(Date) (Date)

and the ground water claimed was first used for the purposes set out below on June 1948
(Date)

since which time the water has been used Continuously
(Continuously or intermittently)

from June 1948 to Present Date
(Date) (Date)

4. Quantity of water claimed and used is 40 gallons per minute; 40 acre feet per year.

5. Purpose or Purposes for which water is used Domestic
(Domestic, irrigation, municipal, manufacturing, industrial, etc.)

6. Description of Well: Depth 26' feet. Type Drilled
(Dug or drilled)
diameter 3" inches. Elevation of ground at well site None feet, mean sea level.
(As near as known)
Depth to water table 2-7' feet.

7. Capacity of Well: 60 g.p.m. with 2 feet drawdown.
60 g.p.m. with 2 feet drawdown.

Date of test Aug 1947

If Flowing Well: Measured discharge None g.p.m. on None (Date)

Shut-in pressure at ground surface None lbs. per sq. in. on None (Date)

Water is controlled by None
(Cap, valve, etc.)

Township 17S Range 4W, W.M.
North

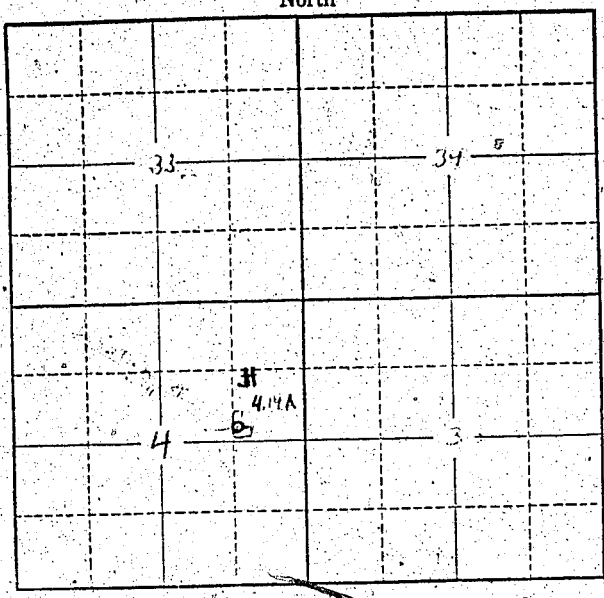

Locate well and acreage of irrigated land on plat.
Scale: 2" = 1 Mile

STATE OF OREGON }
County of } ss.

I,, being first duly sworn, do hereby certify that I have read the foregoing Registration Statement and that all of the items therein contained are true to the best of my knowledge and belief.

.....
(Signature of Registrant)

Subscribed and sworn to before me this day of, 19.....

My commission expires
(Notary Public)

(SEAL)

CERTIFICATE OF REGISTRATION

STATE OF OREGON }
County of Marion } ss.

This is to certify that the foregoing Registration Statement was received in the office of the State Engineer on the day of, 19....., at o'clock M. and has been duly recorded in said office in Book No. 10 of Registration Statements on page GR 221.

Witness my hand this 10th day of March, 1959

.....
(State Engineer)

By
(Deputy)

\$15.00

GR 221