

Registration Statement

OF CLAIMANT OF RIGHT TO APPROPRIATE GROUND WATER

TO THE STATE ENGINEER OF OREGON:

I, Mayme E. Carter (a Widow)
of Route 1, Box 107 Riddle County of Douglas
(Mailing address)

State of Oregon, do hereby make application for a certificate of registration as evidence of a right to appropriate ground water.

1. Source from which water is withdrawn is Pump Well #1
(Flowing well, pump well, infiltration trench, or tunnel)

2. Location is: 1/2 Mile East of Riddle
(Approximate distance and direction from nearest city or town)

and is more particularly described as follows: Beginning at a point 3.41 chains South from the S.E. corner of the J. J. C. Vanderbosch D.L.C.No.47 T30 S R.6 W, W.M. Thence South

(a) 73° East 436 ft.
(Give distance and bearing to corner of section or other legal subdivision)

being within N.W. 1/4 of S.E. 1/4 of Sec. 24 Twp. 20 S Rge. 6 W, W.M.
(Smallest legal subdivision) (N. or S.) (E. or W.)

or (b) within limits of recorded platted property, town or city:

in Lot _____, Block _____ of _____
(Name of plat or addition)

County of _____
(If within city or town, give name)

3. Construction Work was begun on 1924; was completed on 1924
(Date) (Date)

and the ground water claimed was first used for the purposes set out below on Summer 1924
(Date)

since which time the water has been used Continuously
(Continuously or intermittently)

from 1924 to 1958
(Date) (Date)

4. Quantity of water claimed and used is 80 gallons per minute; _____ acre feet per year.

5. Purpose or Purposes for which water is used Domestic and Irrigation as needed

(Domestic, irrigation, municipal, manufacturing, industrial, etc.)

6. Description of Well: Depth 11 feet. Type Dug
(Dug or drilled)

6" tile to diameter Concrete benches. Elevation of ground at well site 695 feet, mean sea level.
(As near as known)

Depth to water table 8 ft. in July 1924 feet.

7. Capacity of Well: 80 g.p.m. with unknown feet drawdown.
_____ g.p.m. with _____ feet drawdown.

Date of test No test made that I know of

If Flowing Well: Measured discharge _____ g.p.m. on _____
(Date)

Shut-in pressure at ground surface _____ lbs. per sq. in. on _____
(Date)

Water is controlled by _____
(Cap, valve, etc.)

8. Casing: (Give diameter, commercial specifications and depth below ground surface of each casing size.)

6 inch diameter Tile from Top to 9 feet
 inch diameter from to feet
 inch diameter from to feet
 inch diameter from to feet

Describe and show depth of shoe, plug, adapter, liner or other details: **B Concrete Box 30" sq. and 24" deep at bottom**

9. Perforated Casings or Screens:

None. Water flows in under box through gravel on top of Red Rock from to
 (Number per foot and size of perforations, or describe screen)
 from to
 from to
 from to

10. Log of Well: (Describe each stratum or formation clearly, indicate if water bearing, and give thickness and depth as indicated.)

MATERIAL	Thickness (Feet)	Depth to Bottom (Feet)
Top soil	1'	
Gravel	10'	

If log of well is not available, give name and address of driller.

11. Infiltration Trench: Covered or open

Dimensions: Length ft. Minimum depth ft. Maximum depth ft.

Bottom width ft. Discharge g.p.m. Date of test

12. Tunnel: Type of lining

Dimensions:
(Length, course, and cross sectional size)

Position of water bearing stratum with reference to portal of tunnel

Log of tunnel: (Preceding table for log of well may be used, if desired. Give footage from portal and character of materials, as pertinent.)

13. Pumping Equipment:

(a) Pump Berkley Centrifugal Capacity 78 g.p.m.
(Make, type and size)

(b) Motor Electric single phase 3 h.p.
(Type and horsepower)

14. Location of area irrigated or to be irrigated, or place of use if for purposes other than irrigation.

Township North or South	Range E. or W. of Willamette Meridian	Section	Forty-acre Tract	Number Acres To Be Irrigated	Date of Reclamation
30 S	6W, W.M.	24	N.W. 1/4 of S.E. 1/4	2	1924
30 S	6W, W.M.	24	S.W. 1/4 of S.E. 1/4	4	"
				6.2	"

15. If the ground water supply is supplemental to an existing water supply, identification of any application for a permit, permit, certificate or adjudicated right to appropriate water made or held by the registrant.

Township 30 S Range 6 W W.M.
North

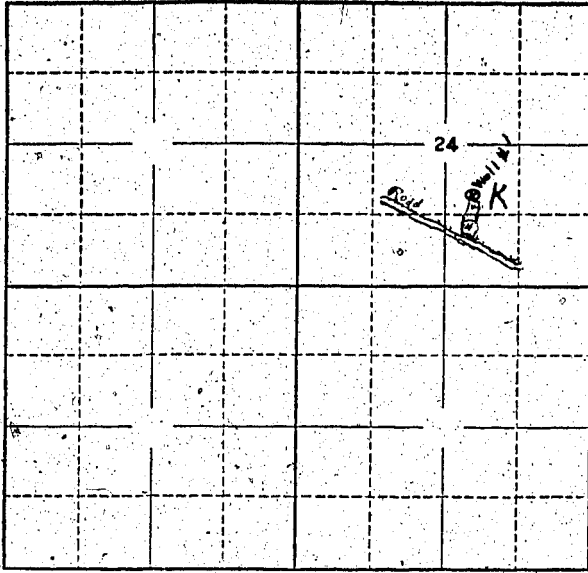

Locate well and acreage of irrigated land on plat.
Scale: 2" = 1 Mile

STATE OF OREGON

County of Douglas

} ss.

I, Mayne E. Carter, being first duly sworn, do hereby certify that I have read the foregoing Registration Statement and that all of the items therein contained are true to the best of my knowledge and belief.

Mayne E. Carter
(Signature of Registrant)

Subscribed and sworn to before me this 17 day of July, 19 58

My commission expires March 16, 1959

Garret Carter
(Notary Public)
For Oregon

(SEAL)

CERTIFICATE OF REGISTRATION

STATE OF OREGON

County of Marion

} ss.

This is to certify that the foregoing Registration Statement was received in the office of the State Engineer on the 21st day of July, 1958, at 6:00 o'clock A.M. and has been duly recorded in said office in Book No. 10 of Registration Statements on page GR-2210

Witness my hand this 10th day of March, 19 59

\$1500

Edwin H. [Signature]
(State Engineer)

By _____ (Deputy)

GR. 2210