

# Registration Statement

## OF CLAIMANT OF RIGHT TO APPROPRIATE GROUND WATER

TO THE STATE ENGINEER OF OREGON:

I, Mayme E. Carter (a Widow)

of Route 1, Box 107 Riddle County of Douglas  
(Mailing address)

State of Oregon, do hereby make application for a certificate of registration as evidence of a right to appropriate ground water.

1. Source from which water is withdrawn is Pump Well  
(Flowing well, pump well, infiltration trench, or tunnel)

2. Location is: 1/2 Mile East of Riddle  
(Approximate distance and direction from nearest city or town)

and is more particularly described as follows: Beginning at a point 3.41 chains S from the J.C. Vanderbosch D.L.C. No. 47 T 30 S . R 6 W, W.M. Thence South 1° East 420 Ft.

(a) being within N.W. 1/4 of S.E. 1/4 of Sec. 24, Twp. 30 S, Rge. 6 W, W.M.  
(Smallest legal subdivision) (N. or S.) (E. or W.)

or (b) within limits of recorded platted property, town or city:

in Lot \_\_\_\_\_ Block \_\_\_\_\_ of \_\_\_\_\_  
(Name of plat or addition)

County of \_\_\_\_\_  
(If within city or town, give name)

3. Construction Work was begun on July 1951; was completed on July 1951  
(Date) (Date)

and the ground water claimed was first used for the purposes set out below on Last half July 1951  
(Date)

since which time the water has been used When the pear crop sets so as to justify irrigating.  
(Continuously or intermittently)

from 15 of June to last of Aug.  
(Date) (Date)

4. Quantity of water claimed and used is 120 gallons per minute, \_\_\_\_\_ acre feet per year.

5. Purpose or Purposes for which water is used Irrigating approx. 8 acres of pear orchard  
(Domestic, irrigation, municipal, manufacturing, industrial, etc.)

6. Description of Well: Depth 15 feet. Type Dug  
(Dug or drilled)

diameter 30 inches. Elevation of ground at well site 700 feet, mean sea level.  
(As near as known)

Depth to water table 12 feet. July 1954

7. Capacity of Well: 120 g.p.m. with 2 feet drawdown.

\_\_\_\_\_ g.p.m. with \_\_\_\_\_ feet drawdown.

Date of test July 2x 1954

If Flowing Well: Measured discharge \_\_\_\_\_ g.p.m. on \_\_\_\_\_  
(Date)

Shut-in pressure at ground surface \_\_\_\_\_ lbs. per sq. in. on \_\_\_\_\_  
(Date)

Water is controlled by \_\_\_\_\_  
(Cap, valve, etc.)





Township 30 S Range 6 W W.M.  
North

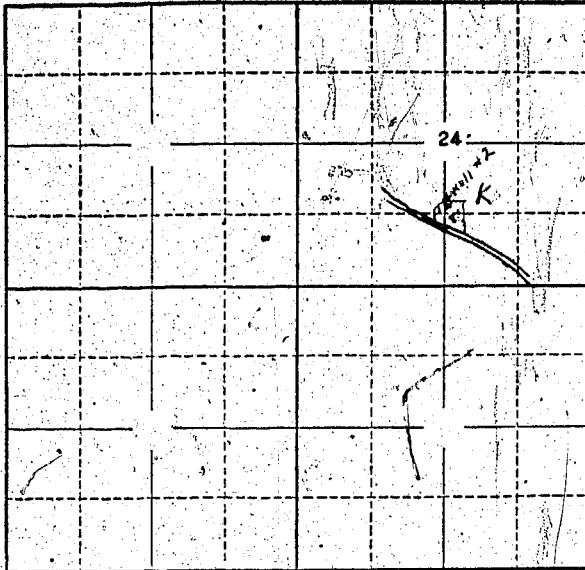

Locate well and acreage of irrigated land on plat.  
Scale: 2" = 1 Mile

STATE OF OREGON

County of Douglas } ss.

I, Mayme E. Carter, being first duly sworn, do hereby certify that I have read the foregoing Registration Statement and that all of the items therein contained are true to the best of my knowledge and belief.

Mayme E. Carter  
(Signature of Registrant)

Subscribed and sworn to before me this 17 day of July, 19 58

My commission expires March 16, 1959

Carroll Carter  
(Notary Public)

For Oregon

(SEAL)

**CERTIFICATE OF REGISTRATION**

STATE OF OREGON

County of Marion } ss.

This is to certify that the foregoing Registration Statement was received in the office of the State Engineer on the 21<sup>st</sup> day of July, 19 58, at 5:30 o'clock P.M. and has been duly recorded in said office in Book No. 10 of Registration Statements on page GR-221.

Witness my hand this 10<sup>th</sup> day of March, 19 59

[Signature]  
(State Engineer)

By \_\_\_\_\_  
(Deputy)

GR 221

#15.00