

Registration Statement

OF CLAIMANT OF RIGHT TO APPROPRIATE GROUND WATER

Filed in lieu of lost statement.

WSB 6/20/66

TO THE STATE ENGINEER OF OREGON:

I, Alvin D. Marshall
of Marshall-Kearney Highway County of Lane
(Mailing address)

State of Oregon, do hereby make application for a certificate of registration as evidence of a right to appropriate ground water.

1. Source from which water is withdrawn is Pump Well
(Flowing well, pump well, infiltration trench, or tunnel)
2. Location is: 7 miles east of Springfield
(Approximate distance and direction from nearest city or town)

and is more particularly described as follows:

- (a) well is about 1310 feet west 66 1/2 feet south of the
(Give distance and bearing to corner of section or other legal subdivision)
being within Section 31 of Sec. 31, Twp. 17S, Rge. 1W
(Smallest legal subdivision) (Range S.) (Range W.)
- or (b) within limits of recorded platted property, town or city:

in Lot _____, Block _____ of _____
(Name of plat or addition)
County of _____
(If within city or town, give name)

3. Construction Work was begun on 1942 about; was completed on 1942 about
(Date) (Date)
and the ground water claimed was first used for the purposes set out below on 1942 about
(Date)
since which time the water has been used continuously
(Continuously or intermittently)
from 1942 to 1966
(Date) (Date)

4. Quantity of water claimed and used is about 250 gallons per minute; _____ acre feet per year.

5. Purpose or Purposes for which water is used Irrigation used long before we came here - over 20 yrs. used on all acres
(Domestic, irrigation, municipal, manufacturing, industrial, etc.)

6. Description of Well: Depth 12 feet. Type drilled
(Dug or drilled)
diameter 6 inches. Elevation of ground at well site 16 feet, near sea level.
(As near as known)
Depth to water table about 10 feet.

7. Capacity of Well: don't know g.p.m. with 6 in. feet drawdown.
_____ g.p.m. with _____ feet drawdown.

Date of test Spring 1965
If Flowing Well: Measured discharge _____ g.p.m. on _____
(Date)
Shut-in pressure at ground surface X lbs. per sq. in. on _____
(Date)
Water is controlled by _____
(Cap, valve, etc.)

8. Casing: (Give diameter, commercial specifications and depth below ground surface of each casing size.)

6 inch diameter steel casing from 0 to 12 feet
 inch diameter from to feet
 inch diameter from to feet
 inch diameter from to feet

Describe and show depth of shoe, plug, adapter, liner or other details:

9. Perforated Casings or Screens:

60 Knack from to
 (Number per foot and size of perforations, or describe screen)
 from to
 from to
 from to

10. Log of Well: (Describe each stratum or formation clearly, indicate if water bearing, and give thickness and depth as indicated.)

| MATERIAL | Thickness (Feet) | Depth to Bottom (Feet) |
|-------------------|------------------|------------------------|
| | | |
| | | |
| Log not available | | |
| Well in gravel | | |
| | | |
| | | |
| | | |
| | | |
| | | |
| | | |
| | | |
| | | |
| | | |
| | | |
| | | |
| | | |
| | | |

Township 17S Range 1W, W.M.
North

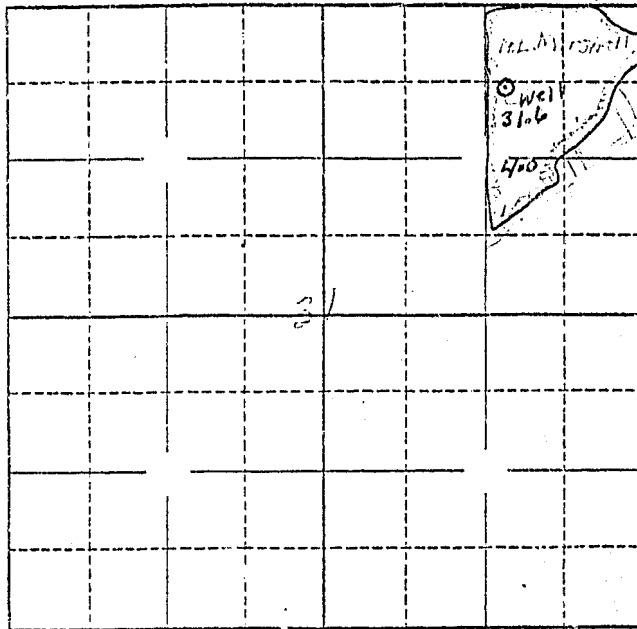

Locate well and acre. of irrigated land on plat.

Scale: $\frac{2''}{4''} = 1 \text{ Mile}$

STATE OF OREGON

County of Lane

} ss.

I, Harry L. Marshall, being first duly sworn, do hereby certify that I have read the foregoing Registration Statement and that all of the items therein contained are true to the best of my knowledge and belief.

Harry L. Marshall
(Signature of Registrant)

Subscribed and sworn to before me this 5th day of June, 1966

My commission expires July 28 1969

W. Brown
(Notary Public)

(SEAL)

CERTIFICATE OF REGISTRATION

STATE OF OREGON

County of Marion

} ss.

This is to certify that the foregoing Registration Statement was received in the office of the State Engineer on the 9th day of June, 1966, at 8:00 o'clock A. M. and has been duly recorded in said office in Book No. 17 of Registration Statements on page GR-4156

Witness my hand this 5th day of August, 1966

Chas. A. ...
(State Engineer)

\$ 15.20

By _____ (Deputy)

GR 4156