

Registration Statement

OF CLAIMANT OF RIGHT TO APPROPRIATE GROUND WATER

(Under Chapter 708, Oregon Laws 1955.)

TO THE STATE ENGINEER OF OREGON:

I, Allan M Herbst

of P.O. Box 751, Oregon City County of Clackamas

State of Oregon, do hereby make application for a certificate of registration as evidence of a right to appropriate ground water.

1. Source from which water is withdrawn is pump well
(Flowing well, pump well, infiltration trench, or tunnel)

2. Location is: 4 miles N.E. of Oregon City
(Approximate distance and direction from nearest city or town)

and is more particularly described as follows: 100 feet South of 900 feet west from E 1/4 corner Sec. 21,

(a) Pt. Jas. Winston d.u.c. #67 T. 2 S. R. 2 E. W. 1/4 - 15 ACRES MORE OR LESS
(Give distance and bearing to corner of section or other legal subdivision)
being within less plus Tract 203 of 4.5 acres of Sec. 21, Twp. 2S, Rge. 2E
(Smallest legal subdivision) (N. or S.) (E. or W.)

or (b) within limits of recorded platted property, town or city:

in Lot 3, Block 25 of 2E Winston Acres
(Name of plat or addition)

County of Clackamas
(If within city or town, give name)

3. Construction Work was begun on March 25, 1955; was completed on May 14, 1957
(Date) (Date)

and the ground water claimed was first used for the purposes set out below on Oct. 20, 1957
(Date)

since which time the water has been used continuously
(Continuously or intermittently)

from Oct. 20, 1957 to this date, July 25, 1958 & into future
(Date) (Date)

4. Quantity of water claimed and used is 16.0 gallons per minute: _____ acre feet per year.

5. Purpose or Purposes for which water is used domestic & irrigation
(Domestic, irrigation, municipal, manufacturing, industrial, etc.)

6. Description of Well: Depth 273 feet. Type drilled
(Dug or drilled)

diameter 6 inches. Elevation of ground at well site 120 feet, mean sea level.
(As near as known)

Depth to water table 227 feet.

7. Capacity of Well: 16.0 g.p.m. with 5' feet drawdown.

_____ g.p.m. with _____ feet drawdown.

Date of test May 3, 1957

If Flowing Well: Measured discharge ~~_____~~ g.p.m. on ~~_____~~
(Date)

Shut-in pressure at ground surface _____ lbs. per sq. in. on _____
(Date)

Water is controlled by _____
(Cap, valve, etc.)

8. Casing: (Give diameter, commercial specifications and depth below ground surface of each casing size.)

6 inch diameter from top to 266 feet
 inch diameter from to feet
 inch diameter from to feet
 inch diameter from to feet

Describe and show depth of shoe, plug, adapter, liner or other details:

9. Perforated Casings or Screens:

No from to
 (Number per foot and size of perforations, or describe screen)
 from to
 from to
 from to

10. Log of Well: (Describe each stratum or formation clearly, indicate if water bearing, and give thickness and depth as indicated.)

MATERIAL	Thickness (Feet)	Depth to Bottom (Feet)
Topsoil	0'	2'
Clay	2'	18'
Fine sand	18'	38'
Red clay	38'	53'
Sandy clay	53'	82'
River sand Heavy	82'	127'
River Gravel 2" to 3"	127'	192'
Black clay	192'	227'
Water	227'	
Heavy Black River Sand	227'	258'
Pea Gravel	258'	268'
Grey Clay	268'	272'

If log of well is not available, give name and address of driller.

drilled well ourselves

11. Infiltration Trench: Covered or open

Dimensions: Length ft. Minimum depth ft. Maximum depth ft.

Bottom width ft. Discharge g.p.m. Date of test

12. Tunnel: Type of lining

Dimensions: (Length, course, and cross sectional size)

Position of water bearing stratum with reference to portal of tunnel

Log of tunnel: (Preceding table for log of well may be used, if desired. Give footage from portal and character of materials, as pertinent.)

13. Pumping Equipment: on the drilled well

(a) Pump 15 horse portable turbine Capacity 100 g.p.m.

(b) Motor (Type and horsepower)

14. Location of area irrigated or to be irrigated, or place of use if for purposes other than irrigation.

Township North or South	Range E. or W. of Willamette Meridian	Section	Forty-acre Tract	Number Acres To Be Irrigated	Date of Reclamation
25	range 2 East	21	NE 1/4 of SE 1/4	9 ⁰	1957
25	2E	21	SE 1/4 of SE 1/4	11 ⁰	"
				20 ⁰	"

15. If the ground water supply is supplemental to an existing water supply, identification of any application for a permit, permit, certificate or adjudicated right to appropriate water made or held by the registrant.

N.

Township 25 Range 2E, W.M.
North

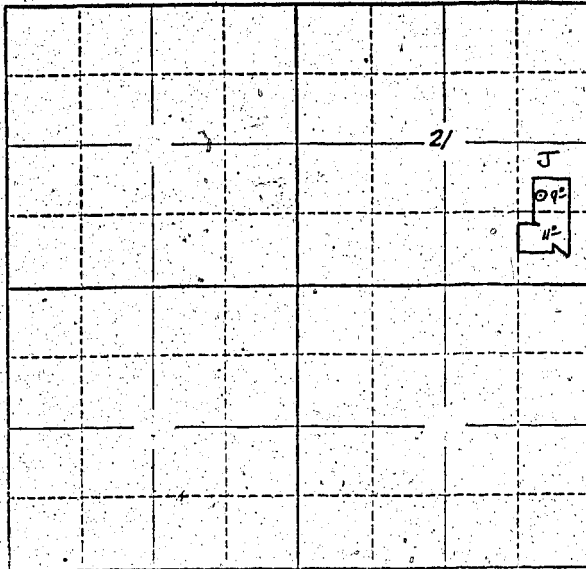

map attached

Locate well and acreage of irrigated land on plat.
Scale: 2" = 1 Mile

STATE OF OREGON

County of Clackamas } ss.

I, Albert M. Herbst, being first duly sworn, do hereby certify that I have read the foregoing Registration Statement and that all of the items therein contained are true to the best of my knowledge and belief.

Albert M. Herbst
(Signature of Registrant)

Subscribed and sworn to before me this 15 day of July, 1954

My commission expires _____

Robert Schumacher, P. O. C.
(Notary Public)
James C. Allen, Deputy

(SEAL)

CERTIFICATE OF REGISTRATION

STATE OF OREGON

County of Marion } ss.

This is to certify that the foregoing Registration Statement was received in the office of the State Engineer on the 21st day of July, 1958, at 8:00 o'clock A. M. and has been duly recorded in said office in Book No. 10 of Registration Statements on page GR-2291

Witness my hand this 10th day of March, 1959

Lewis A. Stanley
(State Engineer)

By _____ (Deputy)

\$15.00

GR-2291