

Registration No. GR. 2421

Certificate No. GR. 2301

Registration Statement

OF CLAIMANT OF RIGHT TO APPROPRIATE GROUND WATER

TO THE STATE ENGINEER OF OREGON:

I, DENNIS J. WOELKE
of RTI Box 484, Woodburn County of MARION
(Mailing address)

State of Oregon, do hereby make application for a certificate of registration as evidence of a right to appropriate ground water.

- Source from which water is withdrawn is PUMP WELL
(Flowing well, pump well, infiltration trench, or tunnel)
- Location is: 3 MILES WEST OF WOODBURN
(Approximate distance and direction from nearest city or town)

and is more particularly described as follows:

(a) 200' W & 700' S From N¹/₄ Corner Section 3
(Give distance and bearing to corner of section or other legal subdivision)
being within NE¹/₄ NW¹/₄ of Sec. 3, Twp. 5 S, Rge. 2 W
(Smallest legal subdivision) (N. or S.) (E. or W.)

or (b) within limits of recorded platted property, town or city:

in Lot _____ Block _____ of _____
(Name of plat or addition)

(If within city or town, give name) County of MARION

3. Construction Work was begun on 9/12/53; was completed on 9/28/53
(Date) (Date)
and the ground water claimed was first used for the purposes set out below on 5/20/55
(Date)
since which time the water has been used CONTINUOUSLY
(Continuously or intermittently)
from MAY to OCT.
(Date) (Date)

4. Quantity of water claimed and used is 60 gallons per minute; 8 acre feet per year.

5. Purpose or Purposes for which water is used Domestic and Irrigation
(Domestic, irrigation, municipal, manufacturing, industrial, etc.)

6. Description of Well: Depth 97 feet. Type DRILLED
(Dug or drilled)
diameter 6 inches. Elevation of ground at well site 150 feet; mean sea level.
(As near as known)
Depth to water table 22 feet.

7. Capacity of Well: 175 g.p.m. with 55 feet drawdown.
_____ g.p.m. with _____ feet drawdown.

Date of test 9/29/53

If Flowing Well: Measured discharge _____ g.p.m. on _____
(Date)

Shut-in pressure at ground surface _____ lbs. per sq. in. on _____
(Date)

Water is controlled by _____
(Cap, valve, etc.)

8. Casing: (Give diameter, commercial specifications and depth below ground surface of each casing size.)

6 inch diameter from 0 to 97 feet
inch diameter from to feet
inch diameter from to feet
inch diameter from to feet

Describe and show depth of shoe, plug, adapter, liner or other details:

CASING WAS PLUG AT BOTTOM

9. Perforated Casings or Screens:

90 $\frac{1}{2}$ X 2 IN PGP FOOT from 81 to 96
(Number per foot and size of perforations, or describe screen)
from to
from to
from to

10. Log of Well: (Describe each stratum or formation clearly, indicate if water bearing, and give thickness and depth as indicated.)

MATERIAL	Thickness (Feet)	Depth to Bottom (Feet)
TOP SOIL	3	0-3
BLUE CLAY	78	3-81
BLACK SAND	15	81-96
WELL WAS GRAVEL PACKED.		

If log of well is not available, give name and address of driller.

B1. Infiltration Trench: Covered or open

Dimensions: Length ft. Minimum depth ft. Maximum depth ft.

Bottom width ft. Discharge g.p.m. Date of test

B2 Tunnel: Type of lining

Dimensions:
(Length, course, and cross sectional size)

Position of water bearing stratum with reference to portal of tunnel

Log of tunnel: (Preceding table for log of well may be used, if desired. Give footage from portal and character of materials, as pertinent.)

13. Pumping Equipment:

(a) Pump Sunco Submersible 7CL5 Capacity 60 ~~750~~ g.p.m.
(Make, type and size)

(b) Motor U. H. P.
(Type and horsepower)

14. Location of area irrigated or to be irrigated, or place of use if for purposes other than irrigation.

Township North or South	Range E. or W. of Willamette Meridian	Section	Forty-acre Tract	Number Acres To Be Irrigated	Date of Reclamation
5S	2W	2	SE ¹ / ₄ SW ¹ / ₄	<u>1/2</u>	<u>5/20/35</u>
"	"	"	SW ¹ / ₄ SE ¹ / ₄	<u>1/2</u>	"
"	"	3	NW ¹ / ₄ NE ¹ / ₄	<u>1</u>	"
"	"	"	NE ¹ / ₄ NW ¹ / ₄	<u>5 1/2</u>	"
				Total <u>7 1/2 ac</u>	

B15. If the ground water supply is supplemental to an existing water supply, identification of any application for a permit, permit, certificate or adjudicated right to appropriate water made or held by the registrant.

S 1/2 Section 2 4 N 1/2 Section 11

Township 55 Range 2W, W.M.

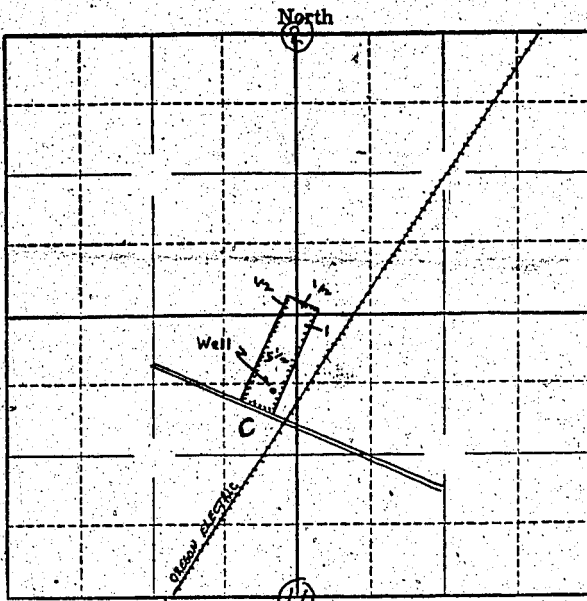

Locate well and acreage of irrigated land on plat.

Scale: 2" = 1 Mile

STATE OF OREGON

County of Marion

ss.

I, Dennis J. Maske, being first duly sworn, do hereby certify that I have read the foregoing Registration Statement and that all of the items therein contained are true to the best of my knowledge and belief.

Dennis J. Maske (Signature of Registrant)

Subscribed and sworn to before me this 21st day of July, 1958

My commission expires Sept 8, 1960

Charles Schaller (Notary Public)

(SEAL)

CERTIFICATE OF REGISTRATION

STATE OF OREGON

County of Marion

ss.

This is to certify that the foregoing Registration Statement was received in the office of the State Engineer on the 21st day of July, 1958, at 8:00 o'clock A.M. and has been duly recorded in said office in Book No. 10 of Registration Statements on page 230.

Witness my hand this 10th day of March, 1959

Willie L. Stovall (State Engineer)

By

(Deputy)

4500

GR-2301