

RECEIVED
AUG 1 1956
STATE ENGINEER
SALEM, OREGON

REGISTRATION NO. GR-244
CERTIFICATE NO. GR-220

Registration Statement

OF CLAIMANT OF RIGHT TO APPROPRIATE GROUND WATER

(Under Chapter 708, Oregon Laws 1955.)

TO THE STATE ENGINEER OF OREGON:

I, EAYL LOFTON AND Lucy M. LOFTON RT1, Box 7B

of DAYTON County of YAMHILL

State of Oregon do hereby make application for a certificate of registration as evidence of a right to appropriate ground water.

- 1. Source from which water is withdrawn is PUMP WELL
(Flowing well, pump well, infiltration trench, or tunnel)
- 2. Location is: 1/4 MI. SOUTH WEST OF DAYTON off Hwy. 233.
(Approximate distance and direction from nearest city or town)

and is more particularly described as follows:

(a) 1200 feet east and 450 south from NW corner of section 20
(Give distance and bearing to corner of section or other legal subdivision)

being within Quadrant 1 of Sec. #4, Twp. 5S, Rge. 4W
(Smallest legal subdivision) (N. or S.) (E. or W.)

or (b) within limits of recorded platted property, town or city: DAYTON

in Lot #4, Block #11 of LIPPINCOTT'S SECOND ADDITION
(Name of plat or addition)

County of YAMHILL
(If within city or town, give name)

3. Construction Work was begun on MAY 1951 was completed on JUNE 15, 1951
(Date) (Date)

and the ground water claimed was first used for the purposes set out below on Aug. 15-1951
(Date)

since which time the water has been used each year since
(Continuously or intermittently)

from May 10- to about Sept. 15-
(Date) (Date)

4. Quantity of water claimed and used is 150 gallons per minute; _____ acre feet per year.

5. Purpose or Purposes for which water is used _____

irrigation
(Domestic, irrigation, municipal, manufacturing, industrial, etc.)

6. Description of Well: Depth 106 feet. Type DRILLED
(Dug or drilled)

diameter 10 1/2 inches. Elevation of ground at well site around 500 ft. feet, mean sea level.
(As near as known)

Depth to water _____ feet.

7. Capacity _____ g.p.m. with _____ feet drawdown.

_____ g.p.m. with _____ feet drawdown.

Date of _____

_____ g.p.m. on Aug. 12-1951
(Date)

_____ lbs. per sq. in. on _____
(Date)

Well _____
(Cap, valve, etc.)

8. Casing: (Give diameter, commercial specifications and depth below ground surface of each casing size.)

8 inch diameter *Complet* from 0 to 82.6 feet
 inch diameter from to feet
 inch diameter from to feet
 inch diameter from to feet

Describe and show depth of shoe, plug, adapter, liner or other details:

9. Perforated Casings or Screens:

82 ft solid pipe - rest 24 ft perforated from to
(Number per foot and size of perforations, or describe screen)
 water table 20 ft from to
 from to

10. Log of Well: (Describe each stratum or formation clearly, indicate if water bearing, and give thickness and depth as indicated.)

MATERIAL	Thickness (Feet)	Depth to Bottom (Feet)
Top soil	0-2	
Brown clay	2-19	
silt	19-25	
blue clay	25-58	
sand stone	58-82	
sand	82-106	

If log of well is not available, give name and address of driller.

11. Infiltration Trench: Covered or open

Dimensions: Length ft. Minimum depth ft. Maximum depth ft.

Bottom width ft. Discharge g.p.m. Date of test

12. Tunnel: Type of lining

Dimensions:
(Length, course, and cross sectional size)

Position of water bearing stratum with reference to portal of tunnel

Log of tunnel: (Preceding table for log of well may be used, if desired. Give footage from portal and character of materials, as pertinent.)

13. Pumping Equipment:

(a) Pump *Fairbanks* Capacity *750* g.p.m.
(Make, type and size)

(b) Motor *electric - 3 horsepower*
(Type and horsepower)

14. Location of area irrigated or to be irrigated, or place of use if for purposes other than irrigation.

Township North or South	Range E. or W. of Willamette Meridian	Section	Forty-acre Tract	Number Acres To Be Irrigated	Date of Reclamation
<i>55.</i>	<i>4 W.</i>	<i>10</i>	<i>NE 1/4 of NE 1/4</i> <i># 62</i>	<i>7</i>	<i>Aug. 15 1951</i>

15. If the ground water supply is supplemental to an existing water supply, identification of any application for a permit, permit, certificate or adjudicated right to appropriate water made or held by the registrant.

Township 4S Range 3W, W.M.
North

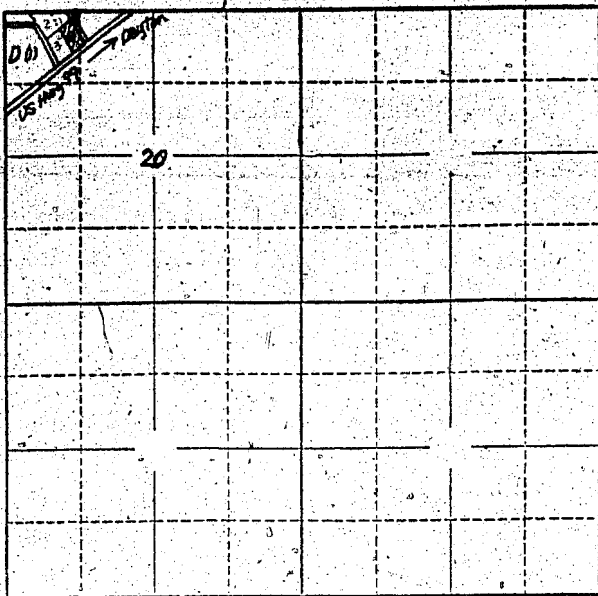

Locate well and acreage of irrigated land on plat.
Scale: 2" = 1 Mile

STATE OF OREGON

County of Yamhill } ss.

I, Earl Lofton & Lucy M. Lofton, being first duly sworn, do hereby certify that I have read the foregoing Registration Statement and that all of the items therein contained are true to the best of my knowledge and belief.

Earl Lofton
Lucy M. Lofton
(Signature of Registrant)

Subscribed and sworn to before me this 31st day of July 19 56

My commission expires May 23, 1960

Kenneth H. Powers
(Notary Public)

(SEAL)

CERTIFICATE OF REGISTRATION

STATE OF OREGON } ss.
County of Marion

This is to certify that the foregoing Registration Statement was received in the office of the State Engineer on the 28th day of August, 1956, at 8 o'clock A.M. and has been duly recorded in said office in Book No. 2 of Registration Statements on page GR-220 C

~~Construction shall be completed by X-X-X-X-X-X-X-X-X-X-X-X and the water consistory applied to~~
~~beneficial use by X-X-X-X-X-X-X-X-X-X-X-X~~

Witness my hand this 23rd day of November, 19 56

Leura A. Stanley
(State Engineer)

By _____
(Deputy)

GR-220C