

Registration Statement

OF CLAIMANT OF RIGHT TO APPROPRIATE GROUND WATER.

TO THE STATE ENGINEER OF OREGON:

I, J. L. DAVIS
of Royal Bldg 383, Corvallis County of Clatskanie

State of Oregon, do hereby make application for a certificate of registration as evidence of a right to appropriate ground water.

1. Source from which water is withdrawn is Pump well
(Flowing well, pump well, infiltration trench, or tunnel)

2. Location is: Three miles south of Astoria
(Approximate distance and direction from nearest city or town)

and is more particularly described as follows:

(a) 400 feet north & 500 feet west from E 1/4 corner
(Give distance and bearing to corner of section or other legal subdivision)
being within SE 1/4 NE 1/4 of Sec. 33, Twp. 4 S, Rge. 1 W
(Smallest legal subdivision) (N. or S.) (E. or W.)

or (b) within limits of recorded platted property, town or city:

in Lot _____, Block _____ of _____
(Name of plat or addition)

County of _____
(If within city or town, give name)

3. Construction Work was begun on Mar 2, 1952 was completed on Mar 15, 1952
(Date) (Date)

and the ground water claimed was first used for the purposes set out below on May 1952
(Date)

since which time the water has been used Intermittently
(Continuously or intermittently)

from Apr to Oct
(Date) (Date)

4. Quantity of water claimed and used is 250 gallons per minute; _____ acre feet per year.

5. Purpose or Purposes for which water is used Fire of farm crops
(Domestic, irrigation, municipal, manufacturing, industrial, etc.)

6. Description of Well: Depth 144 feet. Type Drilled
(Dug or drilled)

diameter 6 inches. Elevation of ground at well site 36.0 feet, mean sea level.
(As near as known)

Depth to water table 4.5 feet.

7. Capacity of Well: 250 g.p.m. with 2.2 feet drawdown.

_____ g.p.m. with _____ feet drawdown.

Date of test March 1952

If Flowing Well: Measured discharge _____ g.p.m. on _____
(Date)

Shut-in pressure at ground surface _____ lbs. per sq. in. on _____
(Date)

Water is controlled by _____
(Cap, valve, etc.)

8. Casing: (Give diameter, commercial specifications and depth below ground surface of each casing size.)

6 inch diameter 0 from ~~0~~ to 133 feet
 inch diameter from to feet
 inch diameter from to feet
 inch diameter from to feet

Describe and show depth of shoe, plug, adapter, liner or other details:
 6 in Well 6 I.B. 1

9. Perforated Casings or Screens:

5 Rows $3/8 \times 1 1/2$ slots from 120 to 133
(Number per foot and size of perforations, or describe screen)
 from to
 from to
 from to

10. Log of Well: (Describe each stratum or formation clearly, indicate if water bearing, and give thickness and depth as indicated.)

MATERIAL	Thickness (Feet)	Depth to Bottom (Feet)
Brown sand + silt	0	34
Blue silt	34	64
Blue clay	64	82
Black sand	82	86
Brown clay	86	98
Blue clay	98	108
Fine Sand	108	116
Sand + Gravel (Brown)	116	139
Blue Clay	132	144
Large Blue Gravel	144	

Township 45 Range 1 W, W.M.
North

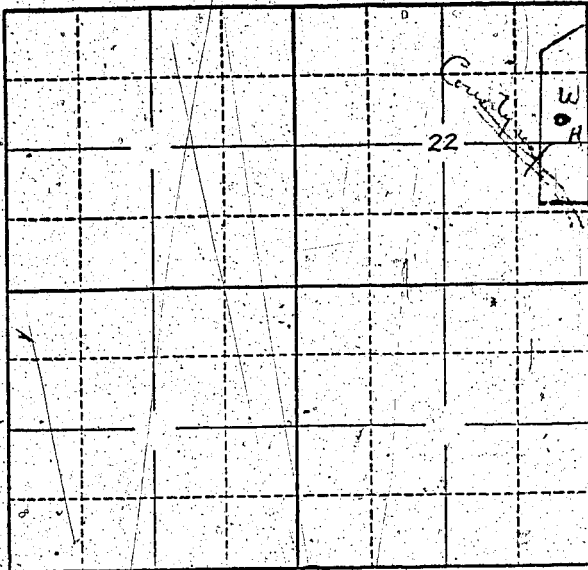

4-11-58
E/E 31 E/-
D.A.H. ST. COMM
D.C.E.
50/25 A
V. 11-11-58

W7

E

Locate well and acreage of irrigated land on plat.
Scale: 2" = 1 Mile

STATE OF OREGON

County of Clackamas } ss.

I, J. H. Davis, being first duly sworn, do hereby certify that I have read the foregoing Registration Statement and that all of the items therein contained are true to the best of my knowledge and belief.

J. H. Davis
(Signature of Registrant)

Subscribed and sworn to before me this 21st day of July, 1958

My commission expires Jan 29 1961 John A. Letterman
(Notary Public)

(SEAL)

CERTIFICATE OF REGISTRATION

STATE OF OREGON

County of Marion } ss.

This is to certify that the foregoing Registration Statement was received in the office of the State Engineer on the 22 day of July, 1958, at 8:00 o'clock A. M. and has been duly recorded in said office in Book No. 10 of Registration Statements on page 6R-2319

Witness my hand this 10th day of March, 1959

Lewis A. Stanley
(State Engineer)

By _____ (Deputy)

4/17/58