

RECEIVED
JUL 22 1958
STATE ENGINEER
SALEM, OREGON

Registration No. GR - 2465

Certificate No. GR - 2335

Registration Statement

OF CLAIMANT OF RIGHT TO APPROPRIATE GROUND WATER

TO THE STATE ENGINEER OF OREGON:

I, JACK L. BARRON

of 16425 S.W. HAET Rd. Beaverton County of WASHINGTON
(Mailing address)

State of OREGON, do hereby make application for a certificate of registration as evidence of a right to appropriate ground water.

1. Source from which water is withdrawn is Pump Well
(Flowing well, pump well, infiltration trench, or tunnel)

2. Location is: 3 1/2 Mi S.W. Beaverton
(Approximate distance and direction from nearest city or town)

and is more particularly described as follows:

(a) 1,580 ft N8°31'E from SW corner Section 20
(Give distance and bearing to corner of section or other legal subdivision)

being within NW 1/4 SW 1/4 of Sec. 20, Twp. 15, Rge. 1W
(Smallest legal subdivision) (N. or S.) (E. or W.)

or (b) within limits of recorded platted property, town or city:

in Lot _____, Block _____ of _____
(Name of plat or addition)

County of WASHINGTON
(If within city or town, give name)

3. Construction Work was begun on April 1949; was completed on DEC 1954
(Date) (Date)

and the ground water claimed was first used for the purposes set out below on MAY 1949
(Date)

since which time the water has been used Intermittently
(Continuously or Intermittently)

from MAY 1949 to 1958
(Date) (Date)

4. Quantity of water claimed and used is 14 gallons per minute; 2.0 acre feet per year.

5. Purpose or Purposes for which water is used Irrigation & Domestic

(Domestic, irrigation, municipal, manufacturing, industrial, etc.)

6. Description of Well: Depth 276 feet. Type Drilled
(Dug or drilled)

diameter 6 inches. Elevation of ground at well site 197 feet, mean sea level.
(As near as known)

Depth to water table 78 feet.

7. Capacity of Well: 14 g.p.m. with 0 feet drawdown.

_____ g.p.m. with _____ feet drawdown.

Date of test During Use Actual Pump test for MAX. Not made

If Flowing Well: Measured discharge _____ g.p.m. on _____
(Date)

Shut-in pressure at ground surface _____ lbs. per sq. in. on _____
(Date)

Water is controlled by _____
(Cap. valve, etc.)

Township 15 Range 1W, W.M.
North

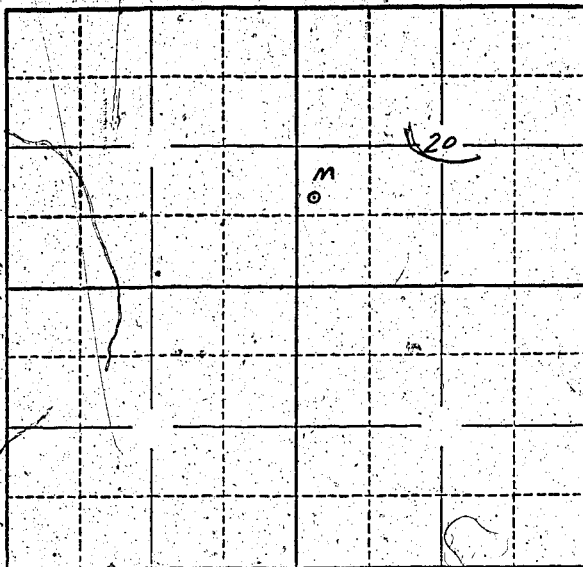

Locate well and acreage of irrigated land on plat.
Scale: 2" = 1 Mile

STATE OF OREGON

County of Marion } ss.

I, Jack L. Barron, being first duly sworn, do hereby certify that I have read the foregoing Registration Statement and that all of the items therein contained are true to the best of my knowledge and belief.

Jack L. Barron
(Signature of Registrant)

Subscribed and sworn to before me this 7th day of July, 1958

My commission expires 12th June 1961

Wm. S. Bartholomew
(Notary Public)

(SEAL)

CERTIFICATE OF REGISTRATION

STATE OF OREGON

County of Marion } ss.

This is to certify that the foregoing Registration Statement was received in the office of the State Engineer on the 22 day of July, 1958, at 8:00 o'clock A. M. and has been duly recorded in said office in Book No. _____ of Registration Statements on page GR-2335

Witness my hand this 10th day of March, 1959

\$15.00

Lewis A. Stanley
(State Engineer)

By _____
(Deputy)

GR 2335