

RECEIVED  
MAY 23 1958  
STATE ENGINEER  
SALEM, OREGON

Registration No. GR. 2111  
Certificate No. GR. 2340

# Registration Statement

## OF CLAIMANT OF RIGHT TO APPROPRIATE GROUND WATER

TO THE STATE ENGINEER OF OREGON:

I, Millard Wilde

of Trail County of Jackson

(Mailing address)

State of Oregon, do hereby make application for a certificate of registration as evidence of a right to appropriate ground water.

1. Source from which water is withdrawn is pump well  
(Flowing well, pump well, infiltration trench, or tunnel)

2. Location is: 4 1/2 miles East of Trail, Oregon  
(Approximate distance and direction from nearest city or town)

and is more particularly described as follows:

(a) 778 ft. North and 37 ft. East from the S 1/2 cor. of Sec. 30  
(Give distance and bearing to corner of section or other legal subdivision)

being within NW 1/4 SW 1/4 SE 1/4 of Sec. 30, Twp. 33S Rge. 1 E  
(Smallest legal subdivision) (N. or S.) (E. or W.)

or (b) within limits of recorded platted property, town or city:

in Lot \_\_\_\_\_, Block \_\_\_\_\_ of \_\_\_\_\_  
(Name of plat or addition)

County of \_\_\_\_\_  
(If within city or town, give name)

3. Construction Work was begun on 1952; was completed on 1952  
(Date) (Date)

and the ground water claimed was first used for the purposes set out below on 1953  
(Date)

since which time the water has been used Intermittently  
(Continuously or intermittently)

from 1953 to present  
(Date) (Date)

4. Quantity of water claimed and used is 25 gallons per minute; 1.7 acre feet per year.

5. Purpose or Purposes for which water is used Irrigation

(Domestic, irrigation, municipal, manufacturing, industrial, etc.)

6. Description of Well: Depth 58 feet. Type Drilled  
(Dug or drilled)

diameter 6.0 inches. Elevation of ground at well site 1500 feet, mean sea level.  
(As near as known)

Depth to water table 7 feet.

7. Capacity of Well: \_\_\_\_\_ g.p.m. with \_\_\_\_\_ feet drawdown.

\_\_\_\_\_ g.p.m. with \_\_\_\_\_ feet drawdown.

Date of test none

If Flowing Well: Measured discharge \_\_\_\_\_ g.p.m. on \_\_\_\_\_  
(Date)

Shut-in pressure at ground surface \_\_\_\_\_ lbs. per sq. in. on \_\_\_\_\_  
(Date)

Water is controlled by \_\_\_\_\_  
(Cap, valve, etc.)



If log of well is not available, give name and address of driller. not known

11. Infiltration Trench: Covered or open .....

Dimensions: Length ..... ft. Minimum depth ..... ft. Maximum depth ..... ft.

Bottom width ..... ft. Discharge ..... g.p.m. Date of test .....

12. Tunnel: Type of lining .....

Dimensions: .....  
(Length, course, and cross sectional size)

Position of water bearing stratum with reference to portal of tunnel .....

Log of tunnel: (Preceding table for log of well may be used, if desired. Give footage from portal and character of materials, as pertinent.)

13. Pumping Equipment:

(a) Pump 1.0 inch Centrifugal pump Capacity 1200 g.p.m.  
(Make, type and size)

(b) Motor 1 H.P. electric motor  
(Type and horsepower)

14. Location of area irrigated or to be irrigated, or place of use if for purposes other than irrigation.

Township North or South	Range E. or W. of Willamette Meridian	Section	Forty-acre Tract	Number Acres To Be Irrigated	Date of Reclamation
33 S.	1 E.	30	SW $\frac{1}{4}$ NW $\frac{1}{4}$ SE $\frac{1}{4}$	0.4 acre	1953
			W $\frac{1}{2}$ SW $\frac{1}{4}$ SE $\frac{1}{4}$	3.3 acres	1953
			Total	3.7 acres	

15. If the ground water supply is supplemental to an existing water supply, identification of any application for a permit, permit, certificate or adjudicated right to appropriate water made or held by the registrant.  
none

Township 33 S. Range 1 E. W.M.  
North

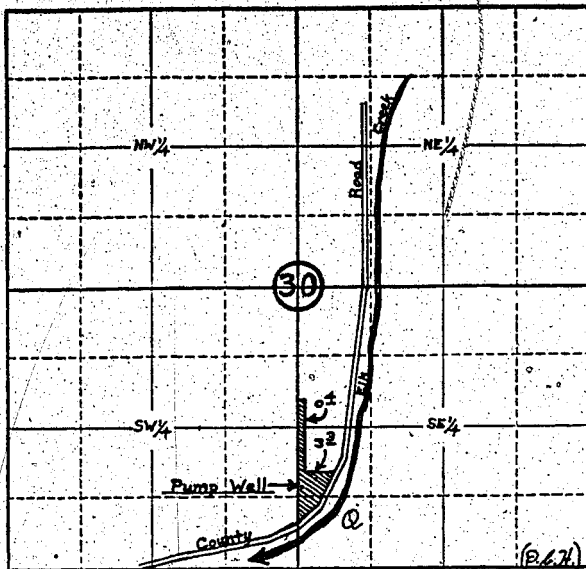

Locate well and acreage of irrigated land on plat.  
Scale: 4" = 1 Mile

STATE OF OREGON }  
County of Jackson } ss.

I, Millard Wilde, being first duly sworn, do hereby certify that I have read the foregoing Registration Statement and that all of the items therein contained are true to the best of my knowledge and belief.

(Signature of Registrant)

Subscribed and sworn to before me this 21st day of July, 19 58

My commission expires August 25, 1958

(Notary Public)

(SEAL)

### CERTIFICATE OF REGISTRATION

STATE OF OREGON }  
County of Marion } ss.

This is to certify that the foregoing Registration Statement was received in the office of the State Engineer on the 22 day of July, 1958, at 8:00 o'clock A. M. and has been duly recorded in said office in Book No. 10 of Registration Statements on page GR 2340

Witness my hand this 10<sup>th</sup> day of March, 19 59

\$15.00

Lewis A. Stanley  
(State Engineer)

By \_\_\_\_\_ (Deputy)