

RECEIVED  
AUG 21 1956  
STATE ENGINEER  
SALEM, OREGON

GR-248

REGISTRATION NO. ~~GR-1188~~

# Registration Statement

CERTIFICATE NO. GR-224

## OF CLAIMANT OF RIGHT TO APPROPRIATE GROUND WATER

(Under Chapter 708, Oregon Laws 1955.)

TO THE STATE ENGINEER OF OREGON:

I, Wm. Uppstad  
of Jefferson County of Linn

State of Oregon, do hereby make application for a certificate of registration as evidence of a right to appropriate ground water.

1. Source from which water is withdrawn is Pump well No. 1  
(Flowing well, pump well, infiltration trench, or tunnel)

2. Location is: 3 1/2 miles East of Jefferson, Oregon  
(Approximate distance and direction from nearest city or town)

and is more particularly described as follows:

(a) N. 21° W. 31.0 chains from the SE corner S. 8, T. 10 S., R. 2 W., M.  
(Give distance and bearing to corner of section or other legal subdivision)  
being within NE 1/4 of SE 1/4 of Sec. 8 Twp. 10 S. Rge. 2 W.  
(Smallest legal subdivision) (N. of S.) (E. or W.)

or (b) within limits of recorded platted property, town or city:  
in Lot \_\_\_\_\_, Block \_\_\_\_\_ of \_\_\_\_\_  
(Name of plat or addition)

County of Linn  
(If within city or town, give name)

3. Construction Work was begun on 1941, was completed on 1941  
(Date) (Date)

and the ground water claimed was first used for the purposes set out below on June 15, 1941  
(Date)

since which time the water has been used continuously  
(Continuously or intermittently?)

from June 15, 1941 to present time  
(Date) (Date)

4. Quantity of water claimed and used is 300 gallons per minute; 60 acre feet per year.

5. Purpose or Purposes for which water is used Irrigation

(Domestic, irrigation, municipal, manufacturing, industrial, etc.)

6. Description of Well: Depth 21 feet. Type driven  
(Dug or drilled)

diameter 4 inches. Elevation of ground at well site 270 feet, mean sea level.  
(As near as known)

Depth to water table 10 feet.

7. Capacity of Well: 350 g.p.m. with 16 feet drawdown.

\_\_\_\_\_ g.p.m. with \_\_\_\_\_ feet drawdown.

Date of test Not tested

If Flowing Well: Measured discharge \_\_\_\_\_ g.p.m. on \_\_\_\_\_  
(Date)

Shut-in pressure at ground surface \_\_\_\_\_ lbs. per sq. in. on \_\_\_\_\_  
(Date)

Water is controlled by \_\_\_\_\_  
(Cap, valve, etc.)





Township ..... Range ..... W.M.  
North

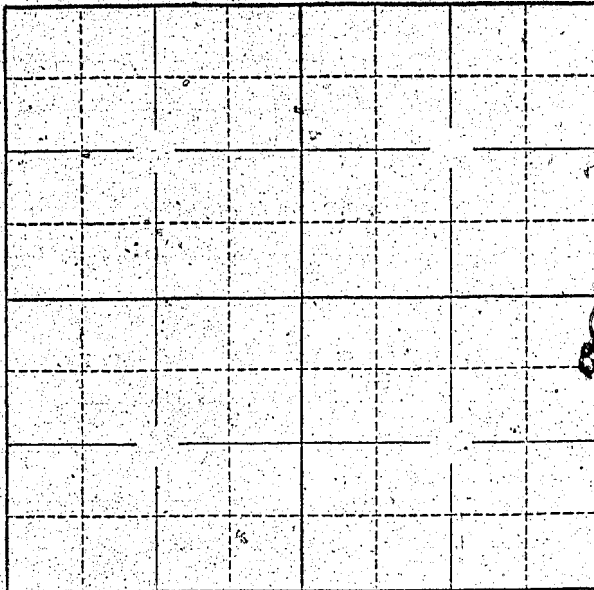

Locate well and acreage of irrigated land on plat.  
Scale: 2" = 1 Mile

STATE OF OREGON

County of Linn } ss.

I, Wm. Upstad, being first duly sworn, do hereby certify that I have read the foregoing Registration Statement and that all of the items therein contained are true to the best of my knowledge and belief.

(Signature of Registrant)

Subscribed and sworn to before me this ..... day of ..... 19.....

My commission expires .....

(Notary Public)

(SEAL)

SEE PAGE GR-224 K FOR  
CERTIFICATE OF REGISTRATION

STATE OF OREGON

County of Marion } ss.

This is to certify that the foregoing Registration Statement was received in the office of the State Engineer on the X-X-X-X day of X-X-X-X-X-X-X-X, 19X-X, at X-X-X-X-X-X-X-X, X-X-M and has been duly recorded in said office in Book X-X-X-X-X-X-X-X of Registration Statements on page X-X-X-X-X-X.

Construction shall be completed by X-X-X-X-X-X-X-X, 19X-X, and the water completely applied to beneficial use by X-X-X-X-X-X-X-X, 19X-X.

Witness my hand this ..... day of ..... 19.....

(State Engineer)

By ..... (Deputy)

GR-224C

RECEIVED  
AUG 21 1956  
STATE ENGINEER  
SALEM, OREGON

REGISTRATION NO. ~~GR-224~~ GR-248  
CERTIFICATE NO. GR-224

# Registration Statement

## OF CLAIMANT OF RIGHT TO APPROPRIATE GROUND WATER

(Under Chapter 708, Oregon Laws 1955.)

### TO THE STATE ENGINEER OF OREGON:

I, Wm. Upstad

of Jefferson County of Linn

State of Oregon, do hereby make application for a certificate of registration as evidence of a right to appropriate ground water.

1. Source from which water is withdrawn is Pump Well No. 2  
(Flowing well, pump well, infiltration trench, or tunnel)

2. Location is: 3 1/2 miles East of Jefferson, Oregon  
(Approximate distance and direction from nearest city or town)

and is more particularly described as follows:

(a) N. 56° 30' W. 15.75 chains from the SE corner, Sec. 8, T. 10 S., R. 2 E. W. M.  
(Give distance and bearing to corner of section or other legal subdivision)

being within SE 1/4 of SE 1/4 of Sec. 8, Twp. 10 S., Rge. 2 W.  
(Smallest legal subdivision) (N. or S.) (E. or W.)

or (b) within limits of recorded platted property, town or city:

in Lot \_\_\_\_\_, Block \_\_\_\_\_ of \_\_\_\_\_  
(Name of plat or addition)

County of Linn  
(If within city or town, give name)

3. Construction Work was begun on 1947; was completed on May 10, 1947  
(Date) (Date)

and the ground water claimed was first used for the purposes set out below on May 15, 1947  
(Date)

since which time the water has been used continuously  
(Continuously or intermittently)

from May 15, 1947 to present time  
(Date) (Date)

4. Quantity of water claimed and used is 240 gallons per minute; 45 acre feet per year.

5. Purpose or Purposes for which water is used Irrigation

(Domestic, irrigation, municipal, manufacturing, industrial, etc.)

6. Description of Well: Depth 24 feet. Type driven  
(Dug or drilled)

diameter 4 inches. Elevation of ground at well site 270 feet, mean sea level.  
(As near as known)

Depth to water table 12 feet.

7. Capacity of Well: 450 g.p.m. with 16 feet drawdown.  
\_\_\_\_\_ g.p.m. with \_\_\_\_\_ feet drawdown.

Date of test Not tested

If Flowing Well: Measured discharge \_\_\_\_\_ g.p.m. on \_\_\_\_\_ (Date)

Shut-in pressure at ground surface \_\_\_\_\_ lbs. per sq. in. on \_\_\_\_\_ (Date)

Water is controlled by \_\_\_\_\_  
(Cap, valve, etc.)

GR-224 D





Township \_\_\_\_\_ Range \_\_\_\_\_ W.M.  
North

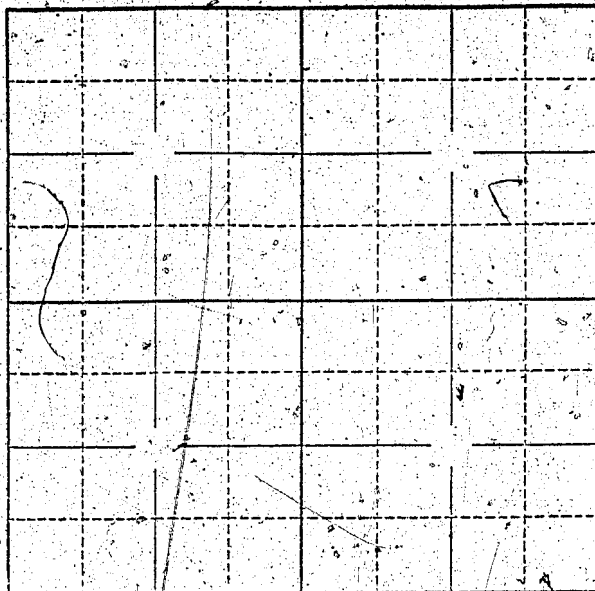

Locate well and acreage of irrigated land on plat.

Scale: 2" = 1 Mile

STATE OF OREGON

County of Linn } ss.

I, Wm. Upstead, being first duly sworn, do hereby certify that I have read the foregoing Registration Statement and that all of the items therein contained are true to the best of my knowledge and belief.

\_\_\_\_\_  
(Signature of Registrant)

Subscribed and sworn to before me this \_\_\_\_\_ day of \_\_\_\_\_, 19\_\_\_\_.

My commission expires \_\_\_\_\_  
(Notary Public)

(SEAL)

SEE PAGE GR-224, K FOR  
CERTIFICATE OF REGISTRATION

STATE OF OREGON

County of Marion } ss.

~~This is to certify that the foregoing Registration Statement was received in the office of the State Engineer on the X-X-X-X day of X-X-X-X-X-X-X-X, 19X-X, and has been duly recorded in said office in Book No. X-X-X-X-X-X of Registration Statements on page X-X-X-X-X-X. Construction was completed by X-X-X-X-X-X-X-X, 19X-X, and the water capacity applied to X-X-X-X-X-X by X-X-X-X-X-X-X-X, 19X-X.~~

Witness my hand this \_\_\_\_\_ day of \_\_\_\_\_, 19\_\_\_\_.

\_\_\_\_\_  
(State Engineer)

By \_\_\_\_\_  
(Deputy)

GR-224G



RECEIVED  
AUG 21 1956

STATE ENGINEER  
SALEM, OREGON



Registration Statement

REGISTRATION NO. GR-248

CERTIFICATE NO. GR-224

CLAIMANT OF RIGHT TO APPROPRIATE GROUND WATER

(Under Chapter 708, Oregon Laws 1955.)

TO THE STATE ENGINEER OF OREGON:

I, Wm. Upstad

of Jefferson County of Linn

State of Oregon do hereby make application for a certificate of registration as evidence of a right to appropriate ground water.

1. Source from which water is withdrawn is Pump Well No. 3  
(Flowing well, pump well, infiltration trench, or tunnel)

2. Location is: 3 1/2 miles east of Jefferson, Oregon  
(Approximate distance and direction from nearest city or town)

and is more particularly described as follows:

(a) N. 61° 30' E. 17.5 chains from the SW corner S. 8, T. 10 S., R. 2 W.W.M.  
(Give distance and bearing to corner of section or other legal subdivision)

being within SW 1/4 of SW 1/4 of Sec. 8 Twp. 10 S. Rge. 2 W.  
(Smallest legal subdivision) (N. or S.) (E. or W.)

or (b) within limits of recorded platted property, town or city:

in Lot \_\_\_\_\_, Block \_\_\_\_\_ of \_\_\_\_\_  
(Name of plat or addition)

County of Linn  
(If within city or town, give name)

3. Construction Work was begun on April 26, 1955; was completed on May 1, 1955  
(Date) (Date)

and the ground water claimed was first used for the purposes set out below on May 10, 1955  
(Date)

since which time the water has been used continuously  
(Continuously or intermittently)

from May 10, 1955 to present time  
(Date) (Date)

4. Quantity of water claimed and used is 200 gallons per minute; 45 acre feet per year.

5. Purpose or Purposes for which water is used Irrigation

(Domestic, irrigation, municipal, manufacturing, industrial, etc.)

6. Description of Well: Depth 21 feet. Type Drilled  
(Dug or drilled)

diameter 10 inches. Elevation of ground at well site 255 feet, mean sea level.  
(As near as known)

Depth to water table 12 feet.

7. Capacity of Well: 450 g.p.m. with 19 feet drawdown;  
\_\_\_\_\_ g.p.m. with \_\_\_\_\_ feet drawdown.

Date of test Not tested

If Flowing Well: Measured discharge \_\_\_\_\_ g.p.m. on \_\_\_\_\_  
(Date)

Shut-in pressure at ground surface \_\_\_\_\_ lbs. per sq. in. on \_\_\_\_\_  
(Date)

Water is controlled by \_\_\_\_\_  
(Cap, valve, etc.)

GR-224 H



If log of well is not available, give name and address of driller. Bill Hamilton, 838 E. 3rd Ave., Albany, Ore.

11. Infiltration Trench: Covered or open .....

Dimensions: Length ..... ft. Minimum depth ..... ft. Maximum depth ..... ft.

Bottom width ..... ft. Discharge ..... g.p.m. Date of test .....

12. Tunnel: Type of lining .....

Dimensions: .....  
(Length, course, and cross sectional size)

Position of water bearing stratum with reference to portal of tunnel .....

Log of tunnel: (Preceding table for log of well may be used, if desired. Give footage from portal and character of materials, as pertinent.)

13. Pumping Equipment:

(a) Pump 2 1/2" Berkeley Centrifugal Capacity 250 g.p.m.  
(Make, type and size)

(b) Motor 10 H.P.  
(Type and horsepower)

14. Location of area irrigated or to be irrigated, or place of use if for purposes other than irrigation.

Township North or South	Range E. or W. of Willamette Meridian	Section	Forty-acre Tract	Number Acres To Be Irrigated	Date of Reclamation
10 S	2 W.	8	NW 1/4 of SW 1/4	3.0	5-10-55
10 S	2 W.	8	SW 1/4 of SW 1/4	27.0	
				30.0	

Lots 5,6,7,8,9 and 10 in Section 8, T. 10 S., R 2 W. of the Will. Mer. in Linn County, Oregon

143-64

The undivided West half of the D.L.C. of H.H. King and wife Not. No. 6409 Cert No. 3975, T. 10 S., R 2 W. ~~tract~~ of the Will. Mer. in Linn County, Oregon that lies South of the present channel of the North Santiam River the same 140 acres, more or less, all in Marion County, Oregon

240-522

Commencing at the Southwest corner of William A. Starkweather's land Claim known as land claim 62 of the Government land survey and situated in T. 10 S., R 2 W. and running thence East 20 chains; thence North 40 chains thence West 20 chains; thence South 40 chains to the place of beginning and containing 80 acres in Linn County, State of Oregon. Excepting Beginning at the Southwest corner of Section 8 in T. 10 S., R 2 W. of the Will. Mer. in Linn County, Oregon; thence running East along said Section line 117.6 ~~xxx~~ rods to the place of beginning of the parcel to be described; thence running North 216.5 feet; thence East 175 feet; thence South 216.5 feet; thence West 175 feet to the place of beginning containing 7/8 of an acre, more or

15. If the ground water supply is supplemental to an existing water supply, identification of any application for a permit, permit, certificate or adjudicated right to appropriate water made or held by the registrant.

Township 10.5 Range 2.4 W.M.  
North

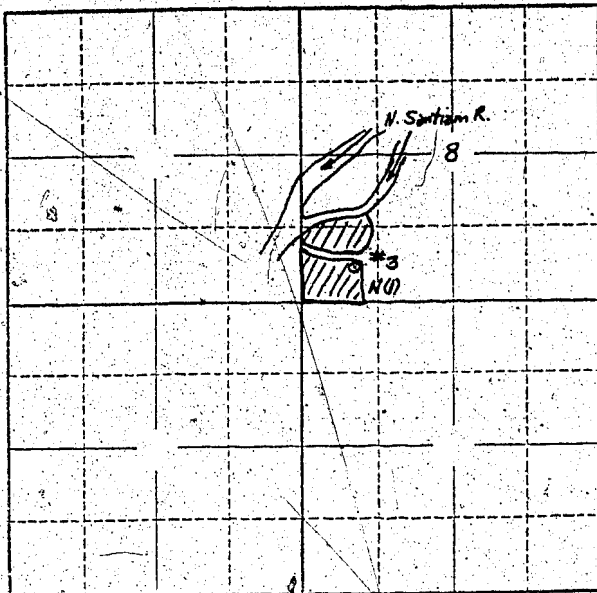

Locate well and acreage of irrigated land on plat.  
Scale: 2" = 1 Mile

STATE OF OREGON

County of Linn

ss.

I, Wm. Uppstad, being first duly sworn, do hereby certify that I have read the foregoing Registration Statement and that all of the items therein contained are true to the best of my knowledge and belief.

Wm. Uppstad  
(Signature of Registrant)

Subscribed and sworn to before me this 20th day of August, 1956.

My commission expires \_\_\_\_\_

R. M. Russell, Clerk  
(Notary Public)  
Geo. Magast, Deputy

(SEAL)

**CERTIFICATE OF REGISTRATION**

STATE OF OREGON

County of Marion

ss.

This is to certify that the foregoing Registration Statement was received in the office of the State Engineer on the 31st day of August, 1956, at 10 o'clock A. M. and has been duly recorded in said office in Book No. 2 of Registration Statements on page GR- 224 K

~~Construction shall be completed by X-X-X-X-X-X-X-X-X-X-X-X-X-X-X-X and the water completely applied to beneficial use by X-X-X-X-X-X-X-X-X-X-X-X-X-X-X-X~~

Witness my hand this 23rd day of November, 1956

Lewis A. Stanley  
(State Engineer)

By \_\_\_\_\_

(Deputy)

GR-224 K