

Well #1
\$ 15.00

Registration No. GR - 2494
Certificate No. GR 3361

Registration Statement

OF CLAIMANT OF RIGHT TO APPROPRIATE GROUND WATER

TO THE STATE ENGINEER OF OREGON:

1. Ruby Hayden Trustee

of 4535 Dallas Road County of Polk

State of Oregon, do hereby make application for a certificate of registration as evidence of a right to appropriate ground water.

1. Source from which water is withdrawn is pump well

2. Location is: 9 miles east of Jefferson, Oregon

and is more particularly described as follows:

(a) 23 E Ch. N. E. 8 Ch. W. from the SE corner of Sec. 23 being within the SE 1/4 SE 1/4

being within the S.W. corner of the Donation of Sec. 23, Twp. 9 S., Rge. 4 W.

or (b) within limits of recorded platted property, town or city:

in Lot _____, Block _____ of _____

County of _____

3. Construction Work was begun on May 13, 1948; was completed on May 15, 1948

and the ground water claimed was first used for the purposes set out below on May 30, 1948

since which time the water has been used intermittently

from May to August

4. Quantity of water claimed and used is 360 gallons per minute; 1 acre feet per year.

5. Purpose or Purposes for which water is used irrigation

6. Description of Well: Depth 30 feet. Type drilled

diameter 12 inches. Elevation of ground at well site 190 feet, mean sea level.

Depth to water table 16 feet.

7. Capacity of Well: 360 g.p.m. with 10 feet drawdown.

Date of test _____

If Flowing Well: Measured discharge _____ g.p.m. on _____

Shut-in pressure at ground surface _____ lbs. per sq. in. on _____

Water is controlled by _____

8. Casing: (Give diameter, commercial specifications and depth below ground surface of each casing size.)

.....inch diameter *Unknown* from to feet
..... inch diameter from to feet
..... inch diameter from to feet
..... inch diameter from to feet

Describe and show depth of shoe, plug, adapter, liner or other details:

9. Perforated Casings or Screens:

..... *Unknown* from to
(Number per foot and size of perforations, or describe screen)
..... from to
..... from to
..... from to

10. Log of Well: (Describe each stratum or formation clearly, indicate if water bearing, and give thickness and depth as indicated.)

MATERIAL	Thickness (Feet)	Depth to Bottom (Feet)
<i>Unknown</i>		

If log of well is not available, give name and address of driller. W. A. Kurina

11. Infiltration Trench: Covered or open _____
 Dimensions: Length _____ ft. Minimum depth _____ ft. Maximum depth _____ ft.
 Bottom width _____ ft. Discharge _____ g.p.m. Date of test _____

12. Tunnel: Type of lining _____
 Dimensions: _____
(Length, course, and cross sectional size)
 Position of water bearing stratum with reference to portal of tunnel _____

Log of tunnel: (Preceding table for log of well may be used, if desired. Give footage from portal and character of materials, as pertinent.)

13. Pumping Equipment:
 (a) Pump Built-in, 15 hsp. Capacity 360 g.p.m.
(Make, type and size)
 (b) Motor Electric, 15 hsp.
(Type and horsepower)

14. Location of area irrigated or to be irrigated, or place of use if for purposes other than irrigation.

Township North or South	Range E. or W. of Willamette Meridian	Section	Forty-acre Tract	Number Acres To Be Irrigated	Date of Reclamation
9 South	4 West	23		31	July 1, 1958
9 S	4 W	23	NE 1/4 SE 1/4	26 <u>0</u>	1948
"	"	"	NW 1/4 SE 1/4	12	"
"	"	"	SW 1/4 SE 1/4	0 <u>3</u>	"
"	"	"	SE 1/4 SE 1/4	1 <u>0</u>	"
				<u>29 1</u> Acres	"

15. If the ground water supply is supplemental to an existing water supply, identification of any application for a permit, permit, certificate or adjudicated right to appropriate water made or held by the registrant.

Township 9 S Range 4 W W.M.
North

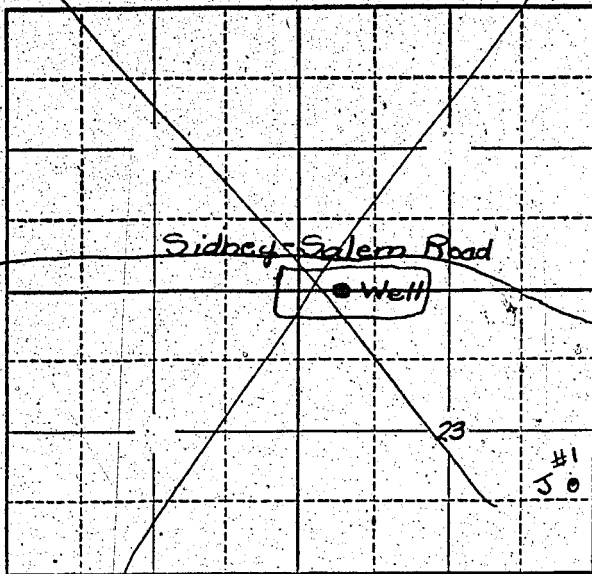

Locate well and acreage of irrigated land on plat.
Scale: 2" = 1 Mile

STATE OF OREGON

County of Marion } ss.

I, Ruby Hayden Trustee, being first duly sworn, do hereby certify that I have read the foregoing Registration Statement and that all of the items therein contained are true to the best of my knowledge and belief.

Ruby Hayden Trustee
(Signature of Registrant)

Subscribed and sworn to before me this 22nd day of July, 1958.

My commission expires Sept. 8, 1960

Charles E. [Signature]
(Notary Public)

(SEAL)

CERTIFICATE OF REGISTRATION

STATE OF OREGON } ss.
County of Marion

This is to certify that the foregoing Registration Statement was received in the office of the State Engineer on the 22nd day of July, 1958, at 10:30 o'clock A. M. and has been duly recorded in said office in Book No. 10 of Registration Statements on page GR-2361

Witness my hand this 10th day of March, 1959

Lewis A. Stanley
(State Engineer)

\$15.00

By _____
(Deputy)