

Registration Statement

OF CLAIMANT OF RIGHT TO APPROPRIATE GROUND WATER

(Under Chapter 708, Oregon Laws 1955.)

TO THE STATE ENGINEER OF OREGON:

I, Eugene Memorial Gardens, Inc.
of Eugene County of Lane

State of Oregon, do hereby make application for a certificate of registration as evidence of a right to appropriate ground water.

1. Source from which water is withdrawn is Pump well
(Flowing well, pump well, infiltration trench, or tunnel)

2. Location is: one mile south of Eugene
(Approximate distance and direction from nearest city or town)

and is more particularly described as follows: 1390 feet South & 2080 feet west from NE Corner Section 18. a subdivision of sunset Hills Memorial Gardens.

(a) N 15° W 925 feet from initial point of the Garden of Devotion as recorded in Book 19 of Town Plats, Lane County, Oregon
(City, village, or other legal subdivision)

being within SW 1/4 of NE 1/4 of Sec. 18, Twp. 18 S, Rge. 3 W
(Smallest legal subdivision) (N. or S.) (E. or W.)

or (b) within limits of recorded platted property, town or city:

in Lot _____, Block _____ of _____
(Name of plat or addition)
County of _____
(If within city or town, give name)

3. Construction Work was begun on June 1954; was completed on June 1954
(Date) (Date)

and the ground water claimed was first used for the purposes set out below on July 1954
(Date)

since which time the water has been used Intermittently
(Continuously or Intermittently)

from May to October
(Date) (Date)

4. Quantity of water claimed and used is 17 gallons per minute; one acre feet per year.

5. Purpose or Purposes for which water is used irrigation
(Domestic, irrigation, municipal, manufacturing, industrial, etc.)

6. Description of Well: Depth approx. 100 feet. Type Drilled
(Dug or drilled)

diameter eight inches. Elevation of ground at well site 550 feet, mean sea level.
(As near as known)

Depth to water table 80-100 feet.

7. Capacity of Well: 17 g.p.m. with total feet drawdown.
_____ g.p.m. with _____ feet drawdown.

Date of test June 1954

If Flowing Well: Measured discharge _____ g.p.m. on _____
(Date)

Shut-in pressure at ground surface _____ lbs. per sq. in. on _____
(Date)

Water is controlled by _____
(Cap, valve, etc.)

Township 18 S Range 3 W W.M.
North

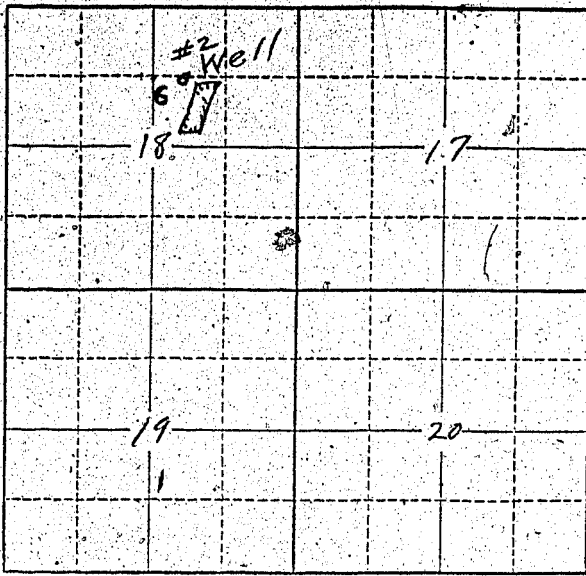

Locate well and acreage of irrigated land on plat.
Scale: 2" = 1 Mile

STATE OF OREGON

County of _____ } ss.

I, _____, being first duly sworn, do hereby certify that I have read the foregoing Registration Statement and that all of the items therein contained are true to the best of my knowledge and belief.

Eugene M. McLeod, Hardware
J. R. Emery
(Signature of Registrant)

Subscribed and sworn to before me this 22nd day of July, 19 58

My commission expires September 22, 1958

Eugene P. Gilmore
(Notary Public)

(SEAL)

CERTIFICATE OF REGISTRATION

STATE OF OREGON

County of Marion } ss.

This is to certify that the foregoing Registration Statement was received in the office of the State Engineer on the 23rd day of July, 19 58, at 11:00 o'clock A. M. and has been duly recorded in said office in Book No. 10 of Registration Statements on page GR-2369

~~Construction shall be completed by _____ and the water completely available to the beneficiaries by _____~~

Witness my hand this 10th day of March, 19 59

Lewis A. Stanley
(State Engineer)

\$ 15.00

By _____ (Deputy)

GR-2369