

RECEIVED
STATE ENGINEER
SALMON

Registration Statement

OF CLAIMANT OF RIGHT TO APPROPRIATE GROUND WATER

(Under Chapter 708, Oregon Laws 1955.)

TO THE STATE ENGINEER OF OREGON:

I, Rudolph Hoffner

of ~~Wadsworth~~ Junction City County of Benton

State of Oregon do hereby make application for a certificate of registration as evidence of a right to appropriate ground water.

1. Source from which water is withdrawn is Pump Well #2
(Flowing well, pump well, infiltration trench, or tunnel)

2. Location is: 4 miles East of Monroe
(Approximate distance and direction from nearest city or town)

and is more particularly described as follows:

(a) 55°41'W 178.90 ft from 1/2 cor on East line sec 25
(Give distance and bearing to corner of section or other legal subdivision)

being within NE 1/4 Sec 25 of Sec. 25, Twp. 14S, Rge. 5W
(Smallest legal subdivision) (N. or S.) (E. or W.)

or (b) within limits of recorded platted property, town or city:

in Lot _____ Block _____ of _____
(Name of plat or addition)

County of _____
(If within city or town, give name)

3. Construction Work was begun on 1951; was completed on 1951
(Date) (Date)

and the ground water claimed was first used for the purposes set out below on 1951
(Date)

since which time the water has been used continuously
(Continuously or intermittently)

from 1951 to 1956
(Date) (Date)

4. Quantity of water claimed and used is 450 gallons per minute; 20 acre feet per year.

5. Purpose or Purposes for which water is used Irrigation

(Domestic, irrigation, municipal, manufacturing, industrial, etc.)

6. Description of Well: Depth 26 feet. Type drilled
(Dug or drilled)

diameter 4 inches. Elevation of ground at well site 280 feet, mean sea level.
(As near as known)

Depth to water table 10 feet.

7. Capacity of Well: 450 g.p.m. with 5 feet drawdown.

_____ g.p.m. with _____ feet drawdown.

Date of test 1953

If Flowing Well: Measured discharge _____ g.p.m. on _____
(Date)

Shut-in pressure at ground surface _____ lbs. per sq. in. on _____
(Date)

Water is controlled by _____
(Cap, valve, etc.)

Township 195 Range 5W W.M.
North

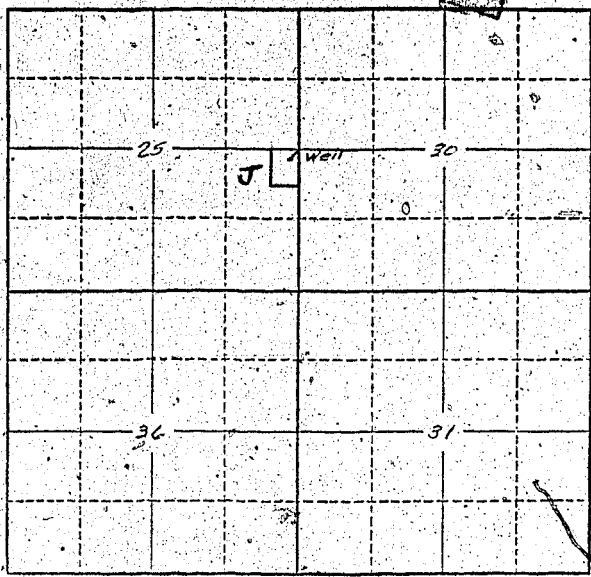

Locate well and acreage of irrigated land on plat.
Scale: 2" = 1 Mile

STATE OF OREGON
County of Marion } ss.

I, Rudolph Steffner, being first duly sworn, do hereby certify that I have read the foregoing Registration Statement and that all of the items therein contained are true to the best of my knowledge and belief.

Rudolph Steffner
(Signature of Registrant)

Subscribed and sworn to before me this 16th day of July, 1958.

My commission expires 12th June 1961
Wm. S. Baughman
(Notary Public)

(SEAL)

CERTIFICATE OF REGISTRATION

STATE OF OREGON
County of Marion } ss.

This is to certify that the foregoing Registration Statement was received in the office of the State Engineer on the 23 day of July, 1958, at 5:45 o'clock A. M. and has been duly recorded in said office in Book No. 10 of Registration Statements on page GR-2372

~~Witness my hand and the seal of the State Engineer on this 10th day of March 1959~~

Witness my hand this 10th day of March, 1959
Lewis A. Stanley
(State Engineer)

\$15.00

By _____
(Deputy)

GR- 2372