

RECEIVED
JUL 21 1949
STATE ENGINEER
SALMON DIVISION

Registration No. GR. - 2510
Certificate No. GR. 2377

Registration Statement

OF CLAIMANT OF RIGHT TO APPROPRIATE GROUND WATER

TO THE STATE ENGINEER OF OREGON:

I, Harry F. Lane

of Rte 1, Box 364, Wilsonville County of Clackamas
(Mailing address)

State of Oregon, do hereby make application for a certificate of registration as evidence of a right to appropriate ground water.

1. Source from which water is withdrawn is Pump well
(Flowing well, sump well, infiltration trench, or tunnel)

2. Location is: 2 miles north of Wilsonville.
(Approximate distance and direction from nearest city or town)

and is more particularly described as follows: 450 feet east & 200 feet north from SW corner Section 7.

(a) In S.W. corner of Lot 12 of Turner Little Farms
(Give distance and bearing to corner of section or other legal subdivision)

being within S.W. 1/4 of S.W. 1/4 of Sec. 7, Twp. 3 S. Rge. 1 E.
(Smallest legal subdivision) (N. or S.) (E. or W.)

or (b) within limits of recorded platted property, town or city:

in Lot _____ Block _____ of _____
(Name of plat or addition)

County of _____
(If within city or town, give name)

3. Construction Work was begun on July 10, 1949; was completed on July 25, 1949
(Date) (Date)

and the ground water claimed was first used for the purposes set out below on July 1950
(Date)

since which time the water has been used continuously
(Continuously or intermittently)

from July 25, 1949 to today
(Date) (Date)

4. Quantity of water claimed and used is 100 gallons per minute; _____ acre feet per year.

5. Purpose or Purposes for which water is used Irrigation of 40 acres of pasture and hay land for dairy, also for household use.
(Domestic, irrigation, municipal, manufacturing, industrial, etc.)
exempt

6. Description of Well: Depth 235 feet. Type drilled
(Dug or drilled)

diameter 5 O.D. inches. Elevation of ground at well site _____ feet, mean sea level.
(As near as known)

Depth to water table 68 feet.

7. Capacity of Well: 250 g.p.m. with unknown _____ feet drawdown, as inside of casing too small to accommodate measuring device.
_____ g.p.m. with _____ feet drawdown.

Date of test July, 1949. I ran ~~xxx~~ a 6" Peerless pump for 10 days in August, 1949, at 250 G.P.M. without letup. See note under paragraph 10.

If Flowing Well: Measured discharge _____ g.p.m. on _____
(Date)

Shut-in pressure at ground surface _____ lbs. per sq. in. on _____
(Date)

Water is controlled by _____
(Cap. valve, etc.)

Township 3 S Range 1 E, W.M.
North

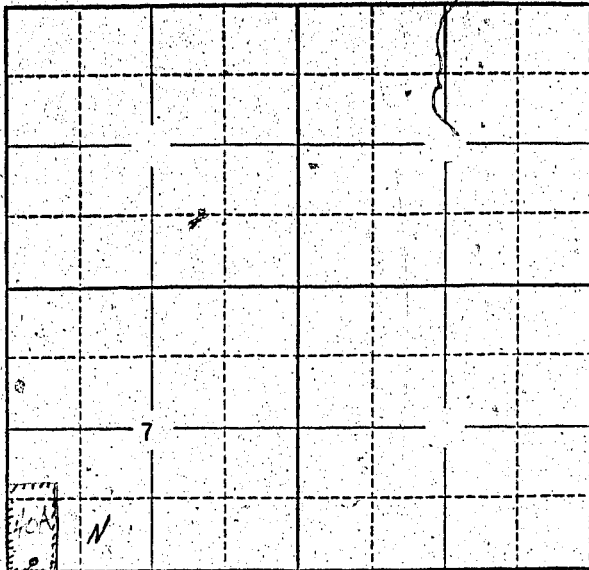

10.00
5.00
1.50
16.50

Locate well and acreage of irrigated land on plat.
Scale: 2" = 1 Mile

STATE OF OREGON

County of

ss.

I, Harry F. Lane, being first duly sworn, do hereby certify that I have read the foregoing Registration Statement and that all of the items therein contained are true to the best of my knowledge and belief.

Harry F. Lane
(Signature of Registrant)

Subscribed and sworn to before me this 22nd day of July, 1958

My commission expires

May 24, 1959

Wm. J. Crapp
(Notary Public)

(SEAL)

CERTIFICATE OF REGISTRATION

STATE OF OREGON

County of Marion

ss.

This is to certify that the foregoing Registration Statement was received in the office of the State Engineer on the 23 day of July, 1958, at 8:00 o'clock A.M. and has been duly recorded in said office in Book No. 10 of Registration Statements on page GR-2377

Witness my hand this 10th day of March

1959

Lewis A. Stanley
(State Engineer)

By

(Deputy)

GR 2377

16.50