



Registration No. GR - 2519

Certificate No. GR 2383

Registration Statement

OF CLAIMANT OF RIGHT TO APPROPRIATE GROUND WATER

TO THE STATE ENGINEER OF OREGON:

I, Guy Thompson

of Rt 3 Box 25 Milhan-Freewater County of Umatilla

State of Oregon do hereby make application for a certificate of registration as evidence of a right to appropriate ground water.

1. Source from which water is withdrawn is Pump Well
(Flowing well, pump well, infiltration trench, or tunnel)

2. Location is: 2 1/2 miles North West of Milhan-Freewater
(Approximate distance and direction from nearest city or town)

and is more particularly described as follows:

(a) 854 feet North & 24 feet West of E⁴ corner of Sec 33
(Give distance and bearing to corner of section or other legal subdivision)

being within SE⁴ of NE⁴ of Sec. 33 Twp. 6N Rge. 35 E
(Smallest legal subdivision) (N. or S.) (E. or W.)

or (b) within limits of recorded platted property, town or city:

in Lot _____, Block _____ of _____
(Name of plat or addition)

County of _____
(If within city or town, give name)

3. Construction Work was begun on 1915; was completed on 1915
(Date) (Date)

and the ground water claimed was first used for the purposes set out below on 1915
(Date)

since which time the water has been used Continuously
(Continuously or intermittently)

from May 1st 1915 to Sept 30, each year
(Date) (Date)

4. Quantity of water claimed and used is 400 gallons per minute; 400 acre feet per year.

5. Purpose or Purposes for which water is used Irrigation ~~Domestic~~
(Domestic, irrigation, municipal, manufacturing, industrial, etc.)

6. Description of Well: Depth 65 feet. Type Dug 45 - 20 feet Drilled
(Dug or drilled)

diameter 6' Dug - 8" Drill inches. Elevation of ground at well site 800 feet, mean sea level.
(As near as known)

Depth to water table 25 to 30 feet.

7. Capacity of Well: _____ g.p.m. with _____ feet drawdown.

_____ g.p.m. with _____ feet drawdown.

Date of test No Test

If Flowing Well: Measured discharge _____ g.p.m. on _____
(Date)

Shut-in pressure at ground surface _____ lbs. per sq. in. on _____
(Date)

Water is controlled by _____
(Cap, valve, etc.)

Township 6N Range 35E, W.M.
North

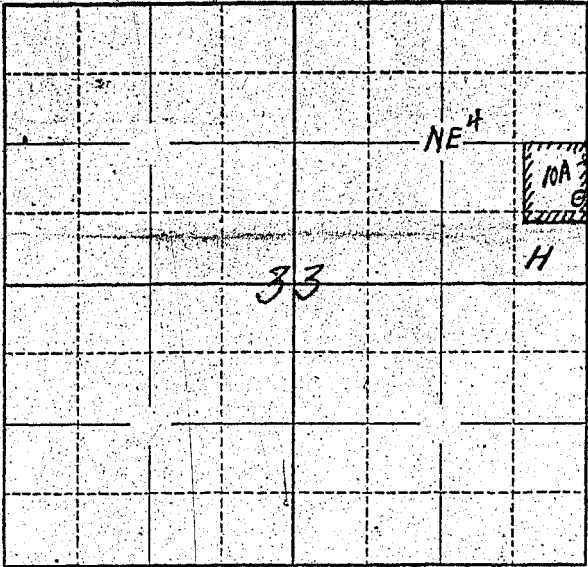

Locate well and acreage of irrigated land on plat.

Scale: ~~1/4~~ 4" - 1 Mile

STATE OF OREGON

County of Umatilla

} ss.

I, Guy Thompson, being first duly sworn, do hereby certify that I have read the foregoing Registration Statement and that all of the items therein contained are true to the best of my knowledge and belief.

Guy Thompson
(Signature of Registrant)

Subscribed and sworn to before me this 6th day of June, 19 58

My commission expires October 6, 1960.

D. K. Hodge
(Notary Public) for Oregon

(SEAL)

CERTIFICATE OF REGISTRATION

STATE OF OREGON

County of Marion

} ss.

This is to certify that the foregoing Registration Statement was received in the office of the State Engineer on the 23 day of July, 1958, at 8:00 o'clock A. M. and has been duly recorded in said office in Book No. 10 of Registration Statements on page GR-2383

Witness my hand this 10th day of March, 19 59

Laura A. Stanley
(State Engineer)

\$15.00

By _____ (Deputy)

GR - 2383