

Registration Statement

OF CLAIMANT OF RIGHT TO APPROPRIATE GROUND WATER

TO THE STATE ENGINEER OF OREGON:

I, Robert P. Branson

of P.O. Box 511, Central Point

County of Jackson

State of Oregon

, do hereby make application for a certificate of registration as evidence of a right to appropriate ground water.

1. Source from which water is withdrawn is pump well
(Flowing well, pump well, infiltration trench, or tunnel)

2. Location is: 3 miles North of Central Point
(Approximate distance and direction from nearest city or town)

and is more particularly described as follows:

(a) 189 feet North and 2187 feet East from the SW Cor. of DLC #52
(Give distance and bearing to corner of section or other legal subdivision)

being within NE $\frac{1}{4}$ NE $\frac{1}{4}$ SW $\frac{1}{4}$ of Sec. 28, Twp. 36S, Rge. 2W
(Smallest legal subdivision) (N. or S.) (E. or W.)

or (b) within limits of recorded platted property, town or city:

in Lot _____, Block _____ of _____
(Name of plat or addition)

County of _____
(If within city or town, give name)

3. Construction Work was begun on 1951; was completed on 1951
(Date) (Date)

and the ground water claimed was first used for the purposes set out below on 1951
(Date)

since which time the water has been used Continuously
(Continuously or Intermittently)

from 1951 to present
(Date) (Date)

4. Quantity of water claimed and used is 50 gallons per minute; 9.0 acre feet per year.

5. Purpose or Purposes for which water is used Irrigation

(Domestic, irrigation, municipal, manufacturing, industrial, etc.)

6. Description of Well: Depth 16 feet. Type drilled
(Dug or drilled)

diameter 8 inches. Elevation of ground at well site 1250 feet, mean sea level.
(As near as known)

Depth to water table 3.0 feet.

7. Capacity of Well: 50 g.p.m. with 9 feet drawdown.

_____ g.p.m. with _____ feet drawdown.

Date of test 1952

If Flowing Well: Measured discharge _____ g.p.m. on _____
(Date)

Shut-in pressure at ground surface _____ lbs. per sq. in. on _____
(Date)

Water is controlled by _____
(Cap, valve, etc.)

8. Casing: (Give diameter, commercial specifications and depth below ground surface of each casing size.)

..... inch diameter from to feet
 inch diameter from to feet
 inch diameter from to feet
 inch diameter from to feet

Describe and show depth of shoe, plug, adapter, liner or other details:

9. Perforated Casings or Screens:

(Number per foot and size of perforations, or describe screen) from to

..... from to

..... from to

..... from to

10. Log of Well: (Describe each stratum or formation clearly, indicate if water bearing, and give thickness and depth as indicated.)

MATERIAL	Thickness (Feet)	Depth to Bottom (Feet)
Top soil	3	13
Clay and sand	6	7
Course gravel (water bearing)	7	0

Township 36 S. Range 2 W., W.M.

North

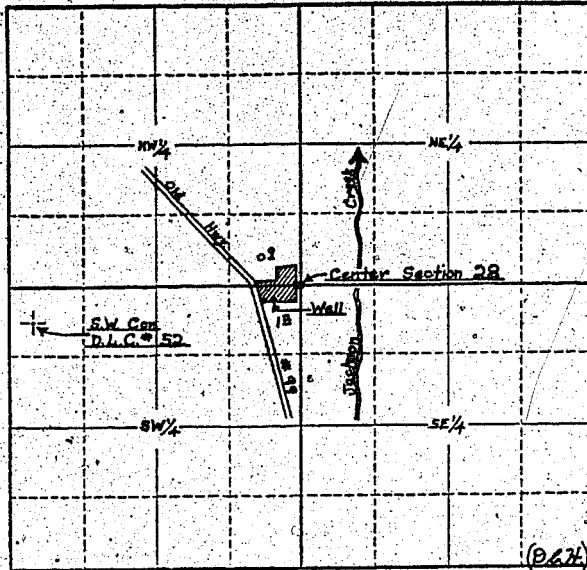

Locate well and acreage of irrigated land on plat.

Scale: 4" — 1 Mile

STATE OF OREGON

County of Jackson } ss.

I, Robert P. Branson, being first duly sworn, do hereby certify that I have read the foregoing Registration Statement and that all of the items therein contained are true to the best of my knowledge and belief.

Robert P. Branson
(Signature of Registrant)

Subscribed and sworn to before me this 22nd day of July, 1958.

My commission expires August 25, 1958

[Signature]
(Notary Public)

(SEAL)

CERTIFICATE OF REGISTRATION

STATE OF OREGON

County of Marion } ss.

This is to certify that the foregoing Registration Statement was received in the office of the State Engineer on the 23 day of July, 1958, at 8:00 o'clock A.M. and has been duly recorded in said office in Book No. 10 of Registration Statements on page GR 2397

Witness my hand this 16th day of March, 1959

[Signature]
(State Engineer)

1/5cc

By _____
(Deputy)

GR - 2397