

# Registration Statement

## OF CLAIMANT OF RIGHT TO APPROPRIATE GROUND WATER

TO THE STATE ENGINEER OF OREGON:

I, Cave Nielson  
of Rt 1 Box 426A, Woodburn County of Manion  
State of Oregon, do hereby make application for a certificate of registration as evidence of a right to appropriate ground water.

- 1. Source from which water is withdrawn is Pump Well  
(Flowing well, pump well, infiltration trench, or tunnel)
- 2. Location is: 6 miles NW of Jewels  
(Approximate distance and direction from nearest city or town)

and is more particularly described as follows:

(a) 600 feet west & 40 feet south from NE corner Section 19  
(Give distance and bearing to corner of section or other legal subdivision)  
being within NE 1/4 of NE 1/4 of Sec. 19, Twp. 5 S, Rge. 2 W  
(Smallest legal subdivision) (N. or S.) (E. or W.)

or (b) within limits of recorded platted property, town or city: \_\_\_\_\_

in Lot \_\_\_\_\_, Block \_\_\_\_\_ of \_\_\_\_\_  
(Name of plat or addition)

\_\_\_\_\_ County of \_\_\_\_\_  
(If within city or town, give name)

3. Construction Work was begun on Nov. 15, 1950 was completed on Dec. 1, 1950  
(Date) (Date)  
and the ground water claimed was first used for the purposes set out below on May, 1951  
(Date)  
since which time the water has been used intermittently during season  
(Continuously or intermittently)  
from 1951 to Oct. 1957  
(Date) (Date)

4. Quantity of water claimed and used is 170 gallons per minute; \_\_\_\_\_ acre feet per year.

5. Purpose or Purposes for which water is used irrigation  
(Domestic, irrigation, municipal, manufacturing, industrial, etc.)

6. Description of Well: Depth 95 feet. Type Drilled  
(Dug or drilled)  
diameter 8 inches. Elevation of ground at well site \_\_\_\_\_ feet, mean sea level.  
(As near as known)  
Depth to water table 0 feet.

7. Capacity of Well: 170 g.p.m. with 20 feet drawdown.  
\_\_\_\_\_ g.p.m. with \_\_\_\_\_ feet drawdown.

Date of test Dec. 5, 1951

If Flowing Well: Measured discharge 8 g.p.m. on Nov. 1950  
(Date)

Shut-in pressure at ground surface unk lbs. per sq. in. on \_\_\_\_\_  
(Date)

Water is controlled by Cap flows during winter mos.  
(Cap, valve, etc.)

8. Casing: (Give diameter, commercial specifications and depth below ground surface of each casing size.)

8 inch diameter steel casing from 0 to 95 feet  
 inch diameter from to feet  
 inch diameter from to feet  
 inch diameter from to feet

Describe and show depth of shoe, plug, adapter, liner or other details:

9. Perforated Casings or Screens:

yes from 82 to 95  
 (Number per foot and size of perforations, or describe screen)  
 from to  
 from to  
 from to

10. Log of Well: (Describe each stratum or formation clearly, indicate if water bearing, and give thickness and depth as indicated.)

MATERIAL	Thickness (Feet)	Depth to Bottom (Feet)
unknow - sands & gravels?		

If log of well is not available, give name and address of driller. H.E. Evans

Clear Lake, Oregon

11. Infiltration Trench: Covered or open \_\_\_\_\_  
 Dimensions: Length \_\_\_\_\_ ft. Minimum depth \_\_\_\_\_ ft. Maximum depth \_\_\_\_\_ ft.  
 Bottom width \_\_\_\_\_ ft. Discharge \_\_\_\_\_ g.p.m. Date of test \_\_\_\_\_

12. Tunnel: Type of lining \_\_\_\_\_  
 Dimensions: \_\_\_\_\_  
(Length, course, and cross sectional size)  
 Position of water bearing stratum with reference to portal of tunnel \_\_\_\_\_

Log of tunnel: (Preceding table for log of well may be used, if desired. Give footage from portal and character of materials, as pertinent.)

13. Pumping Equipment:  
 (a) Pump Gold, Centrifugal Capacity 120 g.p.m.  
(Make, type and size)  
 (b) Motor 3 phase 10 horsepower Electric  
(Type and horsepower)

14. Location of area irrigated or to be irrigated, or place of use if for purposes other than irrigation.

Township North or South	Range E. or W. of Willamette Meridian	Section	Forty-acre Tract	Number Acres To Be Irrigated	Date of Reclamation
<u>T5S</u>	<u>R2W</u>	<u>19</u>	<u>NE 1/4 of NE 1/4</u>	<u>36<sup>00</sup></u>	<u>1951</u>
<u>"</u>	<u>"</u>	<u>19</u>	<u>NW 1/4 of NE 1/4</u>	<u>2<sup>00</sup></u>	<u>"</u>
				<u>38<sup>00</sup></u>	<u>"</u>

15. If the ground water supply is supplemental to an existing water supply, identification of any application for a permit, permit, certificate or adjudicated right to appropriate water made or held by the registrant.

Township 55 Range 2W, W.M.  
North

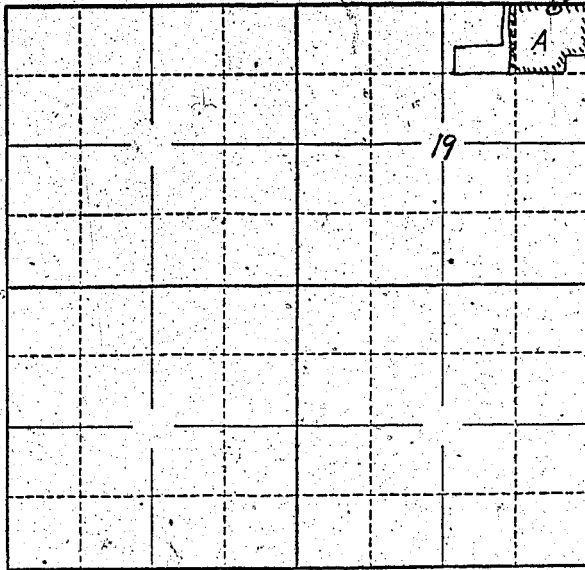

Locate well and acreage of irrigated land on plat.  
Scale: 2" = 1 Mile

STATE OF OREGON }  
County of Marion } ss.

I, \_\_\_\_\_, being first duly sworn, do hereby certify that I have read the foregoing Registration Statement and that all of the items therein contained are true to the best of my knowledge and belief.

Carl Nivler  
(Signature of Registrant)

Subscribed and sworn to before me this 23rd day of July, 1958

My commission expires 12th June 1961 Wm. S. Bartholomew  
(Notary Public)

(SEAL)

**CERTIFICATE OF REGISTRATION**

STATE OF OREGON }  
County of Marion } ss.

This is to certify that the foregoing Registration Statement was received in the office of the State Engineer on the 23rd day of July, 1958, at 12<sup>00</sup> o'clock A.M. and has been duly recorded in said office in Book No. 10 of Registration Statements on page GR-2409

Witness my hand this 16<sup>th</sup> day of March, 1959

Lewis A. Stankley  
(State Engineer)

By \_\_\_\_\_ (Deputy)

\$16.20

GR-2409