

Registration Statement

OF CLAIMANT OF RIGHT TO APPROPRIATE GROUND WATER

TO THE STATE ENGINEER OF OREGON:

I, Geo L Doray & Gladys E Doray
of #251^{RD1} Dayton County of Yamhill
(Mailing address)

State of Oregon, do hereby make application for a certificate of registration as evidence of a right to appropriate ground water.

- 1. Source from which water is withdrawn is Pump
(Flowing well, pump well, infiltration trench, or tubwell)
- 2. Location is: 3 1/2 miles south east
(Approximate distance and direction from nearest city or town)

and is more particularly described as follows:

(a) 1450' N & 600' W from SE corner Section 27
(Give distance and bearing to corner of section or other legal subdivision)
being within NE 1/4 SE 1/4 of Sec. 27, Twp. 4 S, Rge. 3 West
(Smallest legal subdivision) (N. or S.) (E. or W.)

or (b) within limits of recorded platted property, town or city:

in Lot _____, Block _____ of _____
(Name of plat or addition)

County of _____
(If within city or town, give name)

3. Construction Work was begun on _____; was completed on July 24 - 1939
(Date)
and the ground water claimed was first used for the purposes set out below on July 24 - 1939
(Date)
since which time the water has been used intermittently
(Continuously or intermittently)
from June to September
(Date) (Date)

4. Quantity of water claimed and used is 250 gallons per minute; _____ acre feet per year.

5. Purpose or Purposes for which water is used Irrigation

(Domestic, irrigation, municipal, manufacturing, industrial, etc.)

6. Description of Well: Depth 24 feet. Type drilled
(Dug or drilled)
diameter 12 inches. Elevation of ground at well site 72 feet, mean sea level.
(As near as known)
Depth to water table 8 to 9 feet.

7. Capacity of Well: _____ g.p.m. with 6ft feet drawdown.
_____ g.p.m. with 250. Per M - feet drawdown.

Date of test _____

If Flowing Well: Measured discharge _____ g.p.m. on _____
(Date)

Shut-in pressure at ground surface _____ lbs. per sq. in. on _____
(Date)

Water is controlled by _____
(Cap, valve, etc.)

8. Casing: (Give diameter, commercial specifications and depth below ground surface of each casing size.)

12" inch diameter: Steel from 0 to 23 feet
 inch diameter from to feet
 inch diameter from to feet
 inch diameter from to feet

Describe and show depth of shoe, plug, adapter, liner or other details:

9. Perforated Casings or Screens:

(Number per foot and size of perforations, or describe screen) from to
 Perforations from 11 to 23
 from to
 from to

10. Log of Well: (Describe each stratum or formation clearly, indicate if water bearing, and give thickness and depth as indicated.)

MATERIAL	Thickness (Feet)	Depth to Bottom (Feet)
Sand & soil	7	
Gravel and Sand	16	

If log of well is not available, give name and address of driller.

11. Infiltration Trench: Covered or open

Dimensions: Length ft. Minimum depth ft. Maximum depth ft.

Bottom width ft. Discharge g.p.m. Date of test

12. Tunnel: Type of lining

Dimensions:
(Length, course, and cross sectional size)

Position of water bearing stratum with reference to portal of tunnel

Log of tunnel: (Preceding table for log of well may be used, if desired. Give footage from portal and character of materials, as pertinent.)

13. Pumping Equipment:

(a) Pump Cent 4" x 3" Capacity 250 g.p.m.
(Make, type and size)

(b) Motor 22 HP Gasoline engine
(Type and horsepower)

14. Location of area irrigated or to be irrigated, or place of use if for purposes other than irrigation.

Township North or South	Range E. or W. of Willamette Meridian	Section	Forty-acre Tract	Number Acres To Be Irrigated	Date of Reclamation
4S	3W	27	NW $\frac{1}{4}$ SE $\frac{1}{4}$	6 ac	1939
"	"	"	NE $\frac{1}{4}$ SE $\frac{1}{4}$	24 ac	"
"	"	"	SE $\frac{1}{4}$ SE $\frac{1}{4}$	10	"
"	"	26	NW $\frac{1}{4}$ SW $\frac{1}{4}$	2	"
"	"	"	SW $\frac{1}{4}$ SW $\frac{1}{4}$	2	"
Total				44.0	

15. If the ground water supply is supplemental to an existing water supply, identification of any application for a permit, permit, certificate or adjudicated right to appropriate water made or held by the registrant.

E 1/2 Section 27 & W 1/2 Section 26

Township 4S Range 3W W.M.
North

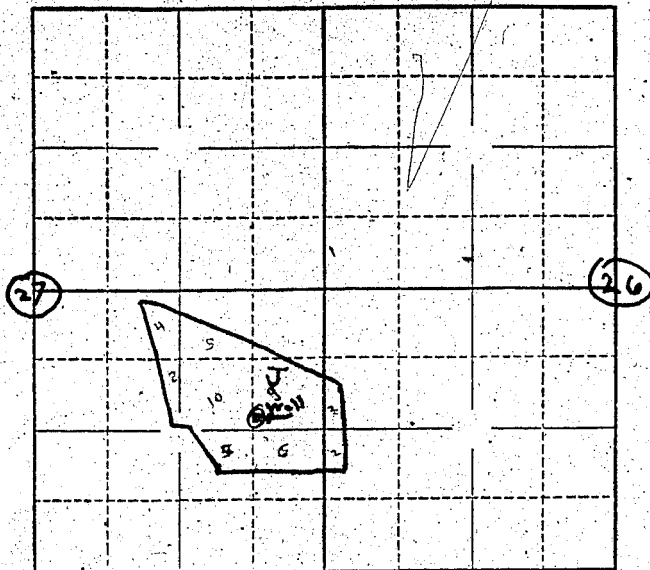

Locate well and acreage of irrigated land on plat.

Scale: 2" = 1 Mile

STATE OF OREGON

County of

Marion

ss.

I, Gladys L. Dorsey, being first duly sworn, do hereby certify that I have read the foregoing Registration Statement and that all of the items therein contained are true to the best of my knowledge and belief.

Gladys L. Dorsey
(Signature of Registrant)

Subscribed and sworn to before me this 23rd day of July, 1958

My commission expires

17th June 1961

Wm. S. Bartholomew
(Notary Public)

(SEAL)

CERTIFICATE OF REGISTRATION

STATE OF OREGON

County of Marion

ss.

This is to certify that the foregoing Registration Statement was received in the office of the State Engineer on the 23rd day of July, 1958, at 3:45 o'clock P. M. and has been duly recorded in said office in Book No. 11 of Registration Statements on page GR 2432

Witness my hand this 16th day of March, 1959

Leuris A. Stankovic
(State Engineer)

By

(Deputy)

\$17.10

GR - 2432