

Registration Statement

OF CLAIMANT OF RIGHT TO APPROPRIATE GROUND WATER

(Under Chapter 708, Oregon Laws 1955.)

TO THE STATE ENGINEER OF OREGON:

I, ROY E LOVE & LYDIA LOVE
of Woodburn County of Marion

State of Oregon, do hereby make application for a certificate of registration as evidence of a right to appropriate ground water.

1. Source from which water is withdrawn is Pumps well
(Flowing well, pump well, infiltration trench, or tunnel)

2. Location is: 400' N & 225' W of SE Corn 1 3/4 mi. North on Highway 99E
(Approximate distance and direction from nearest city or town) Woodburn

and is more particularly described as follows:

(a) 400' N & 225' W of SE Corner Section 5
(Give distance and bearing to corner of section or other legal subdivision)

being within SE 1/4 SE 1/4 of Sec. 5, Twp. 5 S, Rge. 1 W
(Smallest legal subdivision) (N. or S.) (E. or W.)

or (b) within limits of recorded platted property, town or city:

in Lot _____, Block _____ of _____
(Name of plat or addition)

County of _____
(If within city or town, give name)

3. Construction Work was begun on 4-5-1948; was completed on 4-8-1948
(Date) (Date)

and the ground water claimed was first used for the purposes set out below on 6-10-1948
(Date)

since which time the water has been used intermittently
(Continuously or intermittently)

from May 1 to Oct 1
(Date) (Date)

4. Quantity of water claimed and used is 100 gallons per minute; _____ acre feet per year.

5. Purpose or Purposes for which water is used Domestic & Irrigation

(Domestic, irrigation, municipal, manufacturing, industrial, etc.)

6. Description of Well: Depth 125 feet. Type Drilled
(Dug or drilled)

diameter 8 inches. Elevation of ground at well site 782 175 feet, mean sea level.
(As near as known)

Depth to water table 18 feet.

7. Capacity of Well: 100 g.p.m. with 85 feet drawdown.

79 g.p.m. with 60 feet drawdown.

Date of test 4-8-1948

If Flowing Well: Measured discharge _____ g.p.m. on _____
(Date)

Shut-in pressure at ground surface _____ lbs. per sq. in. on _____
(Date)

Water is controlled by _____
(Cap, valve, etc.)

8. Casing: (Give diameter, commercial specifications and depth below ground surface of each casing size.)

8 inch diameter from 0 to 125 feet
 inch diameter from to feet
 inch diameter from to feet
 inch diameter from to feet

Describe and show depth of shoe, plug, adapter, liner or other details:

9. Perforated Casings or Screens:

No Perforations from to
(Number per foot and size of perforations, or describe screen)
 from to
 from to
 from to

10. Log of Well: (Describe each stratum or formation clearly, indicate if water bearing, and give thickness and depth as indicated.)

MATERIAL	Thickness (Feet)	Depth to Bottom (Feet)
Surface	0 to 5	
yellow sandy clay	5 to 23	
Blue Clay	23 to 60	
yellow clay	60 to 63	
Blue clay	63 to 70	
Black Sand water	70 to 76	
Soft Sandy clay	76 to 88	
Black sand water	88 to 104	
Black sand some Gravel	104 to 120	
Gravel water	120 to 125	
Well was not pumped all water from Bottom Pipe set 125 ft 8" shoe on pipe. Pipe welded		
well tested 125 S.P.M. = 5 hrs test		

If log of well is not available, give name and address of driller.

11. Infiltration Trench: Covered or open

Dimensions: Length ft. Minimum depth ft. Maximum depth ft.

Bottom width ft. Discharge g.p.m. Date of test

12. Tunnel: Type of lining

Dimensions:
(Length, course, and cross sectional size)

Position of water bearing stratum with reference to portal of tunnel

Log of tunnel: (Preceding table for log of well may be used, if desired. Give footage from portal and character of materials, as pertinent.)

13. Pumping Equipment:

(a) Pump Cook - Turbine 4 in. Column Capacity 12.5 g.p.m.
(Make, type and size)

(b) Motor Cook 5 H.P.
(Type and horsepower)

14. Location of area irrigated or to be irrigated, or place of use if for purposes other than irrigation.

Township North or South	Range E. or W. of Willamette Meridian	Section	Forty-acre Tract	Number Acres To Be Irrigated	Date of Reclamation
55	1W	4	SW $\frac{1}{4}$ SW $\frac{1}{4}$	5	1948
"	"	5	SE $\frac{1}{4}$ SE $\frac{1}{4}$	27	1948
"	"	5	SW $\frac{1}{4}$ SE $\frac{1}{4}$	3	1948
				<u>Total</u> 35	

15. If the ground water supply is supplemental to an existing water supply, identification of any application for a permit, permit, certificate or adjudicated right to appropriate water made or held by the registrant.

Township 5 S Range 1 W, W.M.
North

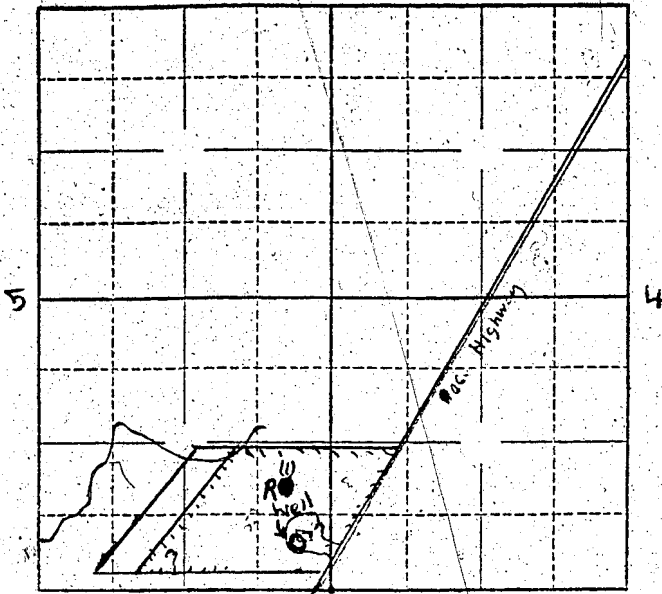

Locate well and acreage of irrigated land on plat.

Scale: $\frac{1}{4}$ " = 1 Mile

STATE OF OREGON

County of MARION } ss.

I, ROY E. LOVE & LUDIA LOVE, being first duly sworn, do hereby certify that I have read the foregoing Registration Statement and that all of the items therein contained are true to the best of my knowledge and belief.

Roy E Love
Ludlia Love
(Signature of Registrant)

Subscribed and sworn to before me this 21st day of SEPTEMBER, 1956

My commission expires 8-22-57 W B Madson
(Notary Public)

(SEAL)

CERTIFICATE OF REGISTRATION

STATE OF OREGON } ss.
County of Marion

This is to certify that the foregoing Registration Statement was received in the office of the State Engineer on the 21st day of September, 1956, at 4 o'clock P.M. and has been duly recorded in said office in Book No. 2 of Registration Statements on page GR-240-C

~~Construction shall be completed by 1-1-1957 and the 10% deposit applied to~~
~~the balance by 1-1-1957~~

Witness my hand this 15th day of January, 1957

Clara A Stanley
(State Engineer)

By _____
(Deputy)

GR-240C