

Registration Statement

OF CLAIMANT OF RIGHT TO APPROPRIATE GROUND WATER

TO THE STATE ENGINEER OF OREGON:

I, Top O' Scott Golf Course

of 12000 S.E. Stevens Road Portland, Ore. County of Clackamas

State of Oregon, do hereby make application for a certificate of registration as evidence of a right to appropriate ground water.

1. Source from which water is withdrawn is Pump Well
(Flowing well, pump well, infiltration trench, or tunnel)

2. Location is: 12000 S.E. Stevens Road, Portland, Oregon
(Approximate distance and direction from nearest city or town)

and is more particularly described as follows:

(a) 1410 feet north & 1050 feet west from S.E. corner Section 33
(Give distance and bearing to corner of section or other legal subdivision)

being within N.E. 1/4 S.E. 1/4 of Sec. 33, Twp. 1 South, Rge. 2 East
(Smallest legal subdivision) (N. or S.) (E. or W.)

or (b) within limits of recorded platted property, town or city:

in Lot _____, Block _____ of _____
(Name of plat or addition)

County of _____
(If within city or town, give name)

3. Construction Work was begun on March 1, 1928; was completed on July 3, 1928
(Date) (Date)

and the ground water claimed was first used for the purposes set out below on Unknown
(Date)

since which time the water has been used Intermittently
(Continuously or Intermittently)

from May 1 to October 1
(Date) (Date)

4. Quantity of water claimed and used is 430 gallons per minute; _____ acre feet per year.

5. Purpose or Purposes for which water is used Irrigation

(Domestic, irrigation, municipal, manufacturing, industrial, etc.)

6. Description of Well: Depth 353 feet. Type Drilled

(Dug or drilled)

diameter 10 inches. Elevation of ground at well site 280' feet, mean sea level.
(As near as known)

Depth to water table 183 feet.

7. Capacity of Well: _____ g.p.m. with _____ feet drawdown.

_____ g.p.m. with _____ feet drawdown.

Date of test Unknown

If Flowing Well: Measured discharge _____ g.p.m. on _____
(Date)

Shut-in pressure at ground surface _____ lbs. per sq. in. on _____
(Date)

Water is controlled by _____
(Cap, valve, etc.)

Township 1 S Range 2 E W.M.
North

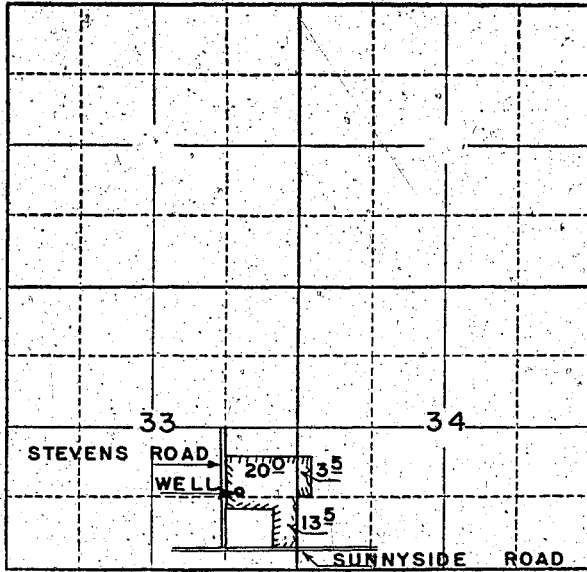

Locate well and acreage of irrigated land on plat.
Scale: 2" = 1 Mile

STATE OF OREGON

County of Clackamas

} ss.

I, Payson B. Tibbetts, being first duly sworn, do hereby certify that I have read the foregoing Registration Statement and that all of the items therein contained are true to the best of my knowledge and belief.

Payson B. Tibbetts, Partner
Top of Scott Golf Course

Subscribed and sworn to before me this 22nd day of July, 1958.

My commission expires Jan 25, 1959

G. L. French
(Notary Public)

(SEAL)

CERTIFICATE OF REGISTRATION

STATE OF OREGON

County of Marion

} ss.

This is to certify that the foregoing Registration Statement was received in the office of the State Engineer on the 24 day of July, 1958, at 8:00 o'clock A.M. and has been duly recorded in said office in Book No. 11 of Registration Statements on page GR-2467

Witness my hand this 6th day of April, 1959

Laura A. Stanley
(State Engineer)

By _____
(Deputy)

GR - 2467

#16-05