

Registration Statement

OF CLAIMANT OF RIGHT TO APPROPRIATE GROUND WATER

TO THE STATE ENGINEER OF OREGON:

I, Harley R. Miller

of P. O. Box 195 Glendale County of Douglas
(Mailing address)

State of Oregon do hereby make application for a certificate of registration as evidence of a right to appropriate ground water.

1. Source from which water is withdrawn is drill well
(Flowing well, pump well, infiltration trench, or tunnel)

2. Location is: in Glendale
(Approximate distance and direction from nearest city or town)

and is more particularly described as follows: Place of beginning north east 299.0 ft. to

About 950 feet west of 720 feet Well of SE Corner Section 32.
(a) the well, thence southeast corner 234.08 ft north thence 252.02
(Give distance and bearing to corner of section or other legal subdivision) ft west to well.
being within part of the southeast quarter of Sec. 32, Twp. 32 S, Rge. R 6 W
(Smallest legal subdivision) (N. or S.) (E. or W.)

or (b) within limits of recorded platted property, town or city:

in Lot _____, Block _____ of faces on 6th St. in the town of Glendale
(Name of plat or addition)

County of _____
(If within city or town, give name)

3. Construction Work was begun on May, 1955; was completed on May, 1955
(Date) (Date)

and the ground water claimed was first used for the purposes set out below on right way 1955
(Date)

since which time the water has been used intermittently
(Continuously or intermittently)

from May, 1955 to present time
(Date) (Date)

4. Quantity of water claimed and used is 1 1/2 gallons per minute; _____ acre feet per year.

5. Purpose or Purposes for which water is used irrigation

(Domestic, irrigation, municipal, manufacturing, industrial, etc.)

6. Description of Well: Depth 65 feet. Type drilled
(Dug or drilled)

diameter 12 inches. Elevation of ground at well site 1120 feet, mean sea level.
(As near as known)

Depth to water table 5 feet.

7. Capacity of Well: _____ g.p.m. with _____ feet drawdown.

_____ g.p.m. with _____ feet drawdown.

Date of test May, 1955

If Flowing Well: Measured discharge 126 g.p.m. on May, 1955
(Date)

Shut-in pressure at ground surface _____ lbs. per sq. in. on _____
(Date)

Water is controlled by _____
(Cap. valve, etc.)

If log of well is not available, give name and address of driller. Collman Well Drillers, Grants Pass, Oregon

11. Infiltration Trench: Covered or open _____

Dimensions: Length _____ ft. Minimum depth _____ ft. Maximum depth _____ ft.

Bottom width _____ ft. Discharge _____ g.p.m. Date of test _____

12. Tunnel: Type of lining _____

Dimensions: _____
(Length, course, and cross sectional size)

Position of water bearing stratum with reference to portal of tunnel _____

Log of tunnel: (Preceding table for log of well may be used, if desired. Give footage from portal and character of materials, as pertinent.)

13. Pumping Equipment:

(a) Pump 3 in. centrifugal _____ Capacity 100 _____ g.p.m.
(Make, type and size)

(b) Motor Westinghouse 5-horse power Electric _____
(Type and horsepower)

14. Location of area irrigated or to be irrigated, or place of use if for purposes other than irrigation.

Township North or South	Range E. or W. of Williams Meridian	Section	Forty-acre Tract	Number Acres To Be Irrigated	Date of Reclamation
LEGAL DESCRIPTION: A part of the southeast quarter of Section 32, Twp. 32 S R 6 W, containing 8.88 acres and more particularly described as follows, to-wit: Beginning at a point located 1270.86 feet west and 517.04 feet north of the southeast corner of Section 32, Twp. 32 S, R 6 W; running thence north a distance of 622.28 feet to a point; thence east a distance of 546.0 feet to a point on the south bank of Cow Creek; thence south 14 degrees 22" east a distance of 294.06 feet to a point on a line 30 feet distant and parallel to a certain trunk sewer line extended; thence south 23 degrees 30" west along said sewer right of way line a distance of 602.0 feet to a point; thence west a distance of 359.65 feet to a point; thence north a distance of 206.65 feet to a point; thence north 67 degrees 05" west a distance of 21.07 feet to the place of beginning, Douglas County, Oregon.					
T32S	R6W	32	SE 1/4 + SE 1/4	8.88 Ac	1955

15. If the ground water supply is supplemental to an existing water supply, identification of any application for a permit, permit, certificate or adjudicated right to appropriate water made or held by the registrant.

Township 32 S Range 6 W, W.M.
North

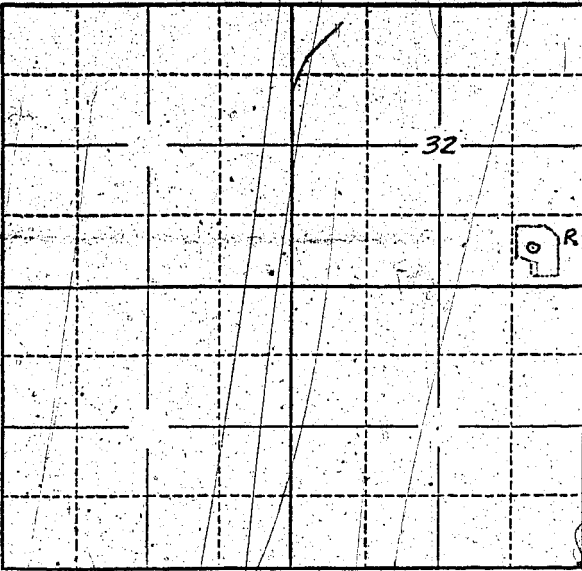

Locate well and acreage of irrigated land on plat.
Scale: 2" = 1 Mile

STATE OF OREGON

County of Josephine } ss.

I, Harley A. Miller, being first duly sworn, do hereby certify that I have read the foregoing Registration Statement and that all of the items therein contained are true to the best of my knowledge and belief.

Harley A. Miller
(Signature of Registrant)

Subscribed and sworn to before me this 11th day of July, 1958.

My commission expires 2/27/61

Mayorie Green
(Notary Public)

(SEAL)

CERTIFICATE OF REGISTRATION

STATE OF OREGON

County of Marion } ss.

This is to certify that the foregoing Registration Statement was received in the office of the State Engineer on the 24 day of July, 1954, at 7:00 o'clock A. M. and has been duly recorded in said office in Book No. 11 of Registration Statements on page GR-2497

Witness my hand this 6th day of April, 1959

Stuart G. Stanley
(State Engineer)

By _____ (Deputy)

\$15.00