

Registration Statement

OF CLAIMANT OF RIGHT TO APPROPRIATE GROUND WATER

TO THE STATE ENGINEER OF OREGON:

I, Henry Hausch and Julia E. Hausch dba ROSEWAY NURSERIES

of 2935 S.W. 234th Ave., Beaverton, Oregon County of Washington

State of Oregon, do hereby make application for a certificate of registration as evidence of a right to appropriate ground water.

1. Source from which water is withdrawn is Pump Well
(Flowing well, pump well, infiltration trench, or tunnel)

2. Location is: 3 miles East of Hillsboro
(Approximate distance and direction from nearest city or town)

and is more particularly described as follows:

(a) 2530 Feet West and 100 feet north of the 1/4 corner on the East line of said Sec. 10
(Give distance and bearing to corner of section or other legal subdivision)

being within SW 1/4 of N. E. 1/4 of Sec. 10, Twp. 1 S, Rge. 2 W
(Smallest legal subdivision)

or (b) within limits of recorded platted property, town or city:

in Lot _____, Block _____ of _____
(Name of plat or addition)

County of Washington
(If within city or town, give name)

3. Construction Work was begun on July 1, 1954; was completed on July 31, 1954
(Date) (Date)

and the ground water claimed was first used for the purposes set out below on June 1955
(Date)

since which time the water has been used intermittently
(Continuously or intermittently)

from June 5th, 1955 to July 24th, 1958
(Date) (Date)

4. Quantity of water claimed and used is 110 gallons per minute; _____ acre feet per year.

5. Purpose or Purposes for which water is used irrigation
(Domestic, irrigation, municipal, manufacturing, industrial, etc.)

6. Description of Well: Depth 191 feet. Type Drilled (rotary)
(Dug or drilled)

diameter 10" inches. Elevation of ground at well site 48 feet, mean sea level.
(As near as known)

Depth to water table 15 feet.

7. Capacity of Well: 110 g.p.m. with 165 feet drawdown after 4 hours

_____ g.p.m. with _____ feet drawdown.

Date of test July 1954

If Flowing Well: Measured discharge _____ g.p.m. on _____
(Date)

Shut-in pressure at ground surface _____ lbs. per sq. in. on _____
(Date)

Water is controlled by _____
(Cap, valve, etc.)

8. Casing: (Give diameter, commercial specifications and depth below ground surface of each casing size.)

2 1/2" inch diameter (Gage 1/4 in wall) from 0 to 40 feet
10" inch diameter (Gage .328) from 0 to 191 feet
inch diameter from to feet
inch diameter from to feet

Describe and show depth of shoe, plug, adapter, liner or other details:
.....
.....

9. Perforated Casings or Screens:

Torch perforations 1/8" x 12" 4 per foot from 150 to 191
(Number per foot and size of perforations, or describe screen)
from to
from to
from to

10. Log of Well: (Describe each stratum or formation clearly, indicate if water bearing, and give thickness and depth as indicated.)

MATERIAL	Thickness (Feet)	Depth to Bottom (Feet)
brown & blue sandy clay	0	92
brown clay	92	168
sand & gravel	168	173
blue sand	173	183
blue x clay	183	191

If log of well is not available, give name and address of driller. A. M. Janssen Drilling Co.
21075 S.W. Tualatin Hy., Monah, Ore.
 (copy of water well report attached)

11. Infiltration Trench: Covered or open
 Dimensions: Length ft. Minimum depth ft. Maximum depth ft.
 Bottom width ft. Discharge g.p.m. Date of test

12. Tunnel: Type of lining
 Dimensions:
 (Length, course, and cross sectional size)
 Position of water bearing stratum with reference to portal of tunnel

Log of tunnel: (Preceding table for log of well may be used, if desired. Give footage from portal and character of materials, as pertinent.)

13. Pumping Equipment:
 (a) Pump 4" X 4" 12 STAGE LINE SHAFT TURBINE Capacity 10.5 g.p.m.
 (Type, make, and size)
 (b) Motor 15 HP Hollow Shaft General Electric
 (Type and horsepower) MOTOR

14. Location of area irrigated or to be irrigated, or place of use if for purposes other than irrigation.

Township North or South	Range E. or W. of Willamette Meridian	Section	Forty-acre Tract	Number Acres To Be Irrigated	Date of Reclamation
1 S	2 W	10	SW 1/4 NE 1/4	4.6	June 1955
1 S	2 W	10	SE 1/4 NE 1/4	0.5	" "
1 S	2 "W	10	SW 1/4 NW 1/4	1.6	" "
1 S	2 W	10	SE 1/4 NW 1/4	10.0	" "
"	"	10	NE 1/4 SW 1/4	23.0	" "
"	"	10	NW 1/4 SW 1/4	7.5	" "
"	"	10	NE 1/4 SE 1/4	5.0	" "
"	"	10	NW 1/4 SE 1/4	24.0	" "
				<u>76.2</u>	" "

15. If the ground water supply is supplemental to an existing water supply, identification of any application for a permit, permit, certificate or adjudicated right to appropriate water made or held by the registrant.

Township 1 S Range 2 W, WM
North

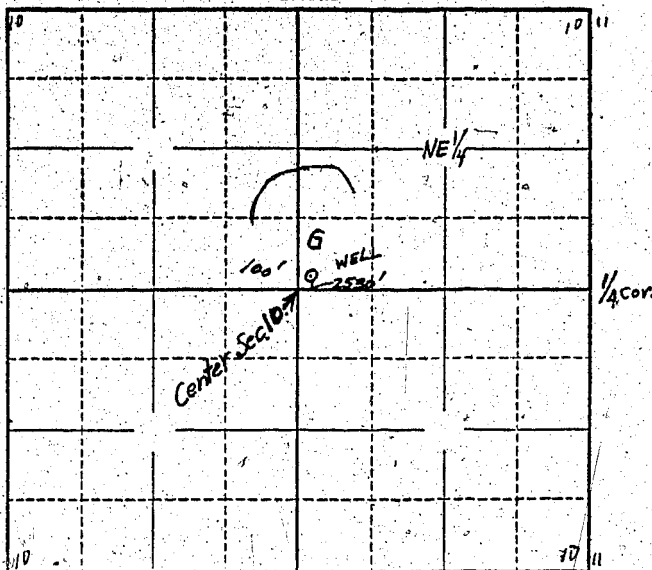

Locate well and acreage of irrigated land on plat.

Scale: 1 Mile

4"

STATE OF OREGON

County of Marion } ss.

I, Julia E. Hausch, being first duly sworn, do hereby certify that I have read the foregoing Registration Statement and that all of the items therein contained are true to the best of my knowledge and belief.

Julia E. Hausch
(Signature of Registrant)

Subscribed and sworn to before me this 24th day of July, 1958

My commission expires 12th June 1961

Wm. G. Bartholomew
(Notary Public)

(SEAL)

CERTIFICATE OF REGISTRATION

STATE OF OREGON

County of Marion } ss.

This is to certify that the foregoing Registration Statement was received in the office of the State Engineer on the 24th day of July, 1958, at 3:15 o'clock P. M. and has been duly recorded in said office in Book No. 11 of Registration Statements on page GR 2516

Witness my hand this 6th day of April, 1959

Lewis A. Stanley
(State Engineer)

By _____ (Deputy)

\$ 22.05

GR - 2516