

RECEIVED
JUL 17 1958
STATE ENGINEER
SALEM, OREGON

Registration Statement

REGISTRATION NO. GR-2666
CERTIFICATE NO. GR-2527

OF CLAIMANT OF RIGHT TO APPROPRIATE GROUND WATER (Under Chapter 708, Oregon Laws 1955.)

TO THE STATE ENGINEER OF OREGON:

I, Harvey Barnard

of Rt. 1, Box 40, Estacada County of Clackamas

State of Oregon do hereby make application for a certificate of registration as evidence of a right to appropriate ground water.

1. Source from which water is withdrawn is pump well
(Flowing well, pump well, infiltration trench, or tunnel)

2. Location is: 2 miles northerly from Estacada
(Approximate distance and direction from nearest city or town)

and is more particularly described as follows:

(a) N. 50° 54' E. 1348' from angle corner in the south
(Give distance and bearing to corner of section or other legal subdivision)
being within S.E. 1/4 of N.W. 1/4 of Sec. 8, Twp. 3 S, Rge. 4 E
(Smallest legal subdivision) (N. or S.) (E. or W.)

or (b) within limits of recorded platted property, town or city:

in Lot _____ Block _____ of _____
(Name of plat or addition)
County of Clackamas

(If within city or town, give name)
3. Construction Work was begun on March 1, 1951; was completed on Feb 10, 1957
(Date) (Date)

and the ground water claimed was first used for the purposes set out below on July 18, 1951
(Date)

since which time the water has been used Intermittently
(Continuously or intermittently)

from July 18, 1951 to July 16, 1958
(Date) (Date)

4. Quantity of water claimed and used is 125 gallons per minute; 45 acre feet per year.

5. Purpose or Purposes for which water is used IRRIGATION
(Domestic, irrigation, municipal, manufacturing, industrial, etc.)

6. Description of Well: Depth 500 feet. Type Drilled
(Dug or drilled)
diameter 6 5/8" inches. Elevation of ground at well site 414 feet, mean sea level.
(As near as known)
Depth to water table 93 feet.

7. Capacity of Well: 125 g.p.m. with 2.5 feet drawdown.
_____ g.p.m. with _____ feet drawdown.

Date of test 4/6/57

If Flowing Well: Measured discharge _____ g.p.m. on _____
(Date)

Shut-in pressure at ground surface _____ lbs. per sq. in. on _____
(Date)

Water is controlled by _____
(Cap, valve, etc.)

8. Casing: (Give diameter, commercial specifications and depth below ground surface of each casing size.)

12" inch diameter from 0 to 67 feet
8" inch diameter from 56 to 276 feet
open 8" inch diameter from 276 to 500 feet
Feb 1927
6 7/8 inch diameter 13# pipe from 0 to 284 feet

Describe and show depth of shoe, plug, adapter, liner or other details: belled out to 7 1/8" on bottom and cemented into the rock with neat cement.

9. Perforated Casings or Screens:

Six inch 300 perforated with Mills Knife perforator from to
(Number per foot and size of perforations, or describe screen)
Four perforations per foot 1/4" wide from 57' to 65'
by 1 1/2" long from to

10. Log of Well: (Describe each stratum or formation clearly, indicate if water bearing, and give thickness and depth as indicated.)

MATERIAL	Thickness (Feet)	Depth to Bottom (Feet)

If log of well is not available, give name and address of driller. A. M. Jannsen
Aloha, Oreg. - Steinman Bros. Power Rad-well, Feb 1957

11. Infiltration Trench: Covered or open
 Dimensions: Length ft. Minimum depth ft. Maximum depth ft.
 Bottom width ft. Discharge g.p.m. Date of test

12. Tunnel: Type of lining
 Dimensions:
(Length, course, and cross sectional size)
 Position of water bearing stratum with reference to portal of tunnel

Log of tunnel: (Preceding table for log of well may be used, if desired. Give footage from portal and character of materials, as pertinent.)

13. Pumping Equipment:
 (a) Pump E.M. Pomona Fig 6970 Capacity 125 g.p.m.
(Make, type and size)
 (b) Motor Roland 15HP 1800 RPM 3PH 60cy 220alt 59 Cages
(Type and horsepower)

14. Location of area irrigated or to be irrigated, or place of use if for purposes other than irrigation.

Township North or South	Range E. or W. of Willamette Meridian	Section	Forty-acre Tract	Number Acres To Be Irrigated	Date of Reclamation
<i>Supplemental to surface waters covered by permit # 21693 and located by tie shown on map of that permit.</i>					
T3S	R4E	8	SW 1/4 of NW 1/4 SE 1/4 of NW 1/4	20.2	1951
"	"	"	SW 1/4 of NW 1/4	15.5	"
"	"	"	NW 1/4 of SW 1/4	2.4	"
"	"	"	NE 1/4 of SW 1/4	3.0 4.0	"
"	"	"	SW 1/4 of NE 1/4	31.6	"
"	"	"	SE 1/4 of NE	10.2	"
"	"	"	NW 1/4 of SE 1/4	30.4	"
"	"	"	NE 1/4 of SE 1/4	19.2	"
				137.4	"

15. If the ground water supply is supplemental to an existing water supply, identification of any application for a permit, certificate or adjudicated right to appropriate water made or held by the registrant.
permit # 21693

Township 35 Range 4E, W.M.
North

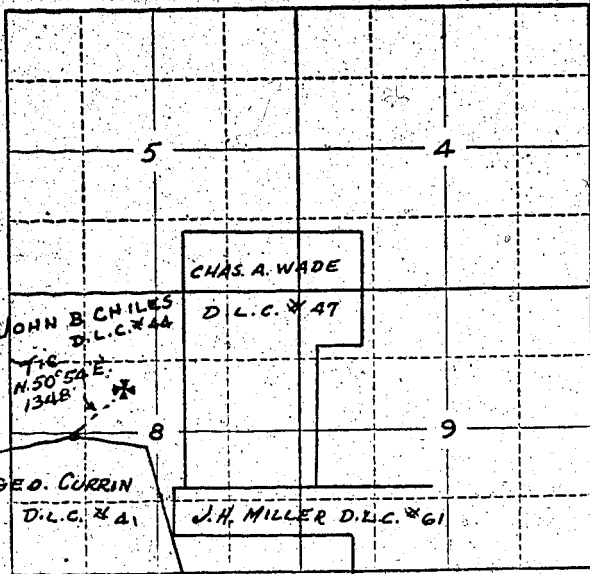

See map with permit # 21693 for irrigated areas

STATE OF OREGON }
County of Multnomah } ss.

I, Harvey Barnard, being first duly sworn, do hereby certify that I have read the foregoing Registration Statement and that all of the items therein contained are true to the best of my knowledge and belief.

Harvey Barnard
(Signature of Registrant)

Subscribed and sworn to before me this 16th day of July, 19 58

My commission expires May 3, 1962

Bertie D. Bodin
(Notary Public)

(SEAL)

CERTIFICATE OF REGISTRATION

STATE OF OREGON }
County of Marion } ss.

This is to certify that the foregoing Registration Statement was received in the office of the State Engineer on the 25th day of July, 1958, at 8:30 o'clock A.M. and has been duly recorded in said office in Book No. 11 of Registration Statements on page GR-2527

~~Construction shall be completed by _____ 19____ and the water completely applied to the following by _____ 19____.~~

Witness my hand this 6th day of April, 19 59

Lura M. Starnes
(State Engineer)

By _____
(Deputy)

GR-2527