

RECEIVED
JUL 25 1952
STATE ENGINEER
SALMON

Registration No. GR. 2669

Certificate No. GR. 2531

Registration Statement

OF CLAIMANT OF RIGHT TO APPROPRIATE GROUND WATER

TO THE STATE ENGINEER OF OREGON:

I, Kenneth L. Harman

of Route 2, Box 493, Albany County of Linn
(Mailing address)

State of Oregon, do hereby make application for a certificate of registration as evidence of a right to appropriate ground water.

1. Source from which water is withdrawn is pump well
(Flowing well, pump well, infiltration trench, or tunnel)

2. Location is: eight miles NE of Albany, Oregon
(Approximate distance and direction from nearest city or town)

and is more particularly described as follows:

(a) N. 52° E. 6.5 chains from SW corner of S. 29, T.10S, R.2W
(Give distance and bearing to corner of section or other legal subdivision)

being within SW $\frac{1}{4}$ of SW $\frac{1}{4}$ of Sec. 29, Twp. 10S, Rge. 2W
(Smallest legal subdivision) (N. or S.) (E. or W.)

or (b) within limits of recorded platted property, town or city.

in Lot _____, Block _____ of _____
(Name of plat or addition)

County of Linn
(If within city or town, give name)

3. Construction Work was begun on August 14, 1952; was completed on August 15, 1952
(Date) (Date)

and the ground water claimed was first used for the purposes set out below on August 12, 1952,
(Date)

since which time the water has been used continuously
(Continuously or intermittently)

from Aug. 13, 1952 to present time
(Date) (Date)

4. Quantity of water claimed and used is 15 gallons per minute; 12.0 acre feet per year.

5. Purpose or Purposes for which water is used Irrigation

(Domestic, irrigation, municipal, manufacturing, industrial, etc.)

6. Description of Well: Depth 36 feet. Type Drilled
(Dug or drilled)

diameter 6 inches. Elevation of ground at well site 245 feet, mean sea level.
(As near as known)

Depth to water table 18 feet.

7. Capacity of Well: _____ g.p.m. with _____ feet drawdown.

_____ g.p.m. with _____ feet drawdown.

Date of test Not tested

If Flowing Well: Measured discharge _____ g.p.m. on _____
(Date)

Shut-in pressure at ground surface _____ lbs. per sq. in. on _____
(Date)

Water is controlled by _____
(Cap, valve, etc.)

8. Casing: (Give diameter, commercial specifications and depth below ground surface of each casing size.)

6 inch diameter Steel casing from 0 to 36 feet
..... inch diameter from to feet
..... inch diameter from to feet
..... inch diameter from to feet

Describe and show depth of shoe, plug, adapter, liner or other details:
.....
.....

9. Perforated Casings or Screens:

Slot perforations from 30 to 36
(Number per foot and size of perforations, or describe screen)
..... from to
..... from to
..... from to

10. Log of Well: (Describe each stratum or formation clearly, indicate if water bearing, and give thickness and depth as indicated.)

MATERIAL	Thickness (Feet)	Depth to Bottom (Feet)
Not available		

If log of well is not available, give name and address of driller. Bill Hamilton Drilling Co.,
838 E. Third Ave., Albany, Oregon

11. Infiltration Trench: Covered or open
 Dimensions: Length ft. Minimum depth ft. Maximum depth ft.
 Bottom width ft. Discharge g.p.m. Date of test

12. Tunnel: Type of lining
 Dimensions:
(Length, course, and cross sectional size)
 Position of water bearing stratum with reference to portal of tunnel

Log of tunnel: (Preceding table for log of well may be used, if desired. Give footage from portal and character of materials, as pertinent.)

13. Pumping Equipment:
 (a) Pump Ward's Stage Centrifugal Capacity 50 g.p.m.
(Make, type and size)
 (b) Motor 1 H. P. electric
(Type and horsepower)

14. Location of area irrigated or to be irrigated, or place of use if for purposes other than irrigation.

Township North or South	Range E. or W. of Willamette Meridian	Section	Forty-acre Tract	Number Acres To Be Irrigated	Date of Reclamation
10S	2W	29	SW $\frac{1}{4}$ of SW $\frac{1}{4}$	5.9	August 18, 1952
10S	2W	32	NW $\frac{1}{4}$ of NW $\frac{1}{4}$	0.1	August 18, 1952
				6.0	

226-814 Kenneth L. and Madeline M. Harman

Tract I: Beginning at a point on the North line of the abandoned SPRR right of way which is South 2.10 chains and 1.42 chains East of the Northwest corner of Section 32, T. 10 S., R. 2 W. of the Will. mer. in Linn County, Oregon; thence N.1°W. 12.59 chains to the South line of the tract of land deeded to Angus Logan by deed recorded November 1, 1890, in Book 38, page 615 of Deed records; thence N.37°30'E. on the South line of said Logan tract 3.25 chains to an interior corner of said Logan tract; thence S.30°E. on the South line of said Logan tract 12.52 chains to the North line of the abandoned Railroad right of way; thence S.62°15'W. on said railroad right of way line, 9.20 chains to the beginning. EXCEPT a right of way 10 feet wide along the North end of said premises and being along the course N.37°30'E. Tract II: Commencing at a point in the North line of the right of way of the abandoned portion of the Spruill Mill City Branch, said point being 138.16 feet South and 93.7 feet East of the Northwest corner of Section 32, T. 10 S., R. 2 W. of the Will. mer. in Linn County, Oregon, and is also 30.0 feet Northerly from and at right angles to the center line of said abandoned branch at Engineer's Station 1001 x 51.93 and is the actual point of beginning of this description; thence N.62°32'E. along the North line of the right of way of said branch, a distance of 607.20 feet to a point 30.0 feet Northerly from and at right angles to the centerline of said abandoned branch at Engineer's Station 1007 x 59.13; thence S.30°0'E. a distance of 80.05 feet to the point of intersection with the southerly line of the right of way of the said abandoned branch said point being 30.0 feet Southerly from and at right angles to the centerline of said abandoned branch at Engineer's Station 1007 x 51.78; thence S.32°32'W. along the South line of the right of way of said branch a distance of 69.72 feet to a point 30.0 feet southerly from and at right angles to the centerline of said abandoned branch at Engineer's Station 1001 x 22.00; thence N.1°W. a distance of 67.02 feet to the point of beginning.

15. If the ground water supply is supplemental to an existing water supply, identification of any application for a permit, permit, certificate or adjudicated right to appropriate water made or held by the registrant.

Township 10S Range 2W, W.M.
North

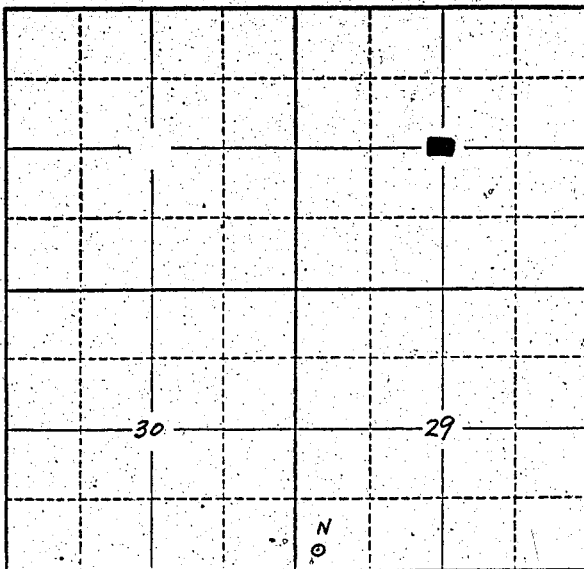

Locate well and acreage of irrigated land on plat.
Scale: 2" = 1 Mile

STATE OF OREGON }
County of Linn } ss.

I, Kenneth L. Harman, being first duly sworn, do hereby certify that I have read the foregoing Registration Statement and that all of the items therein contained are true to the best of my knowledge and belief.

Kenneth L. Harman
(Signature of Registrant)

Subscribed and sworn to before me this 24th day of July, 1958

My commission expires My Commission Expires 2, 1958
NOTARY PUBLIC STATE OF OREGON
Ken L. Harman
(Notary Public)

(SEAL)

CERTIFICATE OF REGISTRATION

STATE OF OREGON }
County of Marion } ss.

This is to certify that the foregoing Registration Statement was received in the office of the State Engineer on the 25th day of July, 1958, at 8:00 o'clock A.M. and has been duly recorded in said office in Book No. // of Registration Statements on page GR 2531

Witness my hand this 6th day of April, 1959

\$15.00

Lewis A. Stanley
(State Engineer)

By _____ (Deputy)